

CROSS KEY CYLINDER WITH SUPPORT



CONSTRUCTIVE FEATURES:

Zinc-plated special alloy support - Brass body, plug and pins - Steel springs - Stainless steel OMEC cam - Nickel-plated steel keys.

WORKING:

Turn the key 360° - The keys are dependent and cannot operate on the cylinder if on the other side the key was inserted and turned.

PROVIDED WITH:

3 keys, 2 roses cod. 0441 N, fixing screws, assembling instructions.

ON REQUEST:

Special keying systems KA.

FOR LOCKS SERIES:

1400 - 1401 - 1405 - 1406 - 1408 - 1408Q - 1409 - 1409Q - 1410
1411 - 1412 - 1415 - 1416 - 1418 - 1418Q - 1490 - 1491 - 1491Q
1492 - 1492Q - 1495 - 1496 - 1496Q
1500 - 1501 - 1505 - 1506 - 1508 - 1508Q - 1531 - 1541
4400 - 4401 - 4405 - 4406 - 4408 - 4408Q - 4409 - 4409Q - 4410
4411 - 4412 - 4415 - 4416 - 4418 - 4118Q - 4490 - 4491 - 4491Q
4492 - 4492Q - 4495 - 4496 - 4496Q

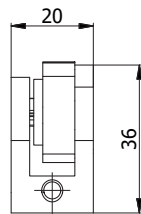
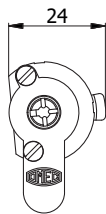

COD.					
4052	6	4100	0,10	10	-
4052/1	6	4101 (long)	0,12	10	-

CROSS KEY CYLINDER WITH SUPPORT



CONSTRUCTIVE FEATURES:

Zinc-plated special alloy support- Brass body, plug and pins - Steel springs
- Stainless steel OMEC cam - Nickel-plated steel keys.

WORKING:

Turn the key 360° - The keys are dependent and cannot operate on the cylinder if on the other side the key was inserted and turned.

PROVIDED WITH:

3 keys, 2 roses cod. 0441 N, forend plug, fixing screws.

ON REQUEST:

Special keying systems KA.

FOR LOCKS SERIES:

4320 - 4328 - 4330 - 4335 - 4338 - 4339 - 4340 - 4350 - 4355 -
4356 - 4530 - 4531 - 4535

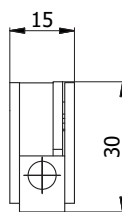

COD.					
4054	6	4100	0,10	10	-
4054/1	6	4101 (long)	0,12	10	-

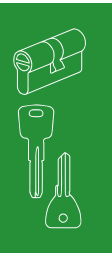

CROSS KEY CYLINDER WITH SUPPORT



CONSTRUCTIVE FEATURES:

Zinc-plated special alloy support - Brass body, plug and pins - Steel springs - Stainless steel OMEC cam - Nickel-plated steel keys.

WORKING:

Turn the key 360° - The keys are dependent and cannot operate on the cylinder if on the other side the key was inserted and turned.

PROVIDED WITH:

3 keys, 2 roses cod. 0441 N, assembling instructions.

ON REQUEST:

Special keying systems KA.

FOR LOCKS SERIES:

11140 - 11141 - 11145 - 11170 - 11171 - 11175 - 1940 - 1941 -
1945 - 1970 - 1971 - 1975
41140 - 41141 - 41145 - 41170 - 41171 - 41175 - 4940 - 4941 -
4945 - 4970 - 4971 - 4975

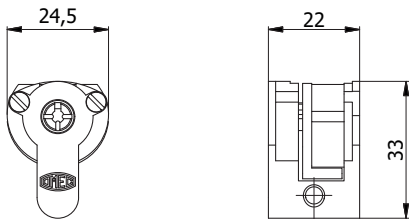

COD.					
4062	6	4100	0,12	10	-
4062/1	6	4101 (long)	0,14	10	-

CROSS KEY CYLINDER WITH SUPPORT



CONSTRUCTIVE FEATURES:

Zinc-plated special alloy support- Brass body, plug and pins - Steel springs
- Stainless steel OMEC cam - Nickel-plated steel keys.

WORKING:

Turn the key 360° - The keys are dependent and cannot operate on the cylinder if on the other side the key was inserted and turned.

PROVIDED WITH:

3 keys, 2 roses cod. 0441 N, forend plug, fixing screws.

ON REQUEST:

Special keying systems KA.

FOR LOCKS SERIES:

1473 - 4473

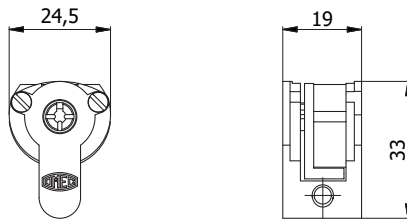

COD.					
4072	6	4100	0,10	10	-
4072/1	6	4101 (long)	0,12	10	-

