



SECURITY

5 pins: over 5.000 combinations
 Picklock resistant
 Push resistant 30° DIN cam



KEY

Nickel-plated brass key



MATERIALS

High resistance aluminium alloy body with patented ceramic threatment
 Easy entrance key nickel-plated brass plugs
 Stainless steel pins and springs
 Self-lubricating steel cam

Salt spray tested for 96 h
 Durability over 100.000 cycles



MASTER KEY POTENTIAL

Special keying system KA-MK-GMK-CL
 For a high security level MK system:
 500 possible combinations
 (except cod. 120/01 L - 120/02 L -
 121/01 L - 121/02 L - 123/02 L)

DESIGNED AND CERTIFIED ACCORDING TO EUROPEAN STANDARD

UNI EN 1303:15 - BS EN 1303:15 - ICIM 0039CS							
1	6	0	A	0	C	2	0

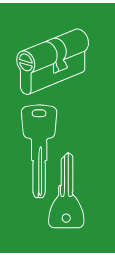

CATEGORY OF USE
1= for use by people with a high incentive to exercise care and with a small chance of misuse



DURABILITY
6 = 100.000 test cycles



DOOR MASS
0 = no door mass requirement



SUITABLE FOR USE ON FIRE RESISTANT/SMOKE CONTROL DOORS
A = suitable for use on smoke control doors



SAFETY
0 = no safety requirement



CORROSION RESISTANCE AND TEMPERATURE
C = high corrosion resistance; temperature requirement: from -25°C to +65°C



KEY RELATED SECURITY
2 = over 5.000 combinations



ATTACK RESISTANCE
0 = no requirements of resistance against drilling and mechanical attack

DOUBLE CYLINDER

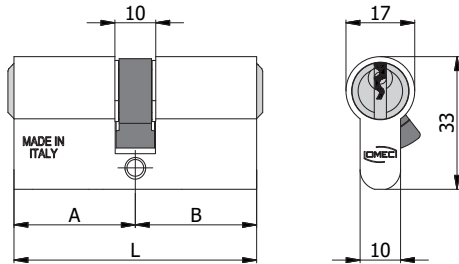

CONSTRUCTIVE FEATURES:

High resistance aluminium body - Easy entrance key nickel-plated brass plugs - Stainless steel pins and drivers - Stainless steel springs - Steel off center 30° DIN cam - Nickel-plated brass keys.

WORKING:

Turn the key 360° - The keys are dependent and cannot operate on the cylinder if on the other side the key was inserted and turned.

PROVIDED WITH:

3 keys.

ON REQUEST:

Special keying systems KA-MK-GMK-CL.

COD.	L	A	B					
120/01 L	40	20	20	3	105/03	0,11	1	10
120/02 L	47	23,5	23,5	4	105/04	0,12	1	10
120/03 L	54	27	27	5	105/05	0,13	1	10
120/04 L	60	30	30	5	105/05	0,14	1	10
120/05 L	60	27	33	5	105/05	0,14	1	10
120/06 L	70	35	35	5	105/05	0,15	1	10
120/07 L	70	27	43	5	105/05	0,15	1	10
120/08 L	80	40	40	5	105/05	0,17	1	10
120/09 L	80	27	53	5	105/05	0,17	1	10
120/10 L	64	27	37	5	105/05	0,14	1	10
120/11 L	65	30	35	5	105/05	0,14	1	10
120/12 L	96	43	53	5	105/05	0,20	1	5
120/13 L	106	53	53	5	105/05	0,21	1	5
120/14 L	70	30	40	5	105/05	0,15	1	10
120/15 L	75	30	45	5	105/05	0,16	1	10
120/16 L	75	35	40	5	105/05	0,16	1	10
120/17 L	80	35	45	5	105/05	0,17	1	10
120/18 L	80	30	50	5	105/05	0,17	1	10
120/19 L	85	40	45	5	105/05	0,17	1	10
120/20 L	90	40	50	5	105/05	0,18	1	5
120/21 L	90	45	45	5	105/05	0,18	1	5
120/22 L	100	50	50	5	105/05	0,20	1	5
120/23 L	85	30	55	5	105/05	0,17	1	10
120/24 L	90	30	60	5	105/05	0,18	1	5
120/25 L	95	30	65	5	105/05	0,19	1	5
120/26 L	100	30	70	5	105/05	0,20	1	5
120/27 L	110	30	80	5	105/05	0,21	1	5
120/28 L	85	35	50	5	105/05	0,17	1	10
120/29 L	90	35	55	5	105/05	0,18	1	5
120/30 L	95	35	60	5	105/05	0,19	1	5
120/31 L	100	35	65	5	105/05	0,20	1	5
120/32 L	95	40	55	5	105/05	0,19	1	5
120/33 L	100	40	60	5	105/05	0,20	1	5
120/34 L	110	40	70	5	105/05	0,21	1	5
120/35 L	120	40	80	5	105/05	0,23	1	5
120/36 L	95	45	50	5	105/05	0,19	1	5
120/37 L	100	45	55	5	105/05	0,20	1	5
120/38 L	110	50	60	5	105/05	0,21	1	5
120/39 L	120	60	60	5	105/05	0,23	1	5
120/40 L	120	50	70	5	105/05	0,23	1	5
120/41 L	120	30	90	5	105/05	0,23	1	5
120/42 L	105	30	75	5	105/05	0,21	1	5
120/43 L	105	45	60	5	105/05	0,21	1	5
120/44 L	115	50	65	5	105/05	0,22	1	5
120/45 L	110	55	55	5	105/05	0,21	1	5
120/46 L	110	45	65	5	105/05	0,21	1	5

HALF CYLINDER



CONSTRUCTIVE FEATURES:

High resistance aluminium body - Easy entrance key nickel-plated brass plug - Stainless steel pins and drivers - Stainless steel springs - Steel off center 30° DIN cam - Nickel-plated brass keys.

WORKING:

Turn the key 360°.

PROVIDED WITH:

3 keys.

ON REQUEST:

Special keying systems KA-MK-GMK-CL.

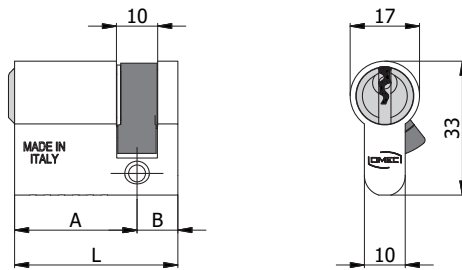
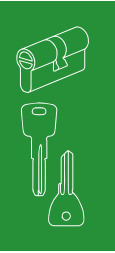

COD.	L	A	B					
121/01 L	30	20	10	3	105/03	0,08	1	10
121/02 L	33,5	23,5	10	4	105/04	0,09	1	10
121/03 L	37	27	10	5	105/05	0,09	1	10
121/04 L	40	30	10	5	105/05	0,10	1	10
121/05 L	43	33	10	5	105/05	0,10	1	10
121/07 L	53	43	10	5	105/05	0,11	1	10
121/12 L	97	87	10	5	105/05	0,17	1	5
121/13 L	107	97	10	5	105/05	0,18	1	5
121/24 L	70	60	10	5	105/05	0,14	1	10
121/26 L	80	70	10	5	105/05	0,14	1	10

DOUBLE CYLINDER WITH KNOB



CONSTRUCTIVE FEATURES:

High resistance aluminium body - Easy entrance key nickel-plated brass plug - Stainless steel pins and drivers - Stainless steel springs - Steel off center 30° DIN cam - Black nylon knob - Nickel-plated brass keys.

WORKING:

Turn the key or knob 360°.

PROVIDED WITH:

3 keys.

ON REQUEST:

Special keying systems KA-MK-GMK-CL.

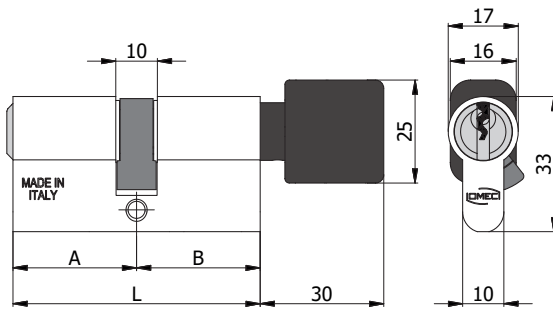

COD.	L	A	B					
123/02 L	47	23,5	23,5	4	105/04	0,13	1	10
123/03 L	54	27	27	5	105/05	0,15	1	10
123/04 L	60	30	30	5	105/05	0,16	1	5
123/05 L	60	27	33	5	105/05	0,16	1	5
123/06 L	60	33	27	5	105/05	0,16	1	5
123/07 L	70	35	35	5	105/05	0,17	1	5
123/08 L	70	27	43	5	105/05	0,17	1	5
123/09 L	70	43	27	5	105/05	0,17	1	5
123/10 L	80	40	40	5	105/05	0,19	1	5
123/11 L	80	27	53	5	105/05	0,19	1	5
123/12 L	80	53	27	5	105/05	0,19	1	5

DOUBLE CYLINDER WITH KNOB



CONSTRUCTIVE FEATURES:

High resistance aluminium body - Easy entrance key nickel-plated brass plug - Stainless steel pins and drivers - Stainless steel springs - Steel off center 30° DIN cam - Satin nickel-plated special alloy knob.- Nickel-plated brass keys.

WORKING:

Turn the key or knob 360°.

PROVIDED WITH:

3 keys.

ON REQUEST:

Special keying systems KA-MK-GMK-CL.

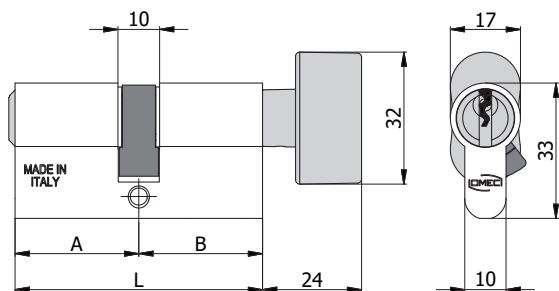
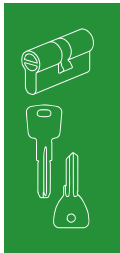

COD.	L	A	B					
123/02B L	47	23,5	23,5	4	105/04	0,17	1	10
123/03B L	54	27	27	5	105/05	0,19	1	10
123/04B L	60	30	30	5	105/05	0,20	1	5
123/05B L	60	27	33	5	105/05	0,20	1	5
123/06B L	60	33	27	5	105/05	0,20	1	5
123/07B L	70	35	35	5	105/05	0,21	1	5
123/08B L	70	27	43	5	105/05	0,21	1	5
123/09B L	70	43	27	5	105/05	0,21	1	5
123/10B L	80	40	40	5	105/05	0,23	1	5
123/11B L	80	27	53	5	105/05	0,23	1	5
123/12B L	80	53	27	5	105/05	0,23	1	5

HALF CYLINDER WITH KNOB



CONSTRUCTIVE FEATURES:

High resistance aluminium body - Steel off center 30° DIN cam - Black nylon knob.

WORKING:

Turn the knob 360°.

PROVIDED WITH:

/

ON REQUEST:

/

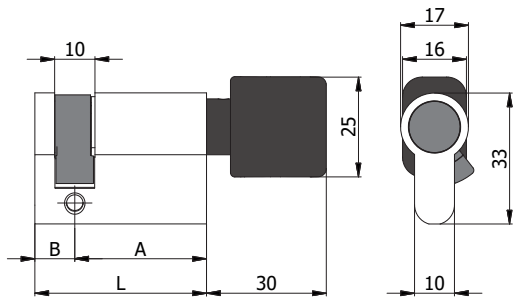

COD.	L	A	B	kg		
124/02 L	33,5	23,5	10	0,06	1	10
124/03 L	37	27	10	0,08	1	10
124/04 L	40	30	10	0,09	1	10
124/05 L	43	33	10	0,09	1	10
124/07 L	53	43	10	0,10	1	10

HALF CYLINDER WITH KNOB



CONSTRUCTIVE FEATURES:

High resistance aluminium body - Steel off center 30° DIN cam - Satin nickel-plated special alloy knob.

WORKING:

Turn the knob 360°.

PROVIDED WITH:

/

ON REQUEST:

/

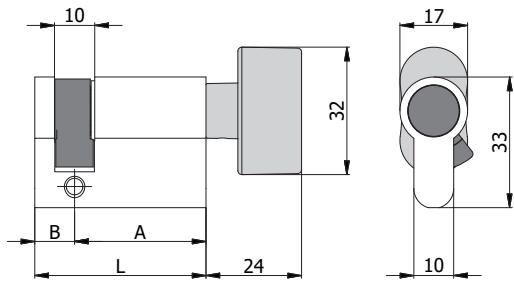
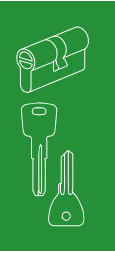

COD.	L	A	B	kg		
124/02B L	33,5	23,5	10	0,06	1	10
124/03B L	37	27	10	0,12	1	10
124/04B L	40	30	10	0,13	1	10
124/05B L	43	33	10	0,13	1	10
124/07B L	53	43	10	0,14	1	10
124/25B L	75	65	10	0,17	1	5
124/26B L	80	70	10	0,17	1	5

DOUBLE CYLINDER FOR TOILET DOORS



CONSTRUCTIVE FEATURES:

High resistance aluminium body - Nickel-plated brass plug - Steel off center 30° DIN cam - Black nylon knob.

WORKING:

Turn the plug or knob 360°.

PROVIDED WITH:

/

ON REQUEST:

/

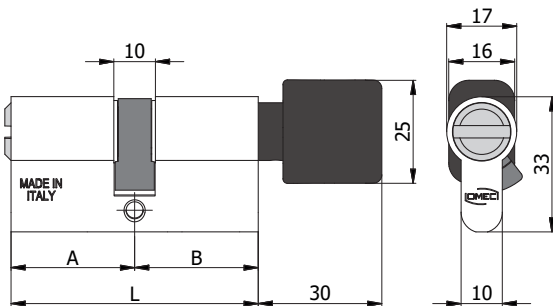

COD.	L	A	B	kg		
125/03 L	54	27	27	0,15	1	10
125/04 L	60	30	30	0,16	1	5
125/05 L	60	27	33	0,16	1	5
125/07 L	70	35	35	0,17	1	5

DOUBLE CYLINDER FOR TOILET DOORS



CONSTRUCTIVE FEATURES:

High resistance aluminium body - Nickel-plated brass plug - Steel off center 30° DIN cam - Satin nickel-plated special alloy knob.

WORKING:

Turn the plug or knob 360°.

PROVIDED WITH:

/

ON REQUEST:

/

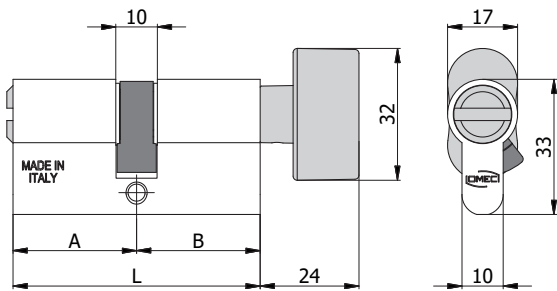
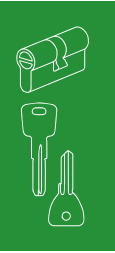

COD.	L	A	B	kg		
125/03B L	54	27	27	0,19	1	10
125/04B L	60	30	30	0,20	1	5
125/05B L	60	27	33	0,20	1	5
125/07B L	70	35	35	0,21	1	5



SECURITY

6 pins: over 30.000 combinations
 Picklock resistant
 Push resistant 30° DIN cam
 Clutching version for emergency function



MATERIALS

High resistance aluminium alloy body with patented ceramic threatment
 Easy entrance key nickel-plated brass plugs
 Stainless steel pins and springs
 Self-lubricating steel cam

Salt spray tested for 96 h
 Durability over 100.000 cycles



REVERSIBLE KEY

Flat silver-nickel reversible key with long neck compatible with security escutcheon



PROPERTY CARD

Security card with code number



TEMPORARY KEY

Brass temporary key that gets disarmed after the owner key is insterted and turned.



ERGONOMICS

Ergonomic and removeable key cover interchangelable and available in many different colours



MASTER KEY POTENTIAL

Special keying system KA-MK-GMK-CL
 For a high security level MK system:
 2.000 possible combinations

DESIGNED AND CERTIFIED ACCORDING TO EUROPEAN STANDARD

UNI EN 1303:15 - BS EN 1303:15 - ICIM 0039CS							
1	6	0	A	0	C	5	0

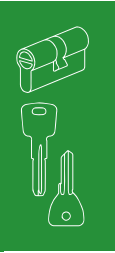

CATEGORY OF USE
1= for use by people with a high incentive to exercise care and with a small chance of misuse



DURABILITY
6 = 100.000 test cycles



DOOR MASS
0 = no door mass requirement



SUITABLE FOR USE ON FIRE RESISTANT/SMOKE CONTROL DOORS
A = suitable for use on smoke control doors



SAFETY
0 = no safety requirement



CORROSION RESISTANCE AND TEMPERATURE
C = high corrosion resistance; temperature requirement: from -25°C to +65°C



KEY RELATED SECURITY
5 = over 30.000 combinations



ATTACK RESISTANCE
0 = no requirements of resistance against drilling and mechanical attack

DOUBLE CYLINDER

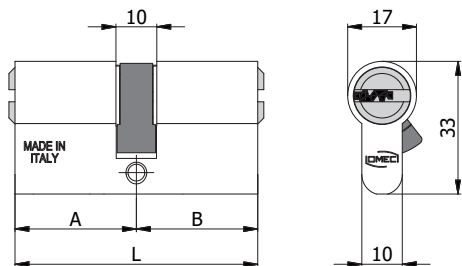

CONSTRUCTIVE FEATURES:

High resistance aluminium body - Easy entrance key nickel-plated brass plugs - Stainless steel pins and drivers - Stainless steel springs - Steel off center 30° DIN cam - Silver nickel reversible flat keys with code number.

WORKING:

Turn the key 360° - The keys are dependent and cannot operate on the cylinder if on the other side the key was inserted and turned.

PROVIDED WITH:

3 keys.

ON REQUEST:

Special keying systems KA-MK-GMK-CL.

COD.	L	A	B					
2120/04 L	60	30	30	6	2020/06	0,16	1	10
2120/06 L	70	35	35	6	2020/06	0,17	1	10
2120/08 L	80	40	40	6	2020/06	0,19	1	10
2120/11 L	65	30	35	6	2020/06	0,16	1	10
2120/14 L	70	30	40	6	2020/06	0,17	1	10
2120/15 L	75	30	45	6	2020/06	0,18	1	10
2120/16 L	75	35	40	6	2020/06	0,18	1	10
2120/17 L	80	35	45	6	2020/06	0,19	1	10
2120/18 L	80	30	50	6	2020/06	0,19	1	10
2120/19 L	85	40	45	6	2020/06	0,20	1	10
2120/20 L	90	40	50	6	2020/06	0,21	1	5
2120/21 L	90	45	45	6	2020/06	0,21	1	5
2120/22 L	100	50	50	6	2020/06	0,23	1	5
2120/23 L	85	30	55	6	2020/06	0,20	1	10
2120/24 L	90	30	60	6	2020/06	0,21	1	5
2120/25 L	95	30	65	6	2020/06	0,22	1	5
2120/26 L	100	30	70	6	2020/06	0,23	1	5
2120/27 L	110	30	80	6	2020/06	0,25	1	5
2120/28 L	85	35	50	6	2020/06	0,20	1	10
2120/29 L	90	35	55	6	2020/06	0,21	1	5
2120/30 L	95	35	60	6	2020/06	0,22	1	5
2120/31 L	100	35	65	6	2020/06	0,23	1	5
2120/32 L	95	40	55	6	2020/06	0,22	1	5
2120/33 L	100	40	60	6	2020/06	0,23	1	5
2120/34 L	110	40	70	6	2020/06	0,25	1	5
2120/35 L	120	40	80	6	2020/06	0,27	1	5
2120/36 L	95	45	50	6	2020/06	0,22	1	5
2120/37 L	100	45	55	6	2020/06	0,23	1	5
2120/38 L	110	50	60	6	2020/06	0,25	1	5
2120/39 L	120	60	60	6	2020/06	0,27	1	5
2120/40 L	120	50	70	6	2020/06	0,27	1	5
2120/41 L	120	30	90	6	2020/06	0,27	1	5
2120/42 L	105	30	75	6	2020/06	0,24	1	5
2120/43 L	105	45	60	6	2020/06	0,24	1	5
2120/44 L	115	50	65	6	2020/06	0,26	1	5
2120/45 L	110	55	55	6	2020/06	0,25	1	5
2120/46 L	110	45	65	6	2020/06	0,25	1	5

DOUBLE CYLINDER WITH TEMPORARY KEY

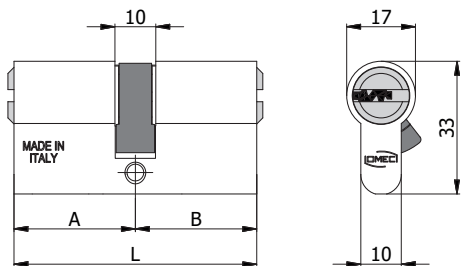

CONSTRUCTIVE FEATURES:

High resistance aluminium body- Easy entrance key nickel-plated brass plugs - Stainless steel pins and drivers - Stainless steel springs - Steel off center 30° DIN cam - Silver nickel reversible flat keys with code number - Brass temporary key with code number.

WORKING:

Turn the key 360° - The keys are dependent and cannot operate on the cylinder if on the other side the key was inserted and turned.

PROVIDED WITH:

3 keys, 1 temporary key, registration card.

ON REQUEST:

Special keying systems KA-MK-GMK-CL.

COD.	L	A	B	Pin	Key	kg	Box	Box
2120/04 LTK	60	30	30	6	2020/06	0,16	1	10
2120/06 LTK	70	35	35	6	2020/06	0,17	1	10
2120/08 LTK	80	40	40	6	2020/06	0,19	1	10
2120/11 LTK	65	30	35	6	2020/06	0,16	1	10
2120/14 LTK	70	30	40	6	2020/06	0,17	1	10
2120/15 LTK	75	30	45	6	2020/06	0,18	1	10
2120/16 LTK	75	35	40	6	2020/06	0,18	1	10
2120/17 LTK	80	35	45	6	2020/06	0,19	1	10
2120/18 LTK	80	30	50	6	2020/06	0,19	1	10
2120/19 LTK	85	40	45	6	2020/06	0,20	1	10
2120/20 LTK	90	40	50	6	2020/06	0,21	1	5
2120/21 LTK	90	45	45	6	2020/06	0,21	1	5
2120/22 LTK	100	50	50	6	2020/06	0,23	1	5
2120/23 LTK	85	30	55	6	2020/06	0,20	1	10
2120/24 LTK	90	30	60	6	2020/06	0,21	1	5
2120/25 LTK	95	30	65	6	2020/06	0,22	1	5
2120/26 LTK	100	30	70	6	2020/06	0,23	1	5
2120/27 LTK	110	30	80	6	2020/06	0,25	1	5
2120/28 LTK	85	35	50	6	2020/06	0,20	1	10
2120/29 LTK	90	35	55	6	2020/06	0,21	1	5
2120/30 LTK	95	35	60	6	2020/06	0,22	1	5
2120/31 LTK	100	35	65	6	2020/06	0,23	1	5
2120/32 LTK	95	40	55	6	2020/06	0,22	1	5
2120/33 LTK	100	40	60	6	2020/06	0,23	1	5
2120/34 LTK	110	40	70	6	2020/06	0,25	1	5
2120/35 LTK	120	40	80	6	2020/06	0,27	1	5
2120/36 LTK	95	45	50	6	2020/06	0,22	1	5
2120/37 LTK	100	45	55	6	2020/06	0,23	1	5
2120/38 LTK	110	50	60	6	2020/06	0,25	1	5
2120/39 LTK	120	60	60	6	2020/06	0,27	1	5
2120/40 LTK	120	50	70	6	2020/06	0,27	1	5
2120/41 LTK	120	30	90	6	2020/06	0,27	1	5
2120/42 LTK	105	30	75	6	2020/06	0,24	1	5
2120/43 LTK	105	45	60	6	2020/06	0,24	1	5
2120/44 LTK	115	50	65	6	2020/06	0,26	1	5
2120/45 LTK	110	55	55	6	2020/06	0,25	1	5
2120/46 LTK	110	45	65	6	2020/06	0,25	1	5

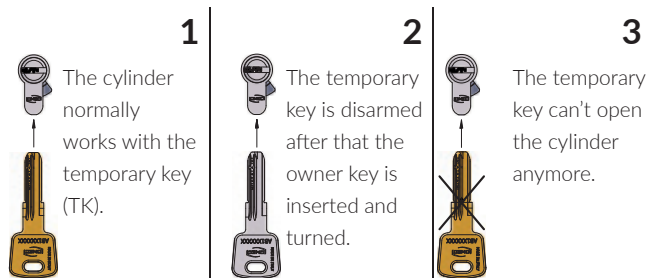
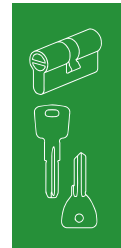

DOUBLE CYLINDER

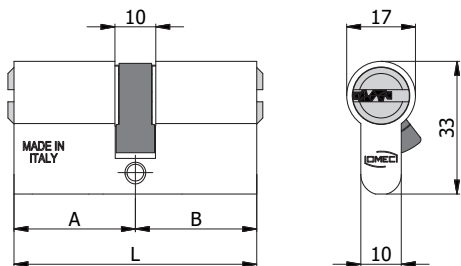

CONSTRUCTIVE FEATURES:

High resistance aluminium body - Easy entrance key nickel-plated brass plugs - Stainless steel pins and drivers - Stainless steel springs - Steel off center 30° DIN cam - Silver nickel reversible flat keys with code number.

WORKING:

Turn the key 360° - The keys are dependent and cannot operate on the cylinder if on the other side the key was inserted and turned.

PROVIDED WITH:

5 keys, registration card.

ON REQUEST:

Special keying systems KA-MK-GMK-CL.

COD.	L	A	B					
2120/504 L	60	30	30	6	2020/06	0,21	1	10
2120/506 L	70	35	35	6	2020/06	0,22	1	10
2120/508 L	80	40	40	6	2020/06	0,24	1	10
2120/511 L	65	30	35	6	2020/06	0,21	1	10
2120/514 L	70	30	40	6	2020/06	0,22	1	10
2120/515 L	75	30	45	6	2020/06	0,23	1	10
2120/516 L	75	35	40	6	2020/06	0,23	1	10
2120/517 L	80	35	45	6	2020/06	0,24	1	10
2120/518 L	80	30	50	6	2020/06	0,24	1	10
2120/519 L	85	40	45	6	2020/06	0,25	1	10
2120/520 L	90	40	50	6	2020/06	0,26	1	5
2120/521 L	90	45	45	6	2020/06	0,26	1	5
2120/522 L	100	50	50	6	2020/06	0,28	1	5
2120/523 L	85	30	55	6	2020/06	0,25	1	10
2120/524 L	90	30	60	6	2020/06	0,26	1	5
2120/525 L	95	30	65	6	2020/06	0,27	1	5
2120/526 L	100	30	70	6	2020/06	0,28	1	5
2120/527 L	110	30	80	6	2020/06	0,30	1	5
2120/528 L	85	35	50	6	2020/06	0,25	1	10
2120/529 L	90	35	55	6	2020/06	0,26	1	5
2120/530 L	95	35	60	6	2020/06	0,27	1	5
2120/531 L	100	35	65	6	2020/06	0,28	1	5
2120/532 L	95	40	55	6	2020/06	0,27	1	5
2120/533 L	100	40	60	6	2020/06	0,28	1	5
2120/534 L	110	40	70	6	2020/06	0,30	1	5
2120/535 L	120	40	80	6	2020/06	0,32	1	5
2120/536 L	95	45	50	6	2020/06	0,27	1	5
2120/537 L	100	45	55	6	2020/06	0,28	1	5
2120/538 L	110	50	60	6	2020/06	0,30	1	5
2120/539 L	120	60	60	6	2020/06	0,32	1	5
2120/540 L	120	50	70	6	2020/06	0,32	1	5
2120/541 L	120	30	90	6	2020/06	0,32	1	5
2120/542 L	105	30	75	6	2020/06	0,29	1	5
2120/543 L	105	45	60	6	2020/06	0,29	1	5
2120/544 L	115	50	65	6	2020/06	0,31	1	5
2120/545 L	110	55	55	6	2020/06	0,30	1	5
2120/546 L	110	45	65	6	2020/06	0,30	1	5

DOUBLE CYLINDER WITH TEMPORARY KEY

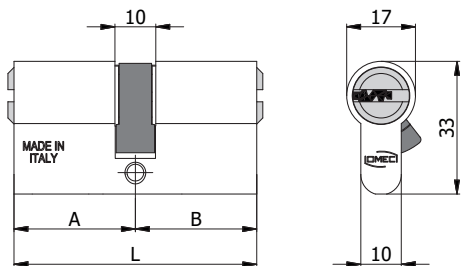

CONSTRUCTIVE FEATURES:

High resistance aluminium body- Easy entrance key nickel-plated brass plugs - Stainless steel pins and drivers - Stainless steel springs - Steel off center 30° DIN cam - Silver nickel reversible flat keys with code number - Brass temporary key with code number.

WORKING:

Turn the key 360° - The keys are dependent and cannot operate on the cylinder if on the other side the key was inserted and turned.

PROVIDED WITH:

5 keys, 1 temporary key, registration card.

ON REQUEST:

Special keying systems KA-MK-GMK-CL.

COD.	L	A	B	Pin	Key	kg	Box	Box
2120/504 L TK	60	30	30	6	2020/06	0,23	1	5
2120/506 L TK	70	35	35	6	2020/06	0,24	1	5
2120/508 L TK	80	40	40	6	2020/06	0,26	1	5
2120/511 L TK	65	30	35	6	2020/06	0,23	1	5
2120/514 L TK	70	30	40	6	2020/06	0,24	1	5
2120/515 L TK	75	30	45	6	2020/06	0,25	1	5
2120/516 L TK	75	35	40	6	2020/06	0,25	1	5
2120/517 L TK	80	35	45	6	2020/06	0,26	1	5
2120/518 L TK	80	30	50	6	2020/06	0,26	1	5
2120/519 L TK	85	40	45	6	2020/06	0,27	1	5
2120/520 L TK	90	40	50	6	2020/06	0,28	1	5
2120/521 L TK	90	45	45	6	2020/06	0,28	1	5
2120/522 L TK	100	50	50	6	2020/06	0,30	1	5
2120/523 L TK	85	30	55	6	2020/06	0,27	1	5
2120/524 L TK	90	30	60	6	2020/06	0,28	1	5
2120/525 L TK	95	30	65	6	2020/06	0,29	1	5
2120/526 L TK	100	30	70	6	2020/06	0,30	1	5
2120/527 L TK	110	30	80	6	2020/06	0,32	1	5
2120/528 L TK	85	35	50	6	2020/06	0,27	1	5
2120/529 L TK	90	35	55	6	2020/06	0,28	1	5
2120/530 L TK	95	35	60	6	2020/06	0,29	1	5
2120/531 L TK	100	35	65	6	2020/06	0,30	1	5
2120/532 L TK	95	40	55	6	2020/06	0,29	1	5
2120/533 L TK	100	40	60	6	2020/06	0,30	1	5
2120/534 L TK	110	40	70	6	2020/06	0,32	1	5
2120/535 L TK	120	40	80	6	2020/06	0,34	1	5
2120/536 L TK	95	45	50	6	2020/06	0,29	1	5
2120/537 L TK	100	45	55	6	2020/06	0,30	1	5
2120/538 L TK	110	50	60	6	2020/06	0,32	1	5
2120/539 L TK	120	60	60	6	2020/06	0,34	1	5
2120/540 L TK	120	50	70	6	2020/06	0,34	1	5
2120/541 L TK	120	30	90	6	2020/06	0,34	1	5
2120/542 L TK	105	30	75	6	2020/06	0,31	1	5
2120/543 L TK	105	45	60	6	2020/06	0,31	1	5
2120/544 L TK	115	50	65	6	2020/06	0,33	1	5
2120/545 L TK	110	55	55	6	2020/06	0,30	1	5
2120/546 L TK	110	45	65	6	2020/06	0,30	1	5

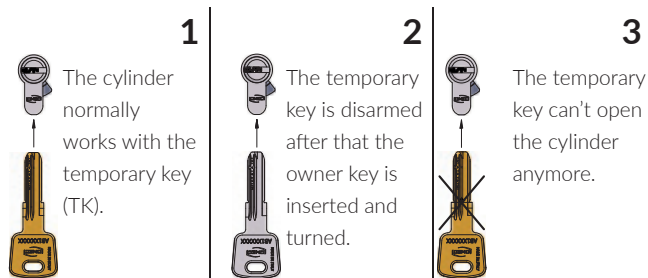
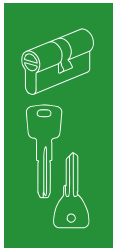

HALF CYLINDER



CONSTRUCTIVE FEATURES:

High resistance aluminium body - Easy entrance key nickel-plated brass plug - Stainless steel pins and drivers - Stainless steel springs - Steel off center 30° DIN cam - Silver nickel reversible flat keys with code number.

WORKING:

Turn the key 360°.

PROVIDED WITH:

3 keys.

ON REQUEST:

Special keying systems KA-MK-GMK-CL.

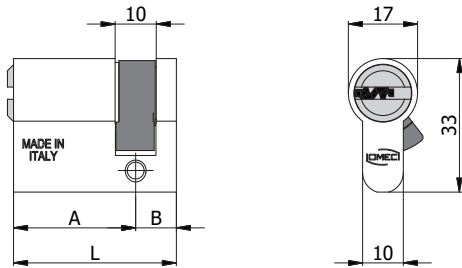

COD.	L	A	B					
2121/03 L	37	27	10	5	2020/06	0,10	1	10
2121/04 L	40	30	10	6	2020/06	0,11	1	10
2121/06 L	45	35	10	6	2020/06	0,12	1	10
2121/08 L	50	40	10	6	2020/06	0,13	1	10
2121/15 L	55	45	10	6	2020/06	0,15	1	10
2121/18 L	60	50	10	6	2020/06	0,16	1	10
2121/23 L	65	55	10	6	2020/06	0,17	1	10
2121/24 L	70	60	10	6	2020/06	0,18	1	10
2121/25 L	75	65	10	6	2020/06	0,19	1	10
2121/26 L	80	70	10	6	2020/06	0,20	1	10
2121/27 L	90	80	10	6	2020/06	0,22	1	5

HALF CYLINDER WITH TEMPORARY KEY



CONSTRUCTIVE FEATURES:

High resistance aluminium body - Easy entrance key nickel-plated brass plug - Stainless steel pins and drivers - Stainless steel springs - Steel off center 30° DIN cam - Silver nickel reversible flat keys with code number - Brass temporary key with code number.

WORKING:

Turn the key 360°.

PROVIDED WITH:

3 keys, 1 temporary key, registration card.

ON REQUEST:

Special keying systems KA-MK-GMK-CL.

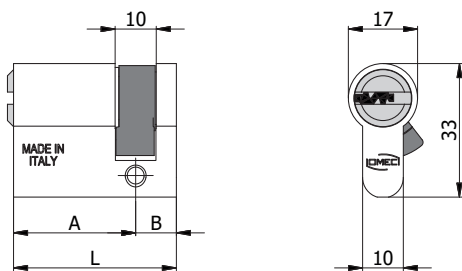
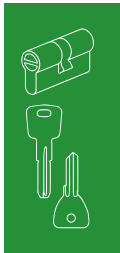

COD.	L	A	B					
2121/03 LTK	37	27	10	5	2020/06	0,13	1	10
2121/04 LTK	40	30	10	6	2020/06	0,14	1	10
2121/06 LTK	45	35	10	6	2020/06	0,15	1	10
2121/08 LTK	50	40	10	6	2020/06	0,16	1	10
2121/15 LTK	55	45	10	6	2020/06	0,18	1	10
2121/18 LTK	60	50	10	6	2020/06	0,19	1	10
2121/23 LTK	65	55	10	6	2020/06	0,20	1	10
2121/24 LTK	70	60	10	6	2020/06	0,21	1	10
2121/25 LTK	75	65	10	6	2020/06	0,22	1	10
2121/26 LTK	80	70	10	6	2020/06	0,23	1	10
2121/27 LTK	90	80	10	6	2020/06	0,25	1	5

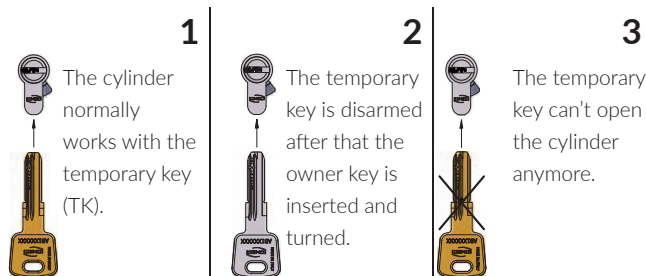

HALF CYLINDER



CONSTRUCTIVE FEATURES:

High resistance aluminium body - Easy entrance key nickel-plated brass plug - Stainless steel pins and drivers - Stainless steel springs - Steel off center 30° DIN cam - Silver nickel reversible flat keys with code number.

WORKING:

Turn the key 360°.

PROVIDED WITH:

5 keys, registration card.

ON REQUEST:

Special keying systems KA-MK-GMK-CL.

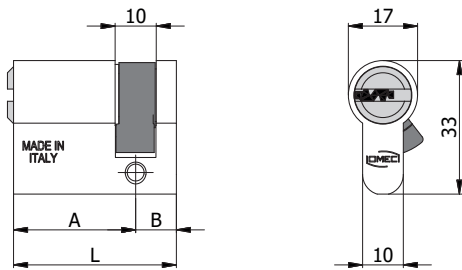

COD.	L	A	B					
2121/503 L	37	27	10	5	2020/06	0,15	1	10
2121/504 L	40	30	10	6	2020/06	0,16	1	10
2121/506 L	45	35	10	6	2020/06	0,17	1	10
2121/508 L	50	40	10	6	2020/06	0,18	1	10
2121/515 L	55	45	10	6	2020/06	0,20	1	10
2121/518 L	60	50	10	6	2020/06	0,21	1	10
2121/523 L	65	55	10	6	2020/06	0,22	1	10
2121/524 L	70	60	10	6	2020/06	0,23	1	10
2121/525 L	75	65	10	6	2020/06	0,24	1	10
2121/526 L	80	70	10	6	2020/06	0,25	1	10
2121/527 L	90	80	10	6	2020/06	0,27	1	5

HALF CYLINDER WITH TEMPORARY KEY



CONSTRUCTIVE FEATURES:

High resistance aluminium body - Easy entrance key nickel-plated brass plug - Stainless steel pins and drivers - Stainless steel springs - Steel off center 30° DIN cam - Silver nickel reversible flat keys with code number - Brass temporary key with code number.

WORKING:

Turn the key 360°.

PROVIDED WITH:

5 keys, 1 temporary key, registration card.

ON REQUEST:

Special keying systems KA-MK-GMK-CL.

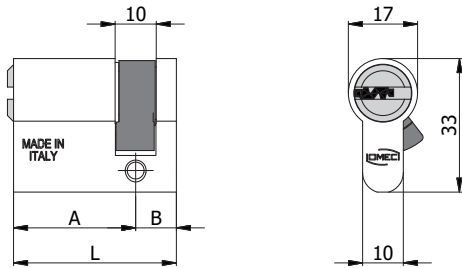
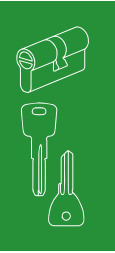

COD.	L	A	B					
2121/503 L TK	37	27	10	5	2020/06	0,17	1	10
2121/504 L TK	40	30	10	6	2020/06	0,18	1	10
2121/506 L TK	45	35	10	6	2020/06	0,19	1	10
2121/508 L TK	50	40	10	6	2020/06	0,20	1	10
2121/515 L TK	55	45	10	6	2020/06	0,22	1	10
2121/518 L TK	60	50	10	6	2020/06	0,23	1	10
2121/523 L TK	65	55	10	6	2020/06	0,24	1	10
2121/524 L TK	70	60	10	6	2020/06	0,25	1	10
2121/525 L TK	75	65	10	6	2020/06	0,26	1	10
2121/526 L TK	80	70	10	6	2020/06	0,27	1	10
2121/527 L TK	90	80	10	6	2020/06	0,29	1	5

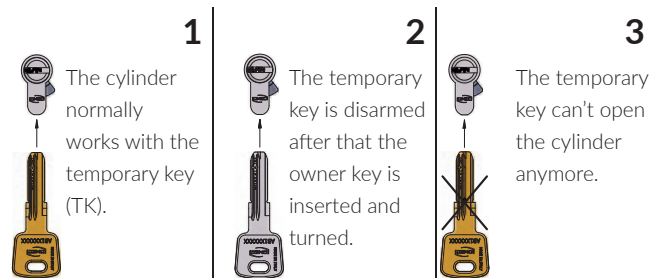

CLUTCHING DOUBLE CYLINDER

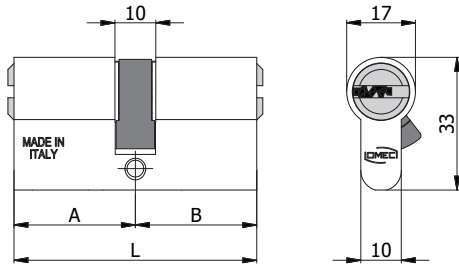
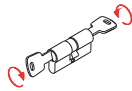

COD.	L	A	B					
2122/04 L	60	30	30	6	2020/06	0,16	1	10
2122/06 L	70	35	35	6	2020/06	0,17	1	10
2122/08 L	80	40	40	6	2020/06	0,19	1	10
2122/11 L	65	30	35	6	2020/06	0,16	1	10
2122/14 L	70	30	40	6	2020/06	0,17	1	10
2122/15 L	75	30	45	6	2020/06	0,18	1	10
2122/16 L	75	35	40	6	2020/06	0,18	1	10
2122/17 L	80	35	45	6	2020/06	0,19	1	10
2122/18 L	80	30	50	6	2020/06	0,19	1	10
2122/19 L	85	40	45	6	2020/06	0,20	1	10
2122/20 L	90	40	50	6	2020/06	0,21	1	5
2122/21 L	90	45	45	6	2020/06	0,21	1	5
2122/22 L	100	50	50	6	2020/06	0,23	1	5
2122/23 L	85	30	55	6	2020/06	0,20	1	10
2122/24 L	90	30	60	6	2020/06	0,21	1	5
2122/25 L	95	30	65	6	2020/06	0,22	1	5
2122/26 L	100	30	70	6	2020/06	0,23	1	5
2122/27 L	110	30	80	6	2020/06	0,25	1	5
2122/28 L	85	35	50	6	2020/06	0,20	1	10
2122/29 L	90	35	55	6	2020/06	0,21	1	5
2122/30 L	95	35	60	6	2020/06	0,22	1	5
2122/31 L	100	35	65	6	2020/06	0,23	1	5
2122/32 L	95	40	55	6	2020/06	0,22	1	5
2122/33 L	100	40	60	6	2020/06	0,23	1	5
2122/34 L	110	40	70	6	2020/06	0,25	1	5
2122/35 L	120	40	80	6	2020/06	0,27	1	5
2122/36 L	95	45	50	6	2020/06	0,22	1	5
2122/37 L	100	45	55	6	2020/06	0,23	1	5
2122/38 L	110	50	60	6	2020/06	0,25	1	5
2122/39 L	120	60	60	6	2020/06	0,27	1	5
2122/40 L	120	50	70	6	2020/06	0,27	1	5
2122/41 L	120	30	90	6	2020/06	0,27	1	5
2122/42 L	105	30	75	6	2020/06	0,24	1	5
2122/43 L	105	45	60	6	2020/06	0,24	1	5
2122/44 L	115	50	65	6	2020/06	0,26	1	5
2122/45 L	110	55	55	6	2020/06	0,25	1	5
2122/46 L	110	45	65	6	2020/06	0,25	1	5

CONSTRUCTIVE FEATURES:

High resistance aluminium body - Easy entrance key nickel-plated brass plugs - Stainless steel pins and drivers - Stainless steel springs - Steel off center 30° DIN cam - Silver nickel reversible flat keys with code number.

WORKING:

Turn the key 360° - The keys are independent and can operate on the cylinder even if on the other side the key was inserted and turned.

PROVIDED WITH:

3 keys.

ON REQUEST:

Special keying systems KA-MK-GMK-CL.

CLUTCHING DOUBLE CYLINDER WITH TEMPORARY KEY

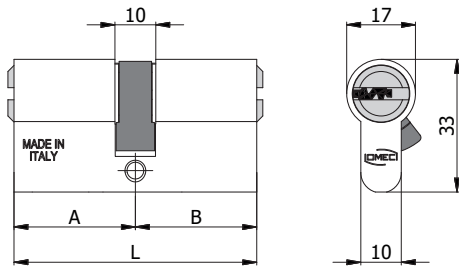
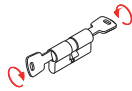

CONSTRUCTIVE FEATURES:

High resistance aluminium body - Easy entrance key nickel-plated brass plugs - Stainless steel pins and drivers - Stainless steel springs - Steel off center 30° DIN cam - Silver nickel reversible flat keys with code number - Brass temporary key with code number.

WORKING:

Turn the key 360° - The keys are independent and can operate on the cylinder even if on the other side the key was inserted and turned.

PROVIDED WITH:

3 keys, 1 temporary key, registration card.

ON REQUEST:

Special keying systems KA-MK-GMK-CL.

COD.	L	A	B	Pin	Key	kg	Box	Box
2122/04 LTK	60	30	30	6	2020/06	0,19	1	10
2122/06 LTK	70	35	35	6	2020/06	0,20	1	10
2122/08 LTK	80	40	40	6	2020/06	0,22	1	10
2122/11 LTK	65	30	35	6	2020/06	0,19	1	10
2122/14 LTK	70	30	40	6	2020/06	0,20	1	10
2122/15 LTK	75	30	45	6	2020/06	0,21	1	10
2122/16 LTK	75	35	40	6	2020/06	0,21	1	10
2122/17 LTK	80	35	45	6	2020/06	0,22	1	10
2122/18 LTK	80	30	50	6	2020/06	0,22	1	10
2122/19 LTK	85	40	45	6	2020/06	0,23	1	5
2122/20 LTK	90	40	50	6	2020/06	0,24	1	5
2122/21 LTK	90	45	45	6	2020/06	0,24	1	5
2122/22 LTK	100	50	50	6	2020/06	0,26	1	5
2122/23 LTK	85	30	55	6	2020/06	0,23	1	5
2122/24 LTK	90	30	60	6	2020/06	0,24	1	5
2122/25 LTK	95	30	65	6	2020/06	0,25	1	5
2122/26 LTK	100	30	70	6	2020/06	0,26	1	5
2122/27 LTK	110	30	80	6	2020/06	0,28	1	5
2122/28 LTK	85	35	50	6	2020/06	0,23	1	5
2122/29 LTK	90	35	55	6	2020/06	0,24	1	5
2122/30 LTK	95	35	60	6	2020/06	0,25	1	5
2122/31 LTK	100	35	65	6	2020/06	0,26	1	5
2122/32 LTK	95	40	55	6	2020/06	0,25	1	5
2122/33 LTK	100	40	60	6	2020/06	0,26	1	5
2122/34 LTK	110	40	70	6	2020/06	0,28	1	5
2122/35 LTK	120	40	80	6	2020/06	0,30	1	5
2122/36 LTK	95	45	50	6	2020/06	0,25	1	5
2122/37 LTK	100	45	55	6	2020/06	0,26	1	5
2122/38 LTK	110	50	60	6	2020/06	0,28	1	5
2122/39 LTK	120	60	60	6	2020/06	0,30	1	5
2122/40 LTK	120	50	70	6	2020/06	0,30	1	5
2122/41 LTK	120	30	90	6	2020/06	0,30	1	5
2122/42 LTK	105	30	75	6	2020/06	0,27	1	5
2122/43 LTK	105	45	60	6	2020/06	0,27	1	5
2122/44 LTK	115	50	65	6	2020/06	0,29	1	5
2122/45 LTK	110	55	55	6	2020/06	0,28	1	5
2122/46 LTK	110	45	65	6	2020/06	0,28	1	5

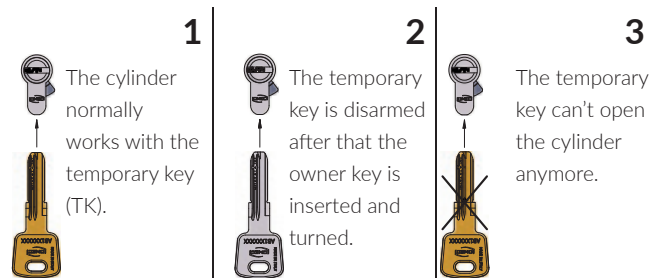
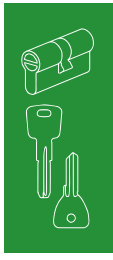

CLUTCHING DOUBLE CYLINDER

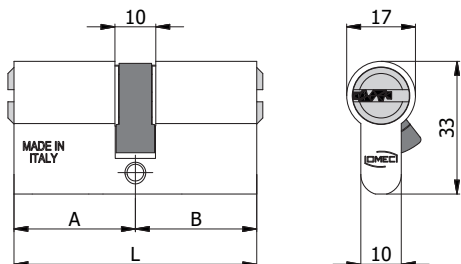
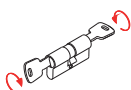

COD.	L	A	B	Pin	Key	kg	Box	Box
2122/504 L	60	30	30	6	2020/06	0,21	1	10
2122/506 L	70	35	35	6	2020/06	0,22	1	10
2122/508 L	80	40	40	6	2020/06	0,24	1	10
2122/511 L	65	30	35	6	2020/06	0,21	1	10
2122/514 L	70	30	40	6	2020/06	0,22	1	10
2122/515 L	75	30	45	6	2020/06	0,23	1	10
2122/516 L	75	35	40	6	2020/06	0,23	1	10
2122/517 L	80	35	45	6	2020/06	0,24	1	10
2122/518 L	80	30	50	6	2020/06	0,24	1	10
2122/519 L	85	40	45	6	2020/06	0,25	1	10
2122/520 L	90	40	50	6	2020/06	0,26	1	5
2122/521 L	90	45	45	6	2020/06	0,26	1	5
2122/522 L	100	50	50	6	2020/06	0,28	1	5
2122/523 L	85	30	55	6	2020/06	0,25	1	10
2122/524 L	90	30	60	6	2020/06	0,26	1	5
2122/525 L	95	30	65	6	2020/06	0,27	1	5
2122/526 L	100	30	70	6	2020/06	0,28	1	5
2122/527 L	110	30	80	6	2020/06	0,30	1	5
2122/528 L	85	35	50	6	2020/06	0,25	1	10
2122/529 L	90	35	55	6	2020/06	0,26	1	5
2122/530 L	95	35	60	6	2020/06	0,27	1	5
2122/531 L	100	35	65	6	2020/06	0,28	1	5
2122/532 L	95	40	55	6	2020/06	0,27	1	5
2122/533 L	100	40	60	6	2020/06	0,28	1	5
2122/534 L	110	40	70	6	2020/06	0,30	1	5
2122/535 L	120	40	80	6	2020/06	0,32	1	5
2122/536 L	95	45	50	6	2020/06	0,27	1	5
2122/537 L	100	45	55	6	2020/06	0,28	1	5
2122/538 L	110	50	60	6	2020/06	0,30	1	5
2122/539 L	120	60	60	6	2020/06	0,32	1	5
2122/540 L	120	50	70	6	2020/06	0,32	1	5
2122/541 L	120	30	90	6	2020/06	0,32	1	5
2122/542 L	105	30	75	6	2020/06	0,29	1	5
2122/543 L	105	45	60	6	2020/06	0,29	1	5
2122/544 L	115	50	65	6	2020/06	0,31	1	5
2122/545 L	110	55	55	6	2020/06	0,30	1	5
2122/546 L	110	45	65	6	2020/06	0,30	1	5

CONSTRUCTIVE FEATURES:

High resistance aluminium body - Easy entrance key nickel-plated brass plugs - Stainless steel pins and drivers - Stainless steel springs - Steel off center 30° DIN cam - Silver nickel reversible flat keys with code number.

WORKING:

Turn the key 360° - The keys are independent and can operate on the cylinder even if on the other side the key was inserted and turned.

PROVIDED WITH:

5 keys, registration card.

ON REQUEST:

Special keying systems KA-MK-GMK-CL.

CLUTCHING DOUBLE CYLINDER WITH TEMPORARY KEY

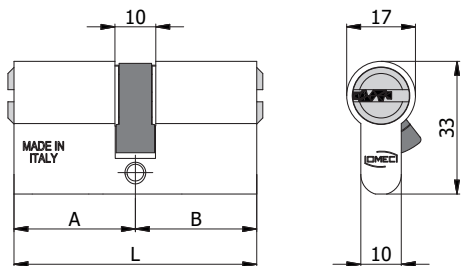
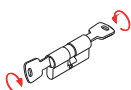

COD.	L	A	B	Pin	Key	kg	Box	Box
2122/504 L TK	60	30	30	6	2020/06	0,23	1	5
2122/506 L TK	70	35	35	6	2020/06	0,24	1	5
2122/508 L TK	80	40	40	6	2020/06	0,26	1	5
2122/511 L TK	65	30	35	6	2020/06	0,23	1	5
2122/514 L TK	70	30	40	6	2020/06	0,24	1	5
2122/515 L TK	75	30	45	6	2020/06	0,25	1	5
2122/516 L TK	75	35	40	6	2020/06	0,25	1	5
2122/517 L TK	80	35	45	6	2020/06	0,26	1	5
2122/518 L TK	80	30	50	6	2020/06	0,26	1	5
2122/519 L TK	85	40	45	6	2020/06	0,27	1	5
2122/520 L TK	90	40	50	6	2020/06	0,28	1	5
2122/521 L TK	90	45	45	6	2020/06	0,28	1	5
2122/522 L TK	100	50	50	6	2020/06	0,30	1	5
2122/523 L TK	85	30	55	6	2020/06	0,27	1	5
2122/524 L TK	90	30	60	6	2020/06	0,28	1	5
2122/525 L TK	95	30	65	6	2020/06	0,29	1	5
2122/526 L TK	100	30	70	6	2020/06	0,30	1	5
2122/527 L TK	110	30	80	6	2020/06	0,32	1	5
2122/528 L TK	85	35	50	6	2020/06	0,27	1	5
2122/529 L TK	90	35	55	6	2020/06	0,28	1	5
2122/530 L TK	95	35	60	6	2020/06	0,29	1	5
2122/531 L TK	100	35	65	6	2020/06	0,30	1	5
2122/532 L TK	95	40	55	6	2020/06	0,29	1	5
2122/533 L TK	100	40	60	6	2020/06	0,30	1	5
2122/534 L TK	110	40	70	6	2020/06	0,32	1	5
2122/535 L TK	120	40	80	6	2020/06	0,34	1	5
2122/536 L TK	95	45	50	6	2020/06	0,29	1	5
2122/537 L TK	100	45	55	6	2020/06	0,30	1	5
2122/538 L TK	110	50	60	6	2020/06	0,32	1	5
2122/539 L TK	120	60	60	6	2020/06	0,34	1	5
2122/540 L TK	120	50	70	6	2020/06	0,34	1	5
2122/541 L TK	120	30	90	6	2020/06	0,34	1	5
2122/542 L TK	105	30	75	6	2020/06	0,31	1	5
2122/543 L TK	105	45	60	6	2020/06	0,31	1	5
2122/544 L TK	115	50	65	6	2020/06	0,33	1	5
2122/545 L TK	110	55	55	6	2020/06	0,32	1	5
2122/546 L TK	110	45	65	6	2020/06	0,32	1	5

CONSTRUCTIVE FEATURES:

High resistance aluminium body - Easy entrance key nickel-plated brass plugs - Stainless steel pins and drivers - Stainless steel springs - Steel off center 30° DIN cam - Silver nickel reversible flat keys with code number - Brass temporary key with code number.

WORKING:

Turn the key 360° - The keys are independent and can operate on the cylinder even if on the other side the key was inserted and turned.

PROVIDED WITH:

5 keys, 1 temporary key, registration card.

ON REQUEST:

Special keying systems KA-MK-GMK-CL..

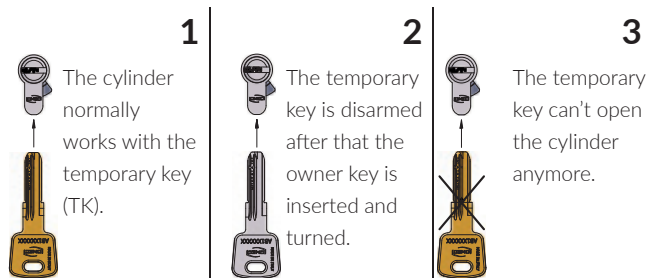
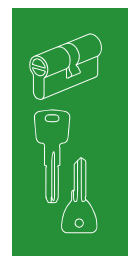

DOUBLE CYLINDER WITH KNOB

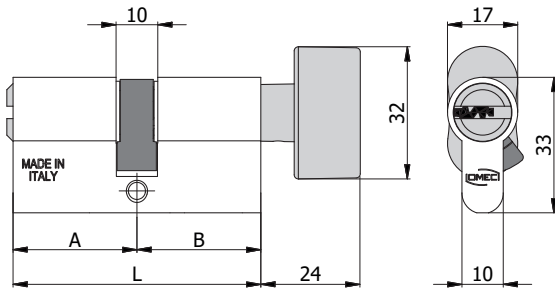

CONSTRUCTIVE FEATURES:

High resistance aluminium body - Easy entrance key nickel-plated brass plug - Stainless steel pins and drivers - Stainless steel springs - Steel off center 30° DIN cam - Satin nickel-plated special alloy knob - Silver nickel reversible flat keys with code number.

WORKING:

Turn the key or knob 360°.

PROVIDED WITH:

3 keys.

ON REQUEST:

Special keying systems KA-MK-GMK-CL.

COD.	L	A	B					
2123/04 L	60	30	30	6	2020/06	0,21	1	10
2123/07 L	70	35	35	6	2020/06	0,22	1	5
2123/10 L	80	40	40	6	2020/06	0,24	1	5
2123/13 L	65	30	35	6	2020/06	0,21	1	5
2123/14 L	70	30	40	6	2020/06	0,22	1	5
2123/15 L	75	30	45	6	2020/06	0,23	1	5
2123/16 L	80	30	50	6	2020/06	0,24	1	5
2123/17 L	90	30	60	6	2020/06	0,26	1	5
2123/18 L	100	30	70	6	2020/06	0,28	1	5
2123/19 L	110	30	80	6	2020/06	0,30	1	5
2123/20 L	65	35	30	6	2020/06	0,21	1	5
2123/21 L	75	35	40	6	2020/06	0,23	1	5
2123/22 L	80	35	45	6	2020/06	0,24	1	5
2123/23 L	85	35	50	6	2020/06	0,25	1	5
2123/24 L	70	40	30	6	2020/06	0,22	1	5
2123/25 L	75	40	35	6	2020/06	0,23	1	5
2123/26 L	85	40	45	6	2020/06	0,25	1	5
2123/27 L	90	40	50	6	2020/06	0,26	1	5
2123/28 L	100	40	60	6	2020/06	0,28	1	5
2123/29 L	110	40	70	6	2020/06	0,30	1	5
2123/30 L	120	40	80	6	2020/06	0,32	1	5
2123/31 L	75	45	30	6	2020/06	0,23	1	5
2123/32 L	80	45	35	6	2020/06	0,24	1	5
2123/33 L	85	45	40	6	2020/06	0,25	1	5
2123/34 L	90	45	45	6	2020/06	0,26	1	5
2123/35 L	80	50	30	6	2020/06	0,24	1	5
2123/36 L	85	50	35	6	2020/06	0,25	1	5
2123/37 L	90	50	40	6	2020/06	0,26	1	5
2123/38 L	100	50	50	6	2020/06	0,28	1	5
2123/39 L	110	50	60	6	2020/06	0,30	1	5
2123/40 L	90	60	30	6	2020/06	0,26	1	5
2123/41 L	95	60	35	6	2020/06	0,27	1	5
2123/42 L	100	60	40	6	2020/06	0,28	1	5
2123/43 L	110	60	50	6	2020/06	0,30	1	5
2123/44 L	120	60	60	6	2020/06	0,32	1	5
2123/45 L	100	70	30	6	2020/06	0,28	1	5
2123/46 L	85	55	30	6	2020/06	0,25	1	5
2123/47 L	110	80	30	6	2020/06	0,30	1	5

DOUBLE CYLINDER WITH KNOB WITH TEMPORARY KEY

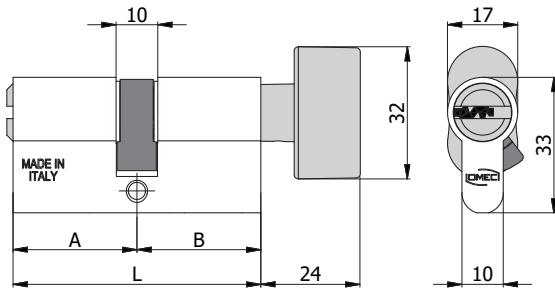

CONSTRUCTIVE FEATURES:

High resistance aluminium body - Easy entrance key nickel-plated brass plug - Stainless steel pins and drivers - Stainless steel springs - Steel off center 30° DIN cam - Satin nickel-plated special alloy knob - Silver nickel reversible flat keys with code number - Brass temporary key with code number.

WORKING:

Turn the key or knob 360°.

PROVIDED WITH:

3 keys, 1 temporary key, registration card.

ON REQUEST:

Special keying systems KA-MK-GMK-CL.

COD.	L	A	B	Pin	Key	kg	Box	Box
2123/04 LTK	60	30	30	6	2020/06	0,24	1	10
2123/07 LTK	70	35	35	6	2020/06	0,25	1	5
2123/10 LTK	80	40	40	6	2020/06	0,27	1	5
2123/13 LTK	65	30	35	6	2020/06	0,24	1	5
2123/14 LTK	70	30	40	6	2020/06	0,25	1	5
2123/15 LTK	75	30	45	6	2020/06	0,26	1	5
2123/16 LTK	80	30	50	6	2020/06	0,27	1	5
2123/17 LTK	90	30	60	6	2020/06	0,29	1	5
2123/18 LTK	100	30	70	6	2020/06	0,31	1	5
2123/19 LTK	110	30	80	6	2020/06	0,33	1	5
2123/20 LTK	65	35	30	6	2020/06	0,24	1	5
2123/21 LTK	75	35	40	6	2020/06	0,26	1	5
2123/22 LTK	80	35	45	6	2020/06	0,27	1	5
2123/23 LTK	85	35	50	6	2020/06	0,28	1	5
2123/24 LTK	70	40	30	6	2020/06	0,25	1	5
2123/25 LTK	75	40	35	6	2020/06	0,26	1	5
2123/26 LTK	85	40	45	6	2020/06	0,28	1	5
2123/27 LTK	90	40	50	6	2020/06	0,29	1	5
2123/28 LTK	100	40	60	6	2020/06	0,31	1	5
2123/29 LTK	110	40	70	6	2020/06	0,33	1	5
2123/30 LTK	120	40	80	6	2020/06	0,35	1	5
2123/31 LTK	75	45	30	6	2020/06	0,26	1	5
2123/32 LTK	80	45	35	6	2020/06	0,27	1	5
2123/33 LTK	85	45	40	6	2020/06	0,28	1	5
2123/34 LTK	90	45	45	6	2020/06	0,29	1	5
2123/35 LTK	80	50	30	6	2020/06	0,27	1	5
2123/36 LTK	85	50	35	6	2020/06	0,28	1	5
2123/37 LTK	90	50	40	6	2020/06	0,29	1	5
2123/38 LTK	100	50	50	6	2020/06	0,31	1	5
2123/39 LTK	110	50	60	6	2020/06	0,33	1	5
2123/40 LTK	90	60	30	6	2020/06	0,29	1	5
2123/41 LTK	95	60	35	6	2020/06	0,30	1	5
2123/42 LTK	100	60	40	6	2020/06	0,31	1	5
2123/43 LTK	110	60	50	6	2020/06	0,33	1	5
2123/44 LTK	120	60	60	6	2020/06	0,35	1	5
2123/45 LTK	100	70	30	6	2020/06	0,31	1	5
2123/46 LTK	85	55	30	6	2020/06	0,28	1	5
2123/47 LTK	110	80	30	6	2020/06	0,33	1	5

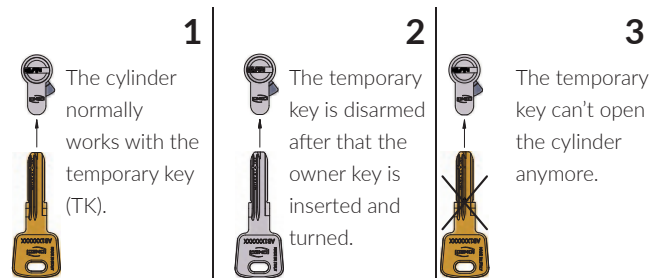
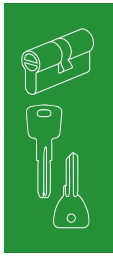

DOUBLE CYLINDER WITH KNOB

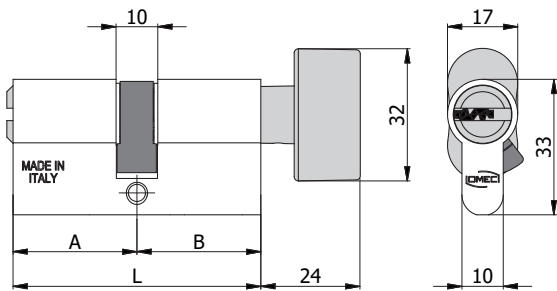

CONSTRUCTIVE FEATURES:

High resistance aluminium body - Easy entrance key nickel-plated brass plug - Stainless steel pins and drivers - Stainless steel springs - Steel off center 30° DIN cam - Satin nickel-plated special alloy knob - Silver nickel reversible flat keys with code number.

WORKING:

Turn the key or knob 360°.

PROVIDED WITH:

5 keys, registration card.

ON REQUEST:

Special keying systems KA-MK-GMK-CL.

COD.	L	A	B					
2123/504 L	60	30	30	6	2020/06	0,26	1	10
2123/507 L	70	35	35	6	2020/06	0,27	1	5
2123/510 L	80	40	40	6	2020/06	0,29	1	5
2123/513 L	65	30	35	6	2020/06	0,26	1	5
2123/514 L	70	30	40	6	2020/06	0,27	1	5
2123/515 L	75	30	45	6	2020/06	0,28	1	5
2123/516 L	80	30	50	6	2020/06	0,29	1	5
2123/517 L	90	30	60	6	2020/06	0,31	1	5
2123/518 L	100	30	70	6	2020/06	0,33	1	5
2123/519 L	110	30	80	6	2020/06	0,35	1	5
2123/520 L	65	35	30	6	2020/06	0,26	1	5
2123/521 L	75	35	40	6	2020/06	0,28	1	5
2123/522 L	80	35	45	6	2020/06	0,29	1	5
2123/523 L	85	35	50	6	2020/06	0,30	1	5
2123/524 L	70	40	30	6	2020/06	0,27	1	5
2123/525 L	75	40	35	6	2020/06	0,28	1	5
2123/526 L	85	40	45	6	2020/06	0,30	1	5
2123/527 L	90	40	50	6	2020/06	0,31	1	5
2123/528 L	100	40	60	6	2020/06	0,33	1	5
2123/529 L	110	40	70	6	2020/06	0,35	1	5
2123/530 L	120	40	80	6	2020/06	0,37	1	5
2123/531 L	75	45	30	6	2020/06	0,28	1	5
2123/532 L	80	45	35	6	2020/06	0,29	1	5
2123/533 L	85	45	40	6	2020/06	0,30	1	5
2123/534 L	90	45	45	6	2020/06	0,31	1	5
2123/535 L	80	50	30	6	2020/06	0,29	1	5
2123/536 L	85	50	35	6	2020/06	0,30	1	5
2123/537 L	90	50	40	6	2020/06	0,31	1	5
2123/538 L	100	50	50	6	2020/06	0,33	1	5
2123/539 L	110	50	60	6	2020/06	0,35	1	5
2123/540 L	90	60	30	6	2020/06	0,31	1	5
2123/541 L	95	60	35	6	2020/06	0,32	1	5
2123/542 L	100	60	40	6	2020/06	0,33	1	5
2123/543 L	110	60	50	6	2020/06	0,35	1	5
2123/544 L	120	60	60	6	2020/06	0,37	1	5
2123/545 L	100	70	30	6	2020/06	0,33	1	5
2123/546 L	85	55	30	6	2020/06	0,30	1	5
2123/547 L	110	80	30	6	2020/06	0,35	1	5

DOUBLE CYLINDER WITH KNOB WITH TEMPORARY KEY

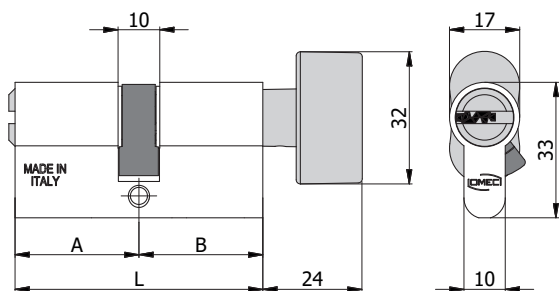

CONSTRUCTIVE FEATURES:

High resistance aluminium body - Easy entrance key nickel-plated brass plug - Stainless steel pins and drivers - Stainless steel springs - Steel off center 30° DIN cam - Satin nickel-plated special alloy knob - Silver nickel reversible flat keys with code number - Brass temporary key with code number.

WORKING:

Turn the key or knob 360°.

PROVIDED WITH:

5 keys, 1 temporary key, registration card.

ON REQUEST:

Special keying systems KA-MK-GMK-CL.

COD.	L	A	B	Pin	Key	kg	Box	Box
2123/504 L TK	60	30	30	6	2020/06	0,28	1	5
2123/507 L TK	70	35	35	6	2020/06	0,29	1	5
2123/510 L TK	80	40	40	6	2020/06	0,31	1	5
2123/513 L TK	65	30	35	6	2020/06	0,28	1	5
2123/514 L TK	70	30	40	6	2020/06	0,29	1	5
2123/515 L TK	75	30	45	6	2020/06	0,30	1	5
2123/516 L TK	80	30	50	6	2020/06	0,31	1	5
2123/517 L TK	90	30	60	6	2020/06	0,33	1	5
2123/518 L TK	100	30	70	6	2020/06	0,35	1	5
2123/519 L TK	110	30	80	6	2020/06	0,37	1	5
2123/520 L TK	65	35	30	6	2020/06	0,28	1	5
2123/521 L TK	75	35	40	6	2020/06	0,30	1	5
2123/522 L TK	80	35	45	6	2020/06	0,31	1	5
2123/523 L TK	85	35	50	6	2020/06	0,32	1	5
2123/524 L TK	70	40	30	6	2020/06	0,29	1	5
2123/525 L TK	75	40	35	6	2020/06	0,30	1	5
2123/526 L TK	85	40	45	6	2020/06	0,32	1	5
2123/527 L TK	90	40	50	6	2020/06	0,33	1	5
2123/528 L TK	100	40	60	6	2020/06	0,35	1	5
2123/529 L TK	110	40	70	6	2020/06	0,37	1	5
2123/530 L TK	120	40	80	6	2020/06	0,39	1	5
2123/531 L TK	75	45	30	6	2020/06	0,30	1	5
2123/532 L TK	80	45	35	6	2020/06	0,31	1	5
2123/533 L TK	85	45	40	6	2020/06	0,32	1	5
2123/534 L TK	90	45	45	6	2020/06	0,33	1	5
2123/535 L TK	80	50	30	6	2020/06	0,31	1	5
2123/536 L TK	85	50	35	6	2020/06	0,32	1	5
2123/537 L TK	90	50	40	6	2020/06	0,33	1	5
2123/538 L TK	100	50	50	6	2020/06	0,35	1	5
2123/539 L TK	110	50	60	6	2020/06	0,37	1	5
2123/540 L TK	90	60	30	6	2020/06	0,33	1	5
2123/541 L TK	95	60	35	6	2020/06	0,34	1	5
2123/542 L TK	100	60	40	6	2020/06	0,35	1	5
2123/543 L TK	110	60	50	6	2020/06	0,37	1	5
2123/544 L TK	120	60	60	6	2020/06	0,39	1	5
2123/545 L TK	100	70	30	6	2020/06	0,35	1	5
2123/546 L TK	85	55	30	6	2020/06	0,32	1	5
2123/547 L TK	110	80	30	6	2020/06	0,37	1	5

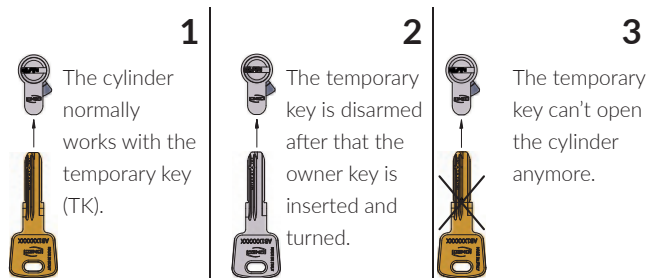

DOUBLE CYLINDER WITH SHANK



CONSTRUCTIVE FEATURES:

High resistance aluminium body - Easy entrance key nickel-plated brass plug - Stainless steel pins and drivers - Stainless steel springs - Steel off center 30° DIN cam - Brass shank - Silver nickel reversible flat keys with code number.

WORKING:

Turn the key or knob 360°.

PROVIDED WITH:

3 keys.

ON REQUEST:

Special keying systems KA-MK-GMK-CL.

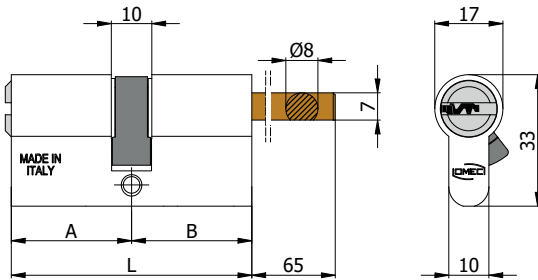

COD.	L	A	B					
2126/04 L	60	30	30	6	2020/06	0,18	1	5
2126/20 L	65	35	30	6	2020/06	0,18	1	5
2126/24 L	70	40	30	6	2020/06	0,19	1	5
2126/31 L	75	45	30	6	2020/06	0,20	1	5
2126/35 L	80	50	30	6	2020/06	0,21	1	5
2126/40 L	90	60	30	6	2020/06	0,23	1	5
2126/45 L	100	70	30	6	2020/06	0,25	1	5
2126/46 L	85	55	30	6	2020/06	0,22	1	5

DOUBLE CYLINDER WITH SHANK WITH TEMPORARY KEY



CONSTRUCTIVE FEATURES:

High resistance aluminium body - Easy entrance key nickel-plated brass plug - Stainless steel pins and drivers - Stainless steel springs - Steel off center 30° DIN cam - Brass shank - Silver nickel reversible flat keys with code number - Brass temporary key with code number.

WORKING:

Turn the key or knob 360°.

PROVIDED WITH:

3 keys, 1 temporary key, registration card.

ON REQUEST:

Special keying systems KA-MK-GMK-CL.

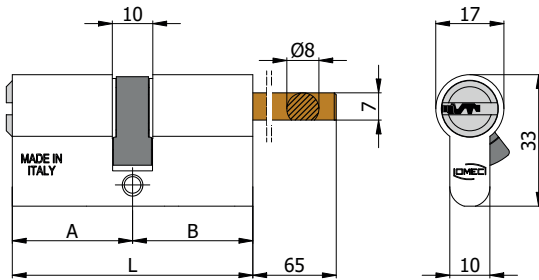
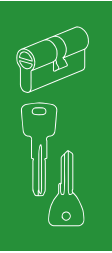

COD.	L	A	B					
2126/04 LTK	60	30	30	6	2020/06	0,21	1	5
2126/20 LTK	65	35	30	6	2020/06	0,21	1	5
2126/24 LTK	70	40	30	6	2020/06	0,22	1	5
2126/31 LTK	75	45	30	6	2020/06	0,23	1	5
2126/35 LTK	80	50	30	6	2020/06	0,24	1	5
2126/40 LTK	90	60	30	6	2020/06	0,26	1	5
2126/45 LTK	100	70	30	6	2020/06	0,28	1	5
2126/46 LTK	85	55	30	6	2020/06	0,25	1	5

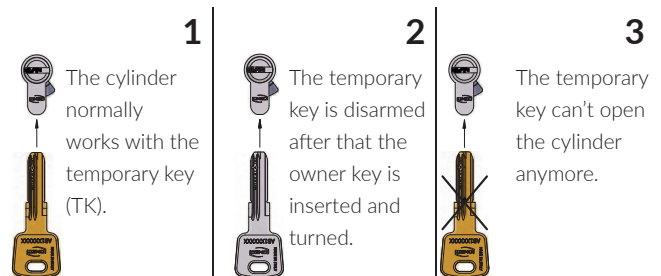

DOUBLE CYLINDER WITH SHANK



CONSTRUCTIVE FEATURES:

High resistance aluminium body - Easy entrance key nickel-plated brass plug - Stainless steel pins and drivers - Stainless steel springs - Steel off center 30° DIN cam - Brass shank - Silver nickel reversible flat keys with code number.

WORKING:

Turn the key or knob 360°.

PROVIDED WITH:

5 keys, registration card.

ON REQUEST:

Special keying systems KA-MK-GMK-CL.

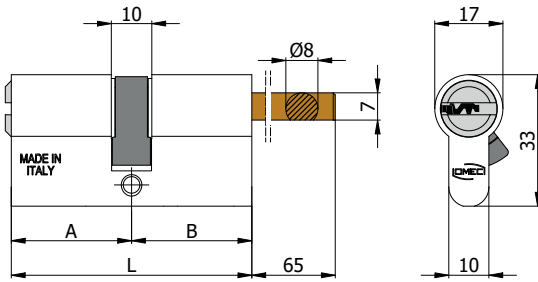

COD.	L	A	B					
2126/504 L	60	30	30	6	2020/06	0,23	1	5
2126/520 L	65	35	30	6	2020/06	0,23	1	5
2126/524 L	70	40	30	6	2020/06	0,24	1	5
2126/531 L	75	45	30	6	2020/06	0,25	1	5
2126/535 L	80	50	30	6	2020/06	0,26	1	5
2126/540 L	90	60	30	6	2020/06	0,28	1	5
2126/545 L	100	70	30	6	2020/06	0,30	1	5
2126/546 L	85	55	30	6	2020/06	0,27	1	5

DOUBLE CYLINDER WITH SHANK WITH TEMPORARY KEY



CONSTRUCTIVE FEATURES:

High resistance aluminium body - Easy entrance key nickel-plated brass plug - Stainless steel pins and drivers - Stainless steel springs - Steel off center 30° DIN cam - Brass shank - Silver nickel reversible flat keys with code number - Brass temporary key with code number.

WORKING:

Turn the key or knob 360°.

PROVIDED WITH:

5 keys, 1 temporary key, registration card.

ON REQUEST:

Special keying systems KA-MK-GMK-CL.

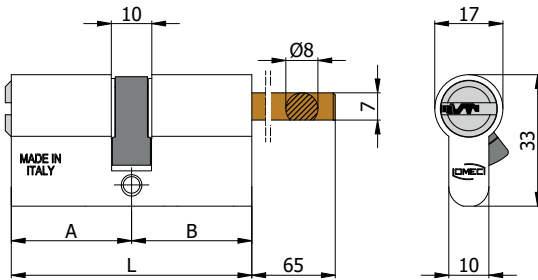
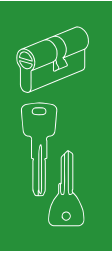

COD.	L	A	B					
2126/504 L TK	60	30	30	6	2020/06	0,25	1	5
2126/520 L TK	65	35	30	6	2020/06	0,25	1	5
2126/524 L TK	70	40	30	6	2020/06	0,26	1	5
2126/531 L TK	75	45	30	6	2020/06	0,27	1	5
2126/535 L TK	80	50	30	6	2020/06	0,28	1	5
2126/540 L TK	90	60	30	6	2020/06	0,30	1	5
2126/545 L TK	100	70	30	6	2020/06	0,32	1	5
2126/546 L TK	85	55	30	6	2020/06	0,29	1	5

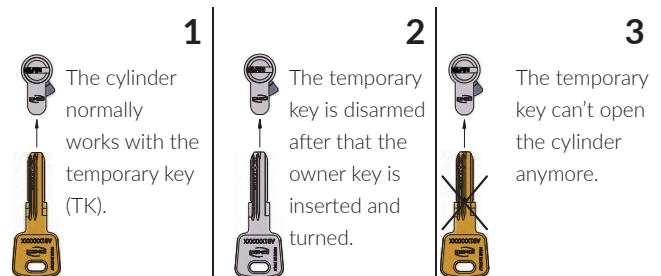

OTTOO

CHOOSE THE RIGHT SIZE



Security and flexibility

Otto is the easiest and quickest cylinder to assemble that combines the flexibility of the modular system with the security of 8 active pins and the guarantee of Omec quality.



Technology at your hand.

4 GOOD REASONS TO CHOOSE OTTOO



Materials

High resistance aluminium body with ceramic patented treatment to reach top corrosion resistance and durability.

Nickel-plated easy entrance key plug to allow a smoother insert of the key and prevent its breaking.



Durability

Tested and certified for 100.000 opening cycles.



Modularity

Any size you need just with a screwdriver.

Otto is available already assembled or to be assembled on site, thanks to the quick and easy modular system that allows you to assemble any cylinder only using a screwdriver, for maximum flexibility and minimum stock, even for special systems.



Security



DRILL RESISTANT

3 tempered steel drill resistant pins.



8 ACTIVE PINS

8 active pins on two rows: over 300.000 combinations.



SACRIFICIAL CUT

Anti-pick and anti-snap sacrificial cut on the cylinder body.



PICKLOCK RESISTANT

Stainless steel pins, springs and drivers.



PUSH RESISTANT

Self-lubricating steel 30° DIN cam. Clutching version for emergency function.



EVEN MORE SECURE IN THE MODULAR VERSION

Patented system with tear resistant steel bar and connecting screws.

THE KEY TO SUCCESS



Code

Indirect codification on the key head.



Thickness 3 mm

For a higher resistance to breaking.



Reversibility

Flat silver-nickel reversible key with long neck compatible with security escutcheon.



Pins levels 0,5 mm

For an higher security in combinations.



Ergonomics

Ergonomic and removeable key cover interchangeable and available in many different colours.

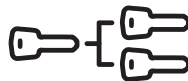

Special keying systems

Special systems KA-MK-GMK-CL. Up to 50.000 different cylinders opened with 1 master key.



Security

Over 300.000 different combinations.



Temporary key

Temporary key made of brass.



Property card

Security card with code number to duplicate the key in maximum security, duplications allowed only from authorized dealers.

CODICE DI SICUREZZA
SECURITY CODE



OTTOO

ALL THE VERSIONS

Even better.

Otto is available with a satin-nickel coloured aluminum body and in a refined black finish. The modular version offers the possibility of choosing the most aesthetically elegant solution in the same colour as the door profile directly on site: you just need to assemble the heads of the preferred colour.



The complete range always ready for installation

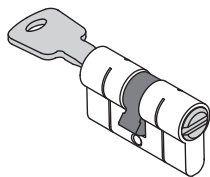

SERIES 320
Double cylinder

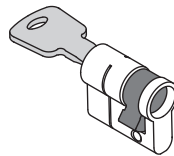

SERIES 321
Half cylinder

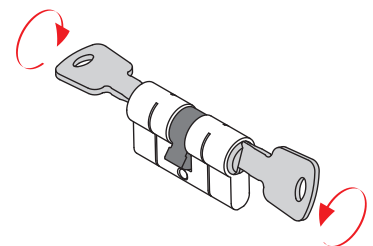

SERIES 322
Double clutching cylinder

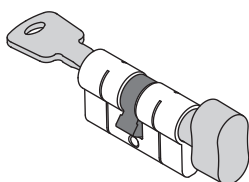

SERIES 323
Double cylinder with knob

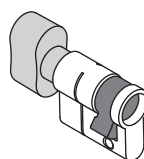

SERIES 324
Half cylinder with knob

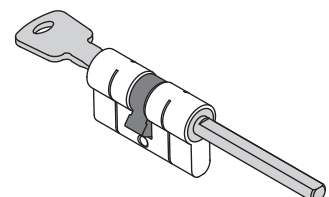

SERIES 326
Double cylinder with shank

OTTOO THE IDEAL SOLUTION FOR YOUR JOB

Modular, quick and secure.

The modular system makes it possible to optimize warehouse stocks and immediately satisfy any requests from the customer, even on site.

Otto is the only cylinder with a patented system with fixing screws that reach the cylinder plug, for maximum tear resistance and maximum ease of assembly.



Any dimensions you need

Modular sizes starting from 30+30 mm for the double cylinder and from 30+10 mm for the half cylinder, with extensions of 5 - 10 - 15 - 20 mm, to satisfy any assembly needs in less than a minute, for profiles up to 150 mm thick.



A case for all components

All the components for assembling the modular cylinder are supplied in a handy case, in order to be able to assemble cylinders suitable for any thickness of the door, directly on site.

All modules are pre-assembled and individually tested, for total quality guarantee.



Technology at your hand.

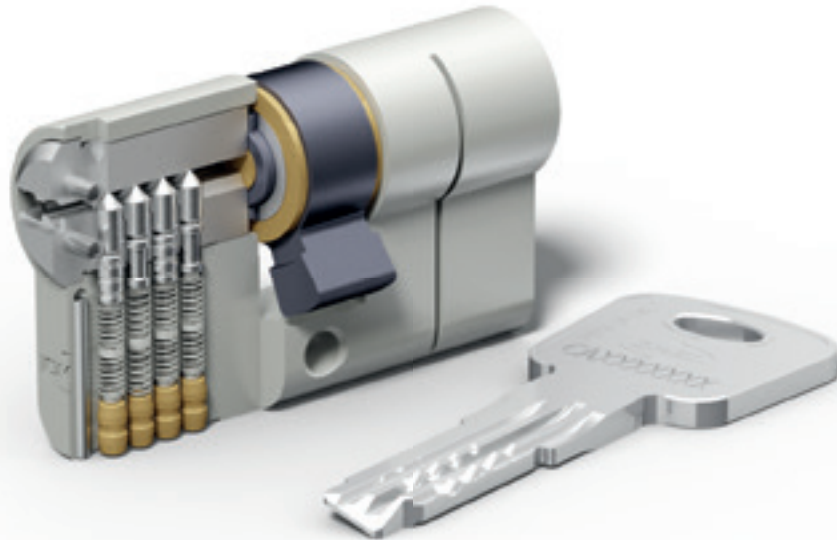

SECURITY

8 active pins on two rows: over 300.000 combinations
 3 tempered steel drill resistant pins
 Sacrificial cut on the cylinder body
 Picklock resistant
 Push resistant 30° DIN cam
 Clutching version for emergency function



REVERSIBLE KEY

Flat silver-nickel reversible key with long neck compatible with security escutcheon



PROPERTY CARD

Security card with code number to duplicate the key in maximum security, duplications allowed only from authorized dealers



TEMPORARY KEY

Brass temporary key that gets disarmed after the owner key is inserted and turned



MATERIALS

High resistance aluminium alloy body with patented ceramic treatment
 Easy entrance key nickel-plated brass plugs
 Stainless steel pins and springs
 Self-lubricating steel cam



ERGONOMICS

Ergonomic and removeable key cover interchangeable and available in many different colours



MASTER KEY POTENTIAL

Special keying systems KA-MK-GMK-CL
 For a high security level MK system: 50.000 possible combinations

Salt spray tested for 96 h
 Durability over 100.000 cycles

DESIGNED AND CERTIFIED ACCORDING TO EUROPEAN STANDARD

UNI EN 1303:15 - BS EN 1303:15 - ICIM 0039CS							
1	6	0	A	0	C	6	B

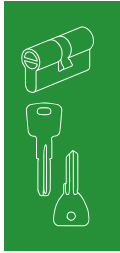

CATEGORY OF USE

1= for use by people with a high incentive to exercise care and with a small chance of misuse



DURABILITY

6 = 100.000 test cycles



DOOR MASS

0 = no door mass requirement



SUITABLE FOR USE ON FIRE RESISTANT/SMOKE CONTROL DOORS

A = suitable for use on smoke control doors



SAFETY

0 = no safety requirement



CORROSION RESISTANCE AND TEMPERATURE

C = high corrosion resistance; temperature requirement: from -25°C to +65°C



KEY RELATED SECURITY

6 = over 300.000 combinations



ATTACK RESISTANCE

B = resistance to drilling for 5/10 minutes and mechanical attack, excluding plug extraction

DOUBLE CYLINDER



CONSTRUCTIVE FEATURES:

High resistance aluminium body with anti-drill pins and controlled snap cut - Easy entrance key nickel-plated brass plugs with anti-drill pins - Stainless steel pins and drivers - Stainless steel springs - Self-lubricating steel off center 30° DIN cam - Silver nickel reversible flat keys with code number.

WORKING:

Turn the key 360° - The keys are dependent and cannot operate on the cylinder if on the other side the key was inserted and turned.

PROVIDED WITH:

5 keys, registration card.

ON REQUEST:

Special keying systems KA-MK-GMK-CL.

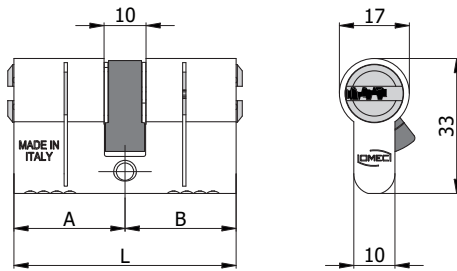

COD.	L	A	B	Pin	Key	Weight (kg)	Box	Keys
320.27.27.5	54	27	27	8	2020/08	0,19	1	5
320.27.27.N.5	Black finish							

DOUBLE CYLINDER WITH TEMPORARY KEY



CONSTRUCTIVE FEATURES:

High resistance aluminium body with anti-drill pins and controlled snap cut - Easy entrance key nickel-plated brass plugs with anti-drill pins - Stainless steel pins and drivers - Stainless steel springs - Self-lubricating steel off center 30° DIN cam - Silver nickel reversible flat keys with code number - Brass temporary key with code number.

WORKING:

Turn the key 360° - The keys are dependent and cannot operate on the cylinder if on the other side the key was inserted and turned.

PROVIDED WITH:

5 keys, 1 temporary key, registration card.

ON REQUEST:

Special keying systems KA-MK-GMK-CL.

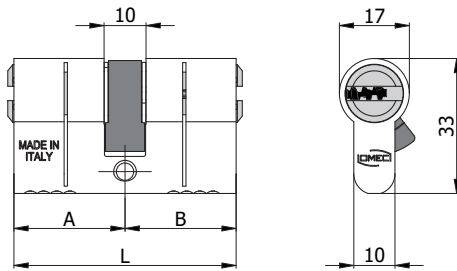
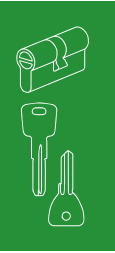

COD.	L	A	B					
320.27.27.5.TK	54	27	27	8	2020/08	0,21	1	5
320.27.7.N.5.TK	Black finish							

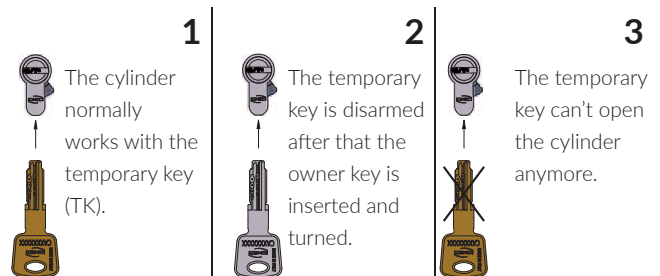

HALF CYLINDER



CONSTRUCTIVE FEATURES:

High resistance aluminium body with anti-drill pins and controlled snap cut - Easy entrance key nickel-plated brass plug with anti-drill pins - Stainless steel pins and drivers - Stainless steel springs - Self-lubricating steel off center 30° DIN cam - Silver nickel reversible flat keys with code number.

WORKING:

Turn the key 360°.

PROVIDED WITH:

5 keys, registration card.

ON REQUEST:

Special keying systems KA-MK-GMK-CL.

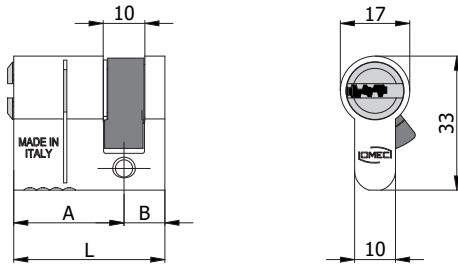

COD.	L	A	B					
321.25.10.5	35	25	10	8	2020/08	0,15	1	5
321.27.10.5	37	27	10	8	2020/08	0,15	1	5
321.30.10.5	40	30	10	8	2020/08	0,15	1	5
321.**.10.N.5	Black finish							

HALF CYLINDER WITH TEMPORARY KEY



CONSTRUCTIVE FEATURES:

High resistance aluminium body with anti-drill pins and controlled snap cut - Easy entrance key nickel-plated brass plug with anti-drill pins - Stainless steel pins and drivers - Stainless steel springs - Self-lubricating steel off center 30° DIN cam - Silver nickel reversible flat keys with code number - Brass temporary key with code number.

WORKING:

Turn the key 360°.

PROVIDED WITH:

5 keys, 1 temporary key, registration card.

ON REQUEST:

Special keying systems KA-MK-GMK-CL.

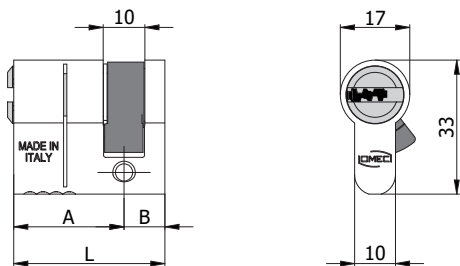
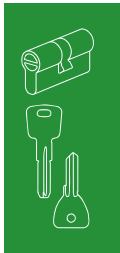

COD.	L	A	B	Pin	Key	Weight (kg)	Box	Keys
321.25.10.5.TK	35	25	10	8	2020/08	0,17	1	5
321.27.10.5.TK	37	27	10	8	2020/08	0,17	1	5
321.30.10.5.TK	40	30	10	8	2020/08	0,17	1	5
321.**.10.N.5.TK	Black finish							

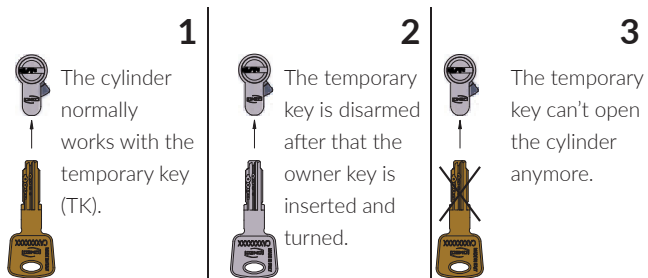

CLUTCHING DOUBLE CYLINDER

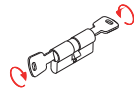

CONSTRUCTIVE FEATURES:

High resistance aluminium body with anti-drill pins and controlled snap cut - Easy entrance key nickel-plated brass plugs with anti-drill pins - Stainless steel pins and drivers - Stainless steel springs - Self-lubricating steel off center 30° DIN cam - Silver nickel reversible flat keys with code number.

WORKING:

Turn the key 360° - The keys are independent and can operate on the cylinder even if on the other side the key was inserted and turned.

PROVIDED WITH:

5 keys, registration card.

ON REQUEST:

Special keying systems KA-MK-GMK-CL.

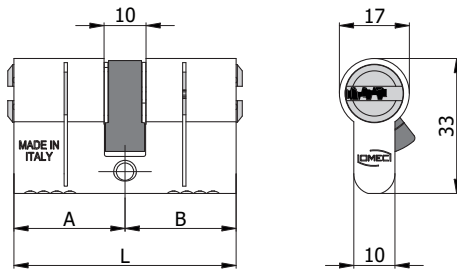

COD.	L	A	B					
322.27.27.5	54	27	27	8	2020/08	0,19	1	5
322.27.27.N.5	Black finish							

CLUTCHING DOUBLE CYLINDER WITH TEMPORARY KEY

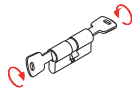

CONSTRUCTIVE FEATURES:

High resistance aluminium body with anti-drill pins and controlled snap cut - Easy entrance key nickel-plated brass plugs with anti-drill pins - Stainless steel pins and drivers - Stainless steel springs - Self-lubricating steel off center 30° DIN cam - Silver nickel reversible flat keys with code number - Brass temporary key with code number.

WORKING:

Turn the key 360° - The keys are independent and can operate on the cylinder even if on the other side the key was inserted and turned.

PROVIDED WITH:

5 keys, 1 temporary key, registration card.

ON REQUEST:

Special keying systems KA-MK-GMK-CL.

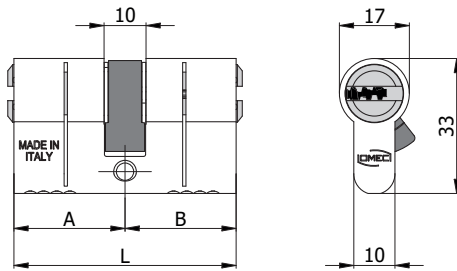
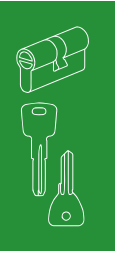

COD.	L	A	B	Pin	Key	Weight (kg)	Box	Keys
322.27.27.5.TK	54	27	27	8	2020/08	0,21	1	5
322.27.27.N.5.TK	Black finish							

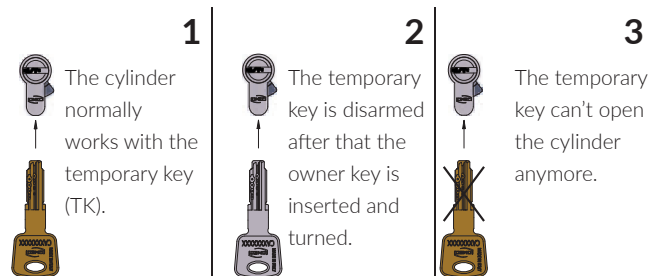

DOUBLE CYLINDER WITH KNOB



CONSTRUCTIVE FEATURES:

High resistance aluminium body with anti-drill pins and controlled snap cut - Easy entrance key nickel-plated brass plug with anti-drill pins - Stainless steel pins and drivers - Stainless steel springs - Self-lubricating steel off center 30° DIN cam - Satin nickel-plated special alloy knob - Silver nickel reversible flat keys with code number.

WORKING:

Turn the key or knob 360°.

PROVIDED WITH:

5 keys, registration card.

ON REQUEST:

Special keying systems KA-MK-GMK-CL.

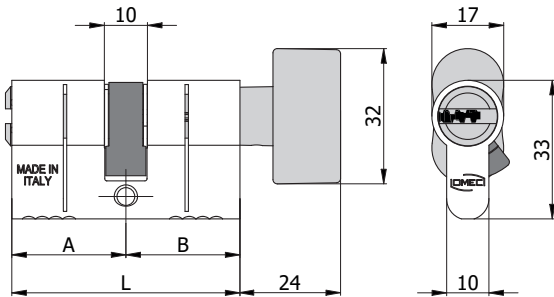

COD.	L	A	B					
323.27.27B.5	54	27	27	8	2020/08	0,23	1	5
323.27.27B.N.5	Black finish							

DOUBLE CYLINDER WITH KNOB WITH TEMPORARY KEY



CONSTRUCTIVE FEATURES:

High resistance aluminium body with anti-drill pins and controlled snap cut - Easy entrance key nickel-plated brass plug with anti-drill pins - Stainless steel pins and drivers - Stainless steel springs - Self-lubricating steel off center 30° DIN cam - Satin nickel-plated special alloy knob - Silver nickel reversible flat keys with code number - Brass temporary key with code number.

WORKING:

Turn the key or knob 360°.

PROVIDED WITH:

5 keys, 1 temporary key, registration card.

ON REQUEST:

Special keying systems KA-MK-GMK-CL.

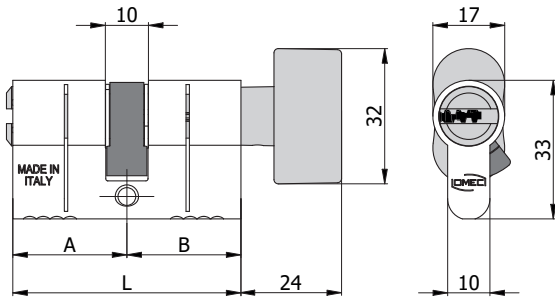
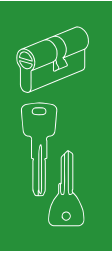

COD.	L	A	B					
323.27.27B.5.TK	54	27	27	8	2020/08	0,25	1	5
323.27.27B.N.5.TK	Black finish							

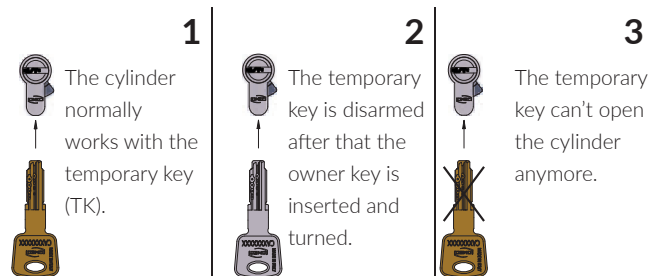



SECURITY

- 8 active pins on two rows: over 300.000 combinations
- 3 tempered steel drill resistant pins
- Sacrificial cut on the cylinder body
- Tear resistance steel bar and connecting screws (patented system)
- Picklock resistant
- Push resistant 30° DIN cam
- Clutching version for emergency function



REVERSIBLE KEY

Flat silver-nickel reversible key with long neck compatible with security escutcheon



PROPERTY CARD

Security card with code number to duplicate the key in maximum security, duplications allowed only from authorized dealers



TEMPORARY KEY

Brass temporary key that gets disarmed after the owner key is inserted and turned



MATERIALS

- High resistance aluminium alloy body with patented ceramic threatment
- Easy entrance key nickel-plated brass plugs
- Stainless steel pins and springs
- Self-lubricating steel cam

Salt spray tested for 96 h
Durability over 100.000 cycles



ERGONOMICS

Ergonomic and removeable key cover interchangelable and available in many different colours

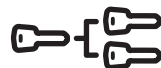

MASTER KEY POTENTIAL

Special keying systems KA-MK-GMK-CL
For a high security level MK system: 50.000 possible combinations

DESIGNED AND CERTIFIED ACCORDING TO EUROPEAN STANDARD

UNI EN 1303:15 - BS EN 1303:15 - ICIM 0039CS							
1	6	0	A	0	C	6	D

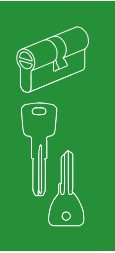

CATEGORY OF USE

1= for use by people with a high incentive to exercise care and with a small chance of misuse



DURABILITY

6 = 100.000 test cycles



DOOR MASS

0 = no door mass requirement



SUITABLE FOR USE ON FIRE RESISTANT/SMOKE CONTROL DOORS

A = suitable for use on smoke control doors



SAFETY

0 = no safety requirement



CORROSION RESISTANCE AND TEMPERATURE

C = high corrosion resistance; temperature requirement: from -25°C to +65°C



KEY RELATED SECURITY

6 = over 300.000 combinations



ATTACK RESISTANCE

D = resistance to drilling for 5/10 minutes, mechanical attack and plug extraction

DOUBLE CYLINDER

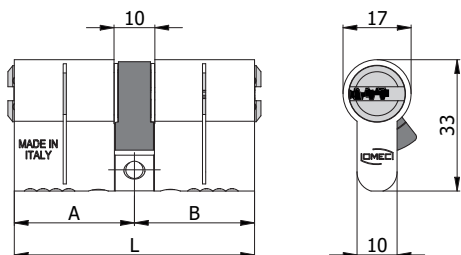

CONSTRUCTIVE FEATURES:

High resistance aluminium body with anti-drill pins and controlled snap cut - Stainless steel tear resistant connection bar - Tear resistant steel fixing screws - Easy entrance key nickel-plated brass plugs with anti-drill pins - Stainless steel pins and drivers - Stainless steel springs - Self-lubricating steel off center 30° DIN cam - Silver nickel reversible flat keys with code number.

For cylinders longer than 65 mm: Brass spacers and pins for plug - Sintered steel spacers for cylinder body.

WORKING:

Turn the key 360° - The keys are dependent and cannot operate on the cylinder if on the other side the key was inserted and turned.

PROVIDED WITH:

5 keys, registration card.

ON REQUEST:

Special keying systems KA-MK-GMK-CL.

COD.	L	A	B	Pin	Key	kg	Box	Box
320M.30.30.5	60	30	30	8	2020/08	0,20	1	5
320M.30.35.5	65	30	35	8	2020/08	0,21	1	5
320M.30.40.5	70	30	40	8	2020/08	0,23	1	5
320M.35.35.5	70	35	35	8	2020/08	0,23	1	5
320M.30.45.5	75	30	45	8	2020/08	0,24	1	5
320M.35.40.5	75	35	40	8	2020/08	0,24	1	5
320M.30.50.5	80	30	50	8	2020/08	0,25	1	5
320M.35.45.5	80	35	45	8	2020/08	0,25	1	5
320M.40.40.5	80	40	40	8	2020/08	0,25	1	5
320M.30.55.5	85	30	55	8	2020/08	0,26	1	5
320M.35.50.5	85	35	50	8	2020/08	0,26	1	5
320M.40.45.5	85	40	45	8	2020/08	0,26	1	5
320M.30.60.5	90	30	60	8	2020/08	0,28	1	5
320M.35.55.5	90	35	55	8	2020/08	0,28	1	5
320M.40.50.5	90	40	50	8	2020/08	0,28	1	5
320M.45.45.5	90	45	45	8	2020/08	0,28	1	5
320M.30.65.5	95	30	65	8	2020/08	0,29	1	5
320M.35.60.5	95	35	60	8	2020/08	0,29	1	5
320M.40.55.5	95	40	55	8	2020/08	0,29	1	5
320M.45.50.5	95	45	50	8	2020/08	0,29	1	5
320M.30.70.5	100	30	70	8	2020/08	0,30	1	5
320M.35.65.5	100	35	65	8	2020/08	0,30	1	5
320M.40.60.5	100	40	60	8	2020/08	0,30	1	5
320M.45.55.5	100	45	55	8	2020/08	0,30	1	5
320M.50.50.5	100	50	50	8	2020/08	0,30	1	5
320M.30.75.5	105	30	75	8	2020/08	0,32	1	5
320M.45.60.5	105	45	60	8	2020/08	0,32	1	5
320M.30.80.5	110	30	80	8	2020/08	0,33	1	5
320M.40.70.5	110	40	70	8	2020/08	0,33	1	5
320M.50.60.5	110	50	60	8	2020/08	0,33	1	5
320M.55.55.5	110	55	55	8	2020/08	0,33	1	5
320M.50.65.5	115	50	65	8	2020/08	0,35	1	5
320M.30.90.5	120	30	90	8	2020/08	0,35	1	5
320M.40.80.5	120	40	80	8	2020/08	0,35	1	5
320M.50.70.5	120	50	70	8	2020/08	0,35	1	5
320M.60.60.5	120	60	60	8	2020/08	0,35	1	5
320M.**.**.N.5								Black finish

OTHER SIZES AVAILABLE ON REQUEST

DOUBLE CYLINDER WITH TEMPORARY KEY

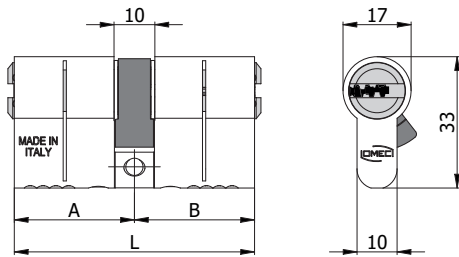

CONSTRUCTIVE FEATURES:

High resistance aluminium body with anti-drill pins and controlled snap cut - Stainless steel tear resistant connection bar - Tear resistant steel fixing screws - Easy entrance key nickel-plated brass plugs with anti-drill pins - Stainless steel pins and drivers - Stainless steel springs - Self-lubricating steel off center 30° DIN cam - Silver nickel reversible flat keys with code number - Brass temporary key with code number.

For cylinders longer than 65 mm: Brass spacers and pins for plug - Sintered steel spacers for cylinder body.

WORKING:

Turn the key 360° - The keys are dependent and cannot operate on the cylinder if on the other side the key was inserted and turned.

PROVIDED WITH:

5 keys, 1 temporary key, registration card.

ON REQUEST:

Special keying systems KA-MK-GMK-CL.

COD.	L	A	B	Pin	Key	Weight	kg	Box	Box
320M.30.30.5.TK	60	30	30	8	2020/08	0,22	1	5	
320M.30.35.5.TK	65	30	35	8	2020/08	0,23	1	5	
320M.30.40.5.TK	70	30	40	8	2020/08	0,25	1	5	
320M.35.35.5.TK	70	35	35	8	2020/08	0,25	1	5	
320M.30.45.5.TK	75	30	45	8	2020/08	0,26	1	5	
320M.35.40.5.TK	75	35	40	8	2020/08	0,26	1	5	
320M.30.50.5.TK	80	30	50	8	2020/08	0,27	1	5	
320M.35.45.5.TK	80	35	45	8	2020/08	0,27	1	5	
320M.40.40.5.TK	80	40	40	8	2020/08	0,27	1	5	
320M.30.55.5.TK	85	30	55	8	2020/08	0,28	1	5	
320M.35.50.5.TK	85	35	50	8	2020/08	0,28	1	5	
320M.40.45.5.TK	85	40	45	8	2020/08	0,28	1	5	
320M.30.60.5.TK	90	30	60	8	2020/08	0,30	1	5	
320M.35.55.5.TK	90	35	55	8	2020/08	0,30	1	5	
320M.40.50.5.TK	90	40	50	8	2020/08	0,30	1	5	
320M.45.45.5.TK	90	45	45	8	2020/08	0,30	1	5	
320M.30.65.5.TK	95	30	65	8	2020/08	0,31	1	5	
320M.35.60.5.TK	95	35	60	8	2020/08	0,31	1	5	
320M.40.55.5.TK	95	40	55	8	2020/08	0,31	1	5	
320M.45.50.5.TK	95	45	50	8	2020/08	0,31	1	5	
320M.30.70.5.TK	100	30	70	8	2020/08	0,32	1	5	
320M.35.65.5.TK	100	35	65	8	2020/08	0,32	1	5	
320M.40.60.5.TK	100	40	60	8	2020/08	0,32	1	5	
320M.45.55.5.TK	100	45	55	8	2020/08	0,32	1	5	
320M.50.50.5.TK	100	50	50	8	2020/08	0,32	1	5	
320M.30.75.5.TK	105	30	75	8	2020/08	0,34	1	5	
320M.45.60.5.TK	105	45	60	8	2020/08	0,34	1	5	
320M.30.80.5.TK	110	30	80	8	2020/08	0,35	1	5	
320M.40.70.5.TK	110	40	70	8	2020/08	0,35	1	5	
320M.50.60.5.TK	110	50	60	8	2020/08	0,35	1	5	
320M.55.55.5.TK	110	55	55	8	2020/08	0,35	1	5	
320M.50.65.5.TK	115	50	65	8	2020/08	0,36	1	5	
320M.30.90.5.TK	120	30	90	8	2020/08	0,37	1	5	
320M.40.80.5.TK	120	40	80	8	2020/08	0,37	1	5	
320M.50.70.5.TK	120	50	70	8	2020/08	0,37	1	5	
320M.60.60.5.TK	120	60	60	8	2020/08	0,37	1	5	
320M.**.**.N.5.TK									Black finish

OTHER SIZES AVAILABLE ON REQUEST

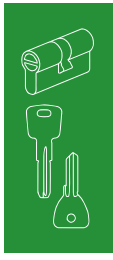
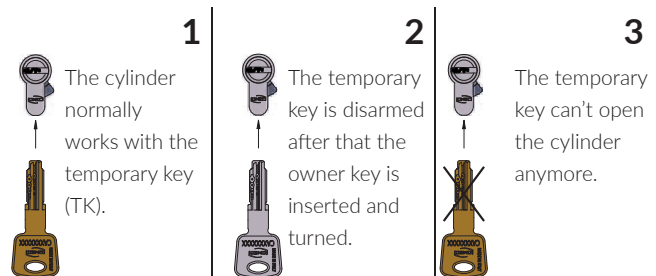

HALF CYLINDER



CONSTRUCTIVE FEATURES:

High resistance aluminium body with anti-drill pins and controlled snap cut - Stainless steel tear resistant connection bar - Tear resistant steel fixing screws - Easy entrance key nickel-plated brass plug with anti-drill pins - Stainless steel pins and drivers - Stainless steel springs - Self-lubricating steel off center 30° DIN cam - Silver nickel reversible flat keys with code number.

For cylinders longer than 48 mm: Brass spacers and pins for plug - Sintered steel spacers for cylinder body.

WORKING:

Turn the key 360°.

PROVIDED WITH:

5 keys, registration card.

ON REQUEST:

Special keying systems KA-MK-GMK-CL.

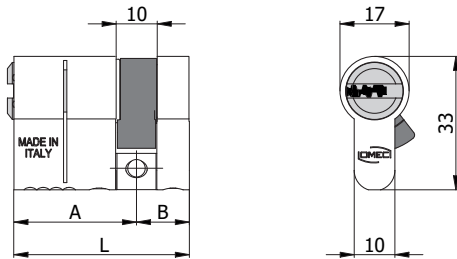

COD.	L	A	B					
321M.30.13.5	43	30	13	8	2020/08	0,17	1	5
321M.35.13.5	48	35	13	8	2020/08	0,18	1	5
321M.40.13.5	53	40	13	8	2020/08	0,19	1	5
321M.45.13.5	58	45	13	8	2020/08	0,20	1	5
321M.50.13.5	63	50	13	8	2020/08	0,22	1	5
321M.55.13.5	68	55	13	8	2020/08	0,23	1	5
321M.60.13.5	73	60	13	8	2020/08	0,24	1	5
321M.65.13.5	78	65	13	8	2020/08	0,25	1	5
321M.70.13.5	83	70	13	8	2020/08	0,27	1	5
321M.80.13.5	93	80	13	8	2020/08	0,28	1	5
321M.**.13.N.5	Black finish							

OTHER SIZES AVAILABLE ON REQUEST

HALF CYLINDER WITH TEMPORARY KEY



CONSTRUCTIVE FEATURES:

High resistance aluminium body with anti-drill pins and controlled snap cut - Stainless steel tear resistant connection bar - Tear resistant steel fixing screws - Easy entrance key nickel-plated brass plug with anti-drill pins - Stainless steel pins and drivers - Stainless steel springs - Self-lubricating steel off center 30° DIN cam - Silver nickel reversible flat keys with code number - Brass temporary key with code number.

For cylinders longer than 48 mm: Brass spacers and pins for plug - Sintered steel spacers for cylinder body.

WORKING:

Turn the key 360°.

PROVIDED WITH:

5 keys, 1 temporary key, registration card.

ON REQUEST:

Special keying systems KA-MK-GMK-CL.

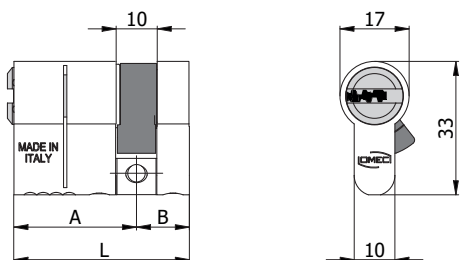

COD.	L	A	B	Pin	Key	kg	Box	Box
321M.30.13.5.TK	43	30	13	8	2020/08	0,19	1	5
321M.35.13.5.TK	48	35	13	8	2020/08	0,20	1	5
321M.40.13.5.TK	53	40	13	8	2020/08	0,21	1	5
321M.45.13.5.TK	58	45	13	8	2020/08	0,22	1	5
321M.50.13.5.TK	63	50	13	8	2020/08	0,24	1	5
321M.55.13.5.TK	68	55	13	8	2020/08	0,25	1	5
321M.60.13.5.TK	73	60	13	8	2020/08	0,26	1	5
321M.65.13.5.TK	78	65	13	8	2020/08	0,27	1	5
321M.70.13.5.TK	83	70	13	8	2020/08	0,29	1	5
321M.80.13.5.TK	93	80	13	8	2020/08	0,30	1	5
321M.**.13.N.5.TK								

Black finish

OTHER SIZES AVAILABLE ON REQUEST

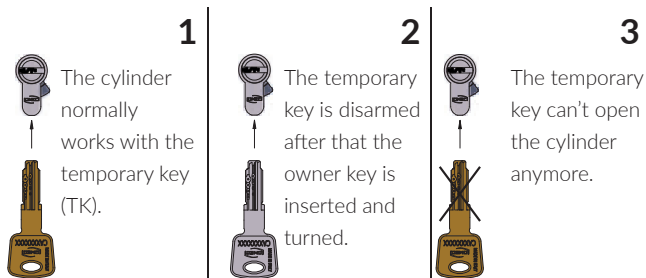

CLUTCHING DOUBLE CYLINDER

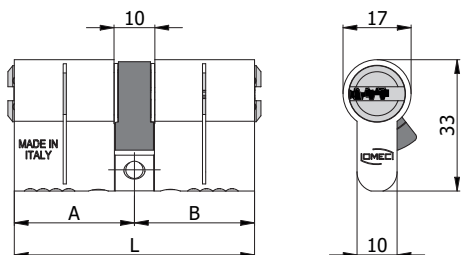

CONSTRUCTIVE FEATURES:

High resistance aluminium body with anti-drill pins and controlled snap cut - Stainless steel tear resistant connection bar - Tear resistant steel fixing screws - Easy entrance key nickel-plated brass plugs with anti-drill pins - Stainless steel pins and drivers - Stainless steel springs - Self-lubricating steel off center 30° DIN cam - Silver nickel reversible flat keys with code number.

For cylinders longer than 65 mm: Brass spacers and pins for plug - Sintered steel spacers for cylinder body.

WORKING:

Turn the key 360° - The keys are independent and can operate on the cylinder even if on the other side the key was inserted and turned.

PROVIDED WITH:

5 keys, registration card.

ON REQUEST:

Special keying systems KA-MK-GMK-CL.

COD.	L	A	B	Pin	Key	kg	Box	Box
322M.30.30.5	60	30	30	8	2020/08	0,20	1	5
322M.30.35.5	65	30	35	8	2020/08	0,21	1	5
322M.30.40.5	70	30	40	8	2020/08	0,22	1	5
322M.35.35.5	70	35	35	8	2020/08	0,22	1	5
322M.30.45.5	75	30	45	8	2020/08	0,24	1	5
322M.35.40.5	75	35	40	8	2020/08	0,24	1	5
322M.30.50.5	80	30	50	8	2020/08	0,25	1	5
322M.35.45.5	80	35	45	8	2020/08	0,25	1	5
322M.40.40.5	80	40	40	8	2020/08	0,25	1	5
322M.30.55.5	85	30	55	8	2020/08	0,26	1	5
322M.35.50.5	85	35	50	8	2020/08	0,26	1	5
322M.40.45.5	85	40	45	8	2020/08	0,26	1	5
322M.30.60.5	90	30	60	8	2020/08	0,28	1	5
322M.35.55.5	90	35	55	8	2020/08	0,28	1	5
322M.40.50.5	90	40	50	8	2020/08	0,28	1	5
322M.45.45.5	90	45	45	8	2020/08	0,28	1	5
322M.30.65.5	95	30	65	8	2020/08	0,29	1	5
322M.35.60.5	95	35	60	8	2020/08	0,29	1	5
322M.40.55.5	95	40	55	8	2020/08	0,29	1	5
322M.45.50.5	95	45	50	8	2020/08	0,29	1	5
322M.30.70.5	100	30	70	8	2020/08	0,30	1	5
322M.35.65.5	100	35	65	8	2020/08	0,30	1	5
322M.40.60.5	100	40	60	8	2020/08	0,30	1	5
322M.45.55.5	100	45	55	8	2020/08	0,30	1	5
322M.50.50.5	100	50	50	8	2020/08	0,30	1	5
322M.30.75.5	105	30	75	8	2020/08	0,31	1	5
322M.45.60.5	105	45	60	8	2020/08	0,31	1	5
322M.30.80.5	110	30	80	8	2020/08	0,33	1	5
322M.40.70.5	110	40	70	8	2020/08	0,33	1	5
322M.50.60.5	110	50	60	8	2020/08	0,33	1	5
322M.55.55.5	110	55	55	8	2020/08	0,33	1	5
322M.50.65.5	115	50	65	8	2020/08	0,34	1	5
322M.30.90.5	120	30	90	8	2020/08	0,35	1	5
322M.40.80.5	120	40	80	8	2020/08	0,35	1	5
322M.50.70.5	120	50	70	8	2020/08	0,35	1	5
322M.60.60.5	120	60	60	8	2020/08	0,35	1	5
322M.**.**.N.5								

Black finish

OTHER SIZES AVAILABLE ON REQUEST

CLUTCHING DOUBLE CYLINDER WITH TEMPORARY KEY

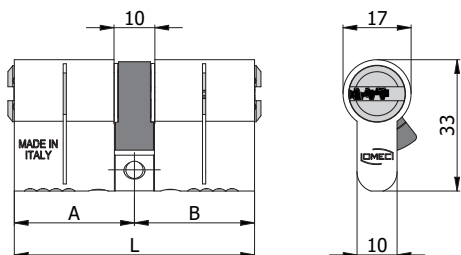

COD.	L	A	B	Ø	Key	Weight (kg)	Spacers	Pins
322M.30.30.5.TK	60	30	30	8	2020/08	0,22	1	5
322M.30.35.5.TK	65	30	35	8	2020/08	0,23	1	5
322M.30.40.5.TK	70	30	40	8	2020/08	0,24	1	5
322M.35.35.5.TK	70	35	35	8	2020/08	0,24	1	5
322M.30.45.5.TK	75	30	45	8	2020/08	0,26	1	5
322M.35.40.5.TK	75	35	40	8	2020/08	0,26	1	5
322M.30.50.5.TK	80	30	50	8	2020/08	0,27	1	5
322M.35.45.5.TK	80	35	45	8	2020/08	0,27	1	5
322M.40.40.5.TK	80	40	40	8	2020/08	0,27	1	5
322M.30.55.5.TK	85	30	55	8	2020/08	0,28	1	5
322M.35.50.5.TK	85	35	50	8	2020/08	0,28	1	5
322M.40.45.5.TK	85	40	45	8	2020/08	0,28	1	5
322M.30.60.5.TK	90	30	60	8	2020/08	0,30	1	5
322M.35.55.5.TK	90	35	55	8	2020/08	0,30	1	5
322M.40.50.5.TK	90	40	50	8	2020/08	0,30	1	5
322M.45.45.5.TK	90	45	45	8	2020/08	0,30	1	5
322M.30.65.5.TK	95	30	65	8	2020/08	0,31	1	5
322M.35.60.5.TK	95	35	60	8	2020/08	0,31	1	5
322M.40.55.5.TK	95	40	55	8	2020/08	0,31	1	5
322M.45.50.5.TK	95	45	50	8	2020/08	0,31	1	5
322M.30.70.5.TK	100	30	70	8	2020/08	0,32	1	5
322M.35.65.5.TK	100	35	65	8	2020/08	0,32	1	5
322M.40.60.5.TK	100	40	60	8	2020/08	0,32	1	5
322M.45.55.5.TK	100	45	55	8	2020/08	0,32	1	5
322M.50.50.5.TK	100	50	50	8	2020/08	0,32	1	5
322M.30.75.5.TK	105	30	75	8	2020/08	0,33	1	5
322M.45.60.5.TK	105	45	60	8	2020/08	0,33	1	5
322M.30.80.5.TK	110	30	80	8	2020/08	0,35	1	5
322M.40.70.5.TK	110	40	70	8	2020/08	0,35	1	5
322M.50.60.5.TK	110	50	60	8	2020/08	0,35	1	5
322M.55.55.5.TK	110	55	55	8	2020/08	0,35	1	5
322M.50.65.5.TK	115	50	65	8	2020/08	0,36	1	5
322M.30.90.5.TK	120	30	90	8	2020/08	0,37	1	5
322M.40.80.5.TK	120	40	80	8	2020/08	0,37	1	5
322M.50.70.5.TK	120	50	70	8	2020/08	0,37	1	5
322M.60.60.5.TK	120	60	60	8	2020/08	0,37	1	5
322M.**.**.N.5.TK								Black finish

CONSTRUCTIVE FEATURES:

High resistance aluminium body with anti-drill pins and controlled snap cut - Stainless steel tear resistant connection bar - Tear resistant steel fixing screws - Easy entrance key nickel-plated brass plugs with anti-drill pins - Stainless steel pins and drivers - Stainless steel springs - Self-lubricating steel off center 30° DIN cam - Silver nickel reversible flat keys with code number - Brass temporary key with code number.

For cylinders longer than 65 mm: Brass spacers and pins for plug - Sintered steel spacers for cylinder body.

WORKING:

Turn the key 360° - The keys are independent and can operate on the cylinder even if on the other side the key was inserted and turned.

PROVIDED WITH:

5 keys, 1 temporary key, registration card.

ON REQUEST:

Special keying systems KA-MK-GMK-CL.

OTHER SIZES AVAILABLE ON REQUEST

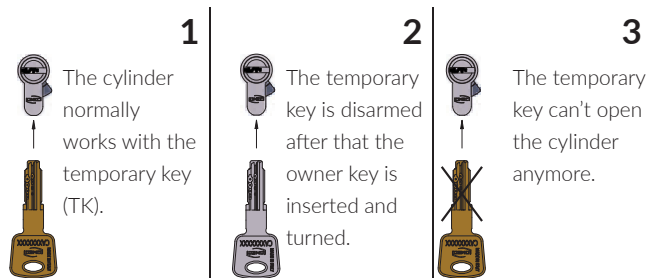

DOUBLE CYLINDER WITH KNOB

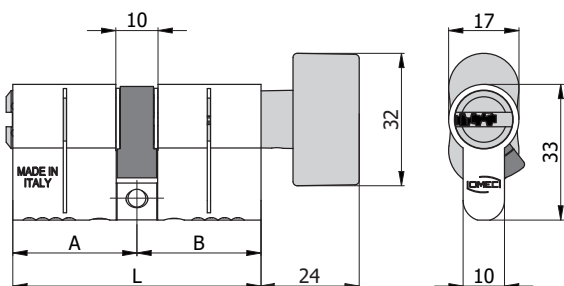

CONSTRUCTIVE FEATURES:

High resistance aluminium body with anti-drill pins and controlled snap cut - Stainless steel tear resistant connection bar - Tear resistant steel fixing screws - Easy entrance key nickel-plated brass plug with anti-drill pins - Stainless steel pins and drivers - Stainless steel springs - Self-lubricating steel off center 30° DIN cam - Satin nickel-plated special alloy knob - Silver nickel reversible flat keys with code number.

For cylinders longer than 65 mm: Brass spacers and pins for plug - Sintered steel spacers for cylinder body.

WORKING:

Turn the key or knob 360°.

PROVIDED WITH:

5 keys, registration card.

ON REQUEST:

Special keying systems KA-MK-GMK-CL.

COD.	L	A	B	Pin	Key	kg	Box	Box
323M.30.30B.5	60	30	30	8	2020/08	0,24	1	5
323M.30.35B.5	65	30	35	8	2020/08	0,26	1	5
323M.35.30B.5	65	35	30	8	2020/08	0,26	1	5
323M.30.40B.5	70	30	40	8	2020/08	0,27	1	5
323M.35.35B.5	70	35	35	8	2020/08	0,27	1	5
323M.40.30B.5	70	40	30	8	2020/08	0,27	1	5
323M.30.45B.5	75	30	45	8	2020/08	0,28	1	5
323M.35.40B.5	75	35	40	8	2020/08	0,28	1	5
323M.40.35B.5	75	40	35	8	2020/08	0,28	1	5
323M.45.30B.5	75	45	30	8	2020/08	0,28	1	5
323M.30.50B.5	80	30	50	8	2020/08	0,30	1	5
323M.35.45B.5	80	35	45	8	2020/08	0,30	1	5
323M.40.40B.5	80	40	40	8	2020/08	0,30	1	5
323M.45.35B.5	80	45	35	8	2020/08	0,30	1	5
323M.50.30B.5	80	50	30	8	2020/08	0,30	1	5
323M.35.50B.5	85	35	50	8	2020/08	0,31	1	5
323M.40.45B.5	85	40	45	8	2020/08	0,31	1	5
323M.45.40B.5	85	45	40	8	2020/08	0,31	1	5
323M.50.35B.5	85	50	35	8	2020/08	0,31	1	5
323M.30.60B.5	90	30	60	8	2020/08	0,32	1	5
323M.40.50B.5	90	40	50	8	2020/08	0,32	1	5
323M.45.45B.5	90	45	45	8	2020/08	0,32	1	5
323M.50.40B.5	90	50	40	8	2020/08	0,32	1	5
323M.60.30B.5	90	60	30	8	2020/08	0,32	1	5
323M.60.35B.5	95	60	35	8	2020/08	0,33	1	5
323M.30.70B.5	100	30	70	8	2020/08	0,35	1	5
323M.40.60B.5	100	40	60	8	2020/08	0,35	1	5
323M.50.50B.5	100	50	50	8	2020/08	0,35	1	5
323M.60.40B.5	100	60	40	8	2020/08	0,35	1	5
323M.70.30B.5	100	70	30	8	2020/08	0,35	1	5
323M.30.80B.5	110	30	80	8	2020/08	0,36	1	5
323M.40.70B.5	110	40	70	8	2020/08	0,36	1	5
323M.50.60B.5	110	50	60	8	2020/08	0,36	1	5
323M.60.50B.5	110	60	50	8	2020/08	0,36	1	5
323M.40.80B.5	120	40	80	8	2020/08	0,37	1	5
323M.60.60B.5	120	60	60	8	2020/08	0,37	1	5
323M.**.**B.N.5								Black finish

OTHER SIZES AVAILABLE ON REQUEST

DOUBLE CYLINDER WITH KNOB WITH TEMPORARY KEY

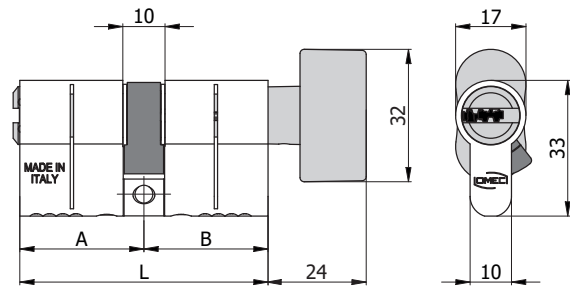

CONSTRUCTIVE FEATURES:

High resistance aluminium body with anti-drill pins and controlled snap cut - Stainless steel tear resistant connection bar - Tear resistant steel fixing screws - Easy entrance key nickel-plated brass plug with anti-drill pins - Stainless steel pins and drivers - Stainless steel springs - Self-lubricating steel off center 30° DIN cam - Satin nickel-plated special alloy knob - Silver nickel reversible flat keys with code number - Brass temporary key with code number.

For cylinders longer than 65 mm: Brass spacers and pins for plug - Sintered steel spacers for cylinder body.

WORKING:

Turn the key or knob 360°.

PROVIDED WITH:

5 keys, 1 temporary key, registration card.

ON REQUEST:

Special keying systems KA-MK-GMK-CL.

COD.	L	A	B	Pin	Key	kg	Box	Box
323M.30.30B.5.TK	60	30	30	8	2020/08	0,26	1	5
323M.30.35B.5.TK	65	30	35	8	2020/08	0,28	1	5
323M.35.30B.5.TK	65	35	30	8	2020/08	0,28	1	5
323M.30.40B.5.TK	70	30	40	8	2020/08	0,29	1	5
323M.35.35B.5.TK	70	35	35	8	2020/08	0,29	1	5
323M.40.30B.5.TK	70	40	30	8	2020/08	0,29	1	5
323M.30.45B.5.TK	75	30	45	8	2020/08	0,30	1	5
323M.35.40B.5.TK	75	35	40	8	2020/08	0,30	1	5
323M.40.35B.5.TK	75	40	35	8	2020/08	0,30	1	5
323M.45.30B.5.TK	75	45	30	8	2020/08	0,30	1	5
323M.30.50B.5.TK	80	30	50	8	2020/08	0,32	1	5
323M.35.45B.5.TK	80	35	45	8	2020/08	0,32	1	5
323M.40.40B.5.TK	80	40	40	8	2020/08	0,32	1	5
323M.45.35B.5.TK	80	45	35	8	2020/08	0,32	1	5
323M.50.30B.5.TK	80	50	30	8	2020/08	0,32	1	5
323M.35.50B.5.TK	85	35	50	8	2020/08	0,33	1	5
323M.40.45B.5.TK	85	40	45	8	2020/08	0,33	1	5
323M.45.40B.5.TK	85	45	40	8	2020/08	0,33	1	5
323M.50.35B.5.TK	85	50	35	8	2020/08	0,33	1	5
323M.30.60B.5.TK	90	30	60	8	2020/08	0,34	1	5
323M.40.50B.5.TK	90	40	50	8	2020/08	0,34	1	5
323M.45.45B.5.TK	90	45	45	8	2020/08	0,34	1	5
323M.50.40B.5.TK	90	50	40	8	2020/08	0,34	1	5
323M.60.30B.5.TK	90	60	30	8	2020/08	0,34	1	5
323M.60.35B.5.TK	95	60	35	8	2020/08	0,35	1	5
323M.30.70B.5.TK	100	30	70	8	2020/08	0,37	1	5
323M.40.60B.5.TK	100	40	60	8	2020/08	0,37	1	5
323M.50.50B.5.TK	100	50	50	8	2020/08	0,37	1	5
323M.60.40B.5.TK	100	60	40	8	2020/08	0,37	1	5
323M.70.30B.5.TK	100	70	30	8	2020/08	0,37	1	5
323M.30.80B.5.TK	110	30	80	8	2020/08	0,38	1	5
323M.40.70B.5.TK	110	40	70	8	2020/08	0,38	1	5
323M.50.60B.5.TK	110	50	60	8	2020/08	0,38	1	5
323M.60.50B.5.TK	110	60	50	8	2020/08	0,38	1	5
323M.40.80B.5.TK	120	40	80	8	2020/08	0,39	1	5
323M.60.60B.5.TK	120	60	60	8	2020/08	0,39	1	5
323M.**.**B.N.5.TK								

Black finish

OTHER SIZES AVAILABLE ON REQUEST

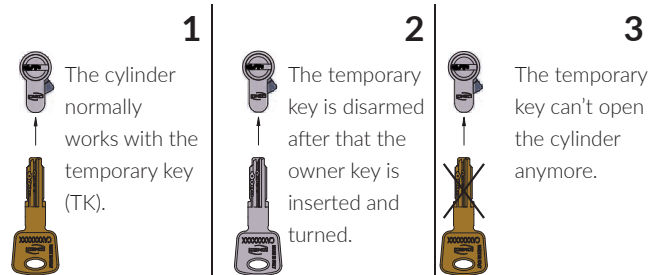

HALF CYLINDER WITH KNOB

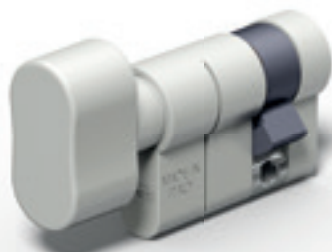

CONSTRUCTIVE FEATURES:

High resistance aluminium body with anti-drill pins and controlled snap cut - Stainless steel tear resistant connection bar - Tear resistant steel fixing screws - Self-lubricating steel off center 30° DIN cam - Satin nickel-plated special alloy knob.

For cylinders longer than 48 mm: Brass spacers and pins for plug - Sintered steel spacers for cylinder body.

WORKING:

Turn the knob 360°.

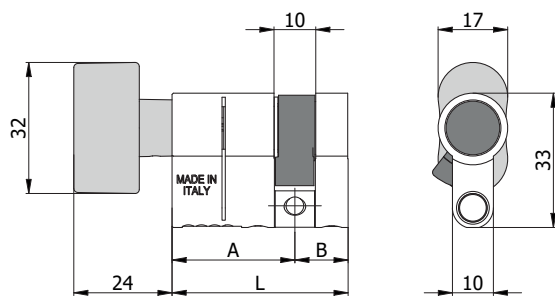

COD.	L	A	B	kg	Box	Box
324M.30.13	43	30	13	0,21	1	5
324M.35.13	48	35	13	0,22	1	5
324M.40.13	53	40	13	0,23	1	5
324M.45.13	58	45	13	0,25	1	5
324M.50.13	63	50	13	0,26	1	5
324M.55.13	68	55	13	0,27	1	5
324M.60.13	73	60	13	0,28	1	5
324M.65.13	78	65	13	0,30	1	5
324M.70.13	83	70	13	0,31	1	5
324M.80.13	93	80	13	0,32	1	5
324M.**.13.N	Black finish					

OTHER SIZES AVAILABLE ON REQUEST



DOUBLE CYLINDER WITH SHANK



CONSTRUCTIVE FEATURES:

High resistance aluminium body with anti-drill pins and controlled snap cut - Stainless steel tear resistant connection bar - Tear resistant steel fixing screws - Easy entrance key nickel-plated brass plug with anti-drill pins - Stainless steel pins and drivers - Stainless steel springs - Self-lubricating steel off center 30° DIN cam - Brass shank - Silver nickel reversible flat keys with code number.

For cylinders longer than 65 mm: Brass spacers and pins for plug - Sintered steel spacers for cylinder body.

WORKING:

Turn the key or knob 360°.

PROVIDED WITH:

5 keys, registration card.

ON REQUEST:

Special keying systems KA-MK-GMK-CL.

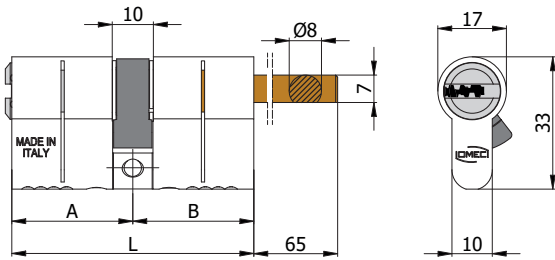

COD.	L	A	B	Pin	Key	kg	Box	Box
326M.30.30G.5	60	30	30	8	2020/08	0,22	1	5
326M.35.30G.5	65	35	30	8	2020/08	0,24	1	5
326M.40.30G.5	70	40	30	8	2020/08	0,25	1	5
326M.45.30G.5	75	45	30	8	2020/08	0,26	1	5
326M.50.30G.5	80	50	30	8	2020/08	0,27	1	5
326M.55.30G.5	85	55	30	8	2020/08	0,29	1	5
326M.60.30G.5	90	60	30	8	2020/08	0,30	1	5
326M.70.30G.5	100	70	30	8	2020/08	0,33	1	5
326M.**.30G.N.5								

Black finish

OTHER SIZES AVAILABLE ON REQUEST

DOUBLE CYLINDER WITH SHANK WITH TEMPORARY KEY



CONSTRUCTIVE FEATURES:

High resistance aluminium body with anti-drill pins and controlled snap cut - Stainless steel tear resistant connection bar - Tear resistant steel fixing screws - Easy entrance key nickel-plated brass plug with anti-drill pins - Stainless steel pins and drivers - Stainless steel springs - Self-lubricating steel off center 30° DIN cam - Brass shank - Silver nickel reversible flat keys with code number - Brass temporary key with code number.

For cylinders longer than 65 mm: Brass spacers and pins for plug - Sintered steel spacers for cylinder body.

WORKING:

Turn the key or knob 360°.

PROVIDED WITH:

5 keys, 1 temporary key, registration card.

ON REQUEST:

Special keying systems KA-MK-GMK-CL.

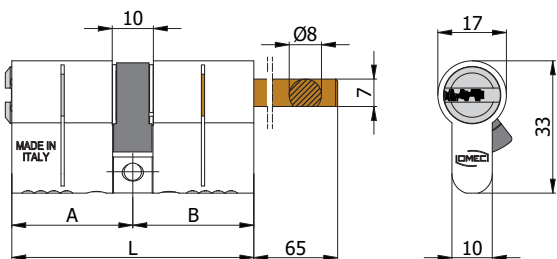
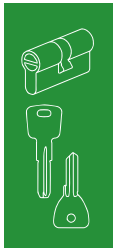

COD.	L	A	B	10	Ø8	17	33	7	65
326M.30.30G.5.TK	60	30	30	8	2020/08	0,24	1	5	
326M.35.30G.5.TK	65	35	30	8	2020/08	0,26	1	5	
326M.40.30G.5.TK	70	40	30	8	2020/08	0,27	1	5	
326M.45.30G.5.TK	75	45	30	8	2020/08	0,28	1	5	
326M.50.30G.5.TK	80	50	30	8	2020/08	0,29	1	5	
326M.55.30G.5.TK	85	55	30	8	2020/08	0,31	1	5	
326M.60.30G.5.TK	90	60	30	8	2020/08	0,32	1	5	
326M.70.30G.5.TK	100	70	30	8	2020/08	0,35	1	5	
326M.**.30G.N.5.TK					Black finish				

OTHER SIZES AVAILABLE ON REQUEST

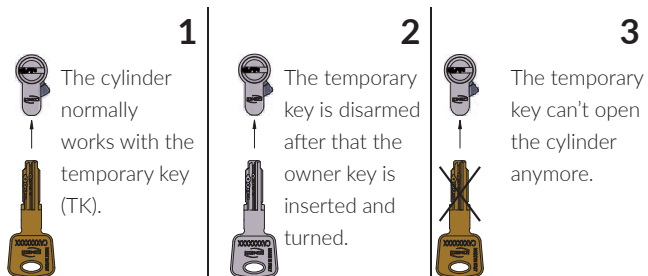

PAIR OF MODULES FOR CYLINDERS



CONSTRUCTIVE FEATURES:

High resistance aluminium bodies with anti-drill pins and controlled snap cut - Easy entrance key nickel-plated brass plugs with anti-drill pins - Stainless steel pins and drivers - Stainless steel springs - Silver nickel reversible flat keys with code number.

WORKING:

Turn the key 360° .

PROVIDED WITH:

5 keys, registration card.

ON REQUEST:

Special keying systems KA-MK-GMK-CL

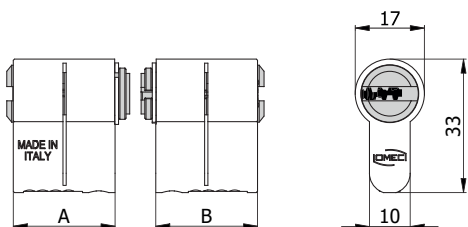

COD.	A	B					
320M.30.5	25	25	8	2020/08	0,18	1	5
320M.30.N.5	Black finish						

PAIR OF MODULES FOR CYLINDERS WITH TEMPORARY KEY



CONSTRUCTIVE FEATURES:

High resistance aluminium bodies with anti-drill pins and controlled snap cut - Easy entrance key nickel-plated brass plugs with anti-drill pins - Stainless steel pins and drivers - Stainless steel springs - Silver nickel reversible flat keys with code number - Brass temporary key with code number.

WORKING:

Turn the key 360°.

PROVIDED WITH:

5 keys, 1 temporary key, registration card.

ON REQUEST:

Special keying systems KA-MK-GMK-CL.

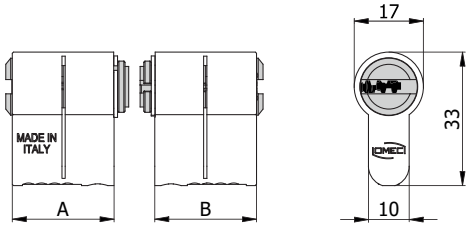
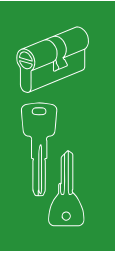

COD.	A	B					
320M.30.5.TK	25	25	8	2020/08	0,20	1	5
320M.30.N.5.TK	Black finish						

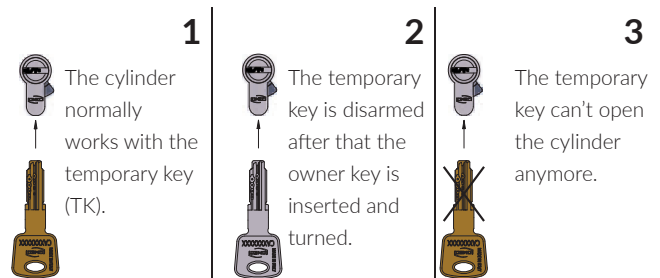

MODULE FOR CYLINDER



CONSTRUCTIVE FEATURES:

High resistance aluminium body with anti-drill pins and controlled snap cut - Easy entrance key nickel-plated brass plug with anti-drill pins - Stainless steel pins and drivers - Stainless steel springs - Silver nickel reversible flat keys with code number.

WORKING:

Turn the key 360°.

PROVIDED WITH:

5 keys, registration card.

ON REQUEST:

Special keying systems KA-MK-GMK-CL.

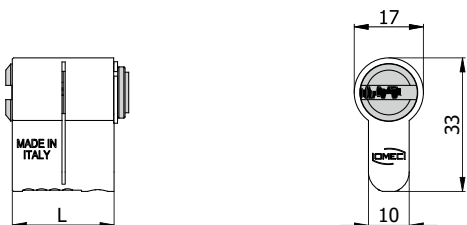

COD.	L					
321M.30.5	25	8	2020/08	0,14	1	5
321M.30.N.5	Black finish					

MODULE FOR CYLINDER WITH TEMPORARY KEY



CONSTRUCTIVE FEATURES:

High resistance aluminium body with anti-drill pins and controlled snap cut - Easy entrance key nickel-plated brass plug with anti-drill pins - Stainless steel pins and drivers - Stainless steel springs - Silver nickel reversible flat keys with code number - Brass temporary key with code number.

WORKING:

Turn the key 360°.

PROVIDED WITH:

5 keys, 1 temporary key, registration card.

ON REQUEST:

Special keying systems KA-MK-GMK-CL.

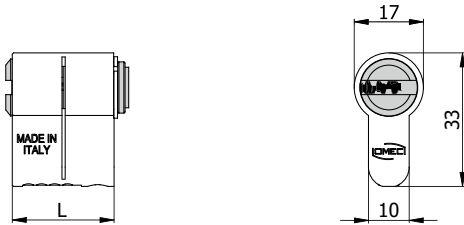
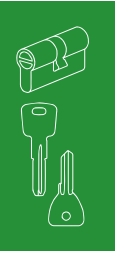

COD.	L					
321M.30.5.TK	25	8	2020/08	0,16	1	5
321M.30.N.5.TK	Black finish					

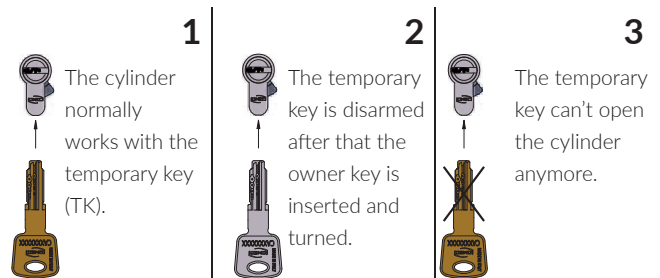

MODULE FOR CYLINDER WITH KNOB



CONSTRUCTIVE FEATURES:

High resistance aluminium body with controlled snap cut - Satin nickel-plated special alloy knob.

WORKING:

Turn the knob 360°.

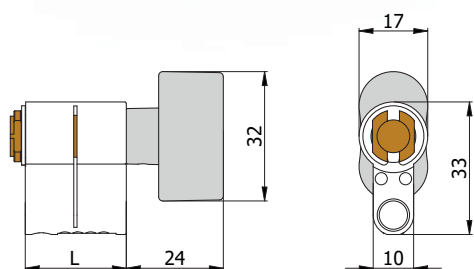

COD.	L	kg		
323M.30	25	0,08	1	5
323M.30.N	Black finish			

MODULE FOR CYLINDER WITH SHANK



CONSTRUCTIVE FEATURES:

High resistance aluminium body with controlled snap cut - Brass shank.

WORKING:

Turn the knob 360°.

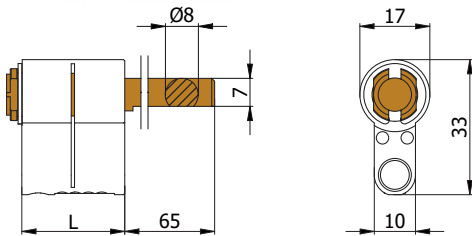

COD.	L	kg		
326M.30	25	0,06	1	5
326M.30.N			Black finish	

TEAR RESISTANT CONNECTION BAR

CONSTRUCTIVE FEATURES:

Stainless steel tear resistant bar.

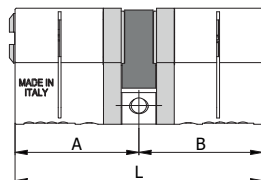

COD.	L cylinder	A	B			
PTC.30.30	60	30	30	0,008	10	-
PTC.30.35	65	30	35	0,009	10	-
PTC.30.40	70	30	40	0,010	10	-
PTC.35.35	70	35	35	0,010	10	-
PTC.30.45	75	30	45	0,012	10	-
PTC.35.40	75	35	40	0,012	10	-
PTC.30.50	80	30	50	0,013	10	-
PTC.35.45	80	35	45	0,013	10	-
PTC.40.40	80	40	40	0,013	10	-
PTC.30.55	85	30	55	0,015	10	-
PTC.35.50	85	35	50	0,015	10	-
PTC.40.45	85	40	45	0,015	10	-
PTC.30.60	90	30	60	0,016	10	-
PTC.35.55	90	35	55	0,016	10	-
PTC.40.50	90	40	50	0,016	10	-
PTC.45.45	90	45	45	0,016	10	-
PTC.30.65	95	30	65	0,018	10	-
PTC.35.60	95	35	60	0,018	10	-
PTC.40.55	95	40	55	0,018	10	-
PTC.45.50	95	45	50	0,018	10	-
PTC.30.70	100	30	70	0,019	10	-
PTC.35.65	100	35	65	0,019	10	-
PTC.40.60	100	40	60	0,019	10	-
PTC.45.55	100	45	55	0,019	10	-
PTC.50.50	100	50	50	0,019	10	-
PTC.30.75	105	30	75	0,021	10	-
PTC.45.60	105	45	60	0,021	10	-
PTC.30.80	110	30	80	0,022	10	-
PTC.40.70	110	40	70	0,022	10	-
PTC.50.60	110	50	60	0,022	10	-
PTC.55.55	110	55	55	0,022	10	-
PTC.50.65	115	50	65	0,023	10	-
PTC.30.90	120	30	90	0,025	10	-
PTC.40.80	120	40	80	0,025	10	-
PTC.50.70	120	50	70	0,025	10	-
PTC.60.60	120	60	60	0,025	10	-

TEAR RESISTANT UNIVERSAL CONNECTION BAR

CONSTRUCTIVE FEATURES:

Stainless steel tear resistant bar.

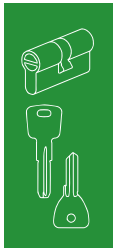
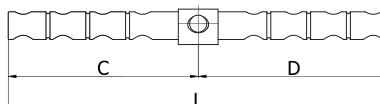
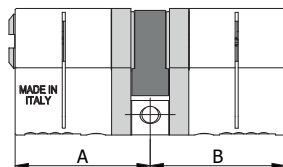

COD.	FOR CYLINDERS SIZE		L	C	D	kg	10	-
	A	B						
PTC180	35-45-55-65-75	35-45-55-65-75	115	58	58	0,021	10	-
PTC181	30-40-50-60-70	35-45-55-65-75	111	53	58	0,024	10	-
PTC182	30-40-50-60	30-40-50-60-70-80-90	116	43	73	0,027	10	-
PTC183	35-45-55	75-85-95	116	38	78	0,030	10	-
PTC184	30-40-50	75-85-95	111	33	78	0,029	10	-
PTC185	70-80-90-100	35-45	111	83	28	0,029	10	-

FIXING SCREW

CONSTRUCTIVE FEATURES:

Zinc-plated steel tear resistant fixing screw.



COD.	kg	250	-
VTS083	0,002	250	-

SPACER FOR CYLINDER

CONSTRUCTIVE FEATURES:

Sintered steel spacer.

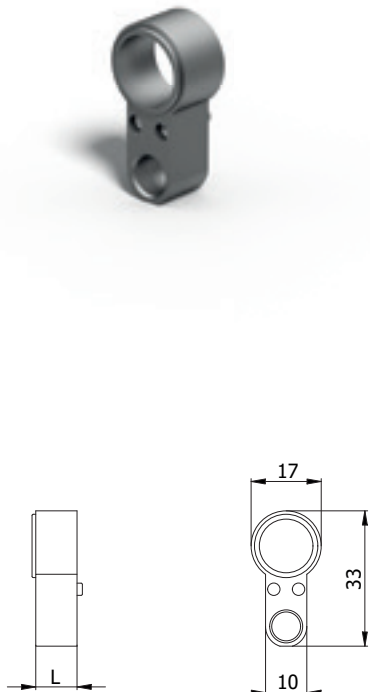

COD.	L	kg		
NGM087	5	0,006	10	-
NGM088	10	0,013	10	-
NGM089	15	0,019	10	-
NGM090	20	0,026	10	-

ADAPTER FOR HALF CYLINDER

CONSTRUCTIVE FEATURES:

Zinc-plated special alloy adapter.



For cylinders series 321M - 324M

COD.	kg		
CLH994	0,010	10	-

PLUG SPACER

CONSTRUCTIVE FEATURES:
Brass spacer.

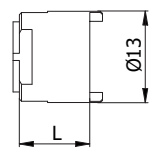
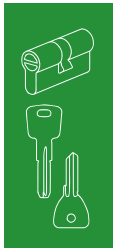

COD.	L	kg		
PTC003	5	0,003	10	-
PTC004	10	0,006	10	-
PTC005	15	0,010	10	-
PTC006	20	0,013	10	-

PIN SPACER

CONSTRUCTIVE FEATURES:
Brass pin.

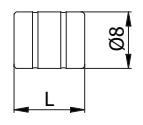

COD.	L	kg		
PRC098	5	0,002	10	-
PRC099	10	0,004	10	-
PRC100	15	0,006	10	-
PRC101	20	0,008	10	-

JOINT FOR DOUBLE CYLINDER

CONSTRUCTIVE FEATURES:

Self-lubricating steel joint, brass connection pin.



For cylinders series 320M

COD.	kg		
SND020	0,006	10	-

JOINT FOR CLUTCHING DOUBLE CYLINDER

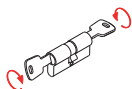

CONSTRUCTIVE FEATURES:

Self-lubricating steel joint, brass connection pin, stainless steel springs.



For cylinders series 322M

COD.	kg		
SND021	0,004	10	-

JOINT FOR DOUBLE CYLINDER WITH KNOB

CONSTRUCTIVE FEATURES:

Self-lubricating steel joint, brass connection pin, stainless steel springs.



For cylinders series 323M - 326M

COD.	kg		
SND022	0,005	10	-

CAM FOR DOUBLE CYLINDER



CONSTRUCTIVE FEATURES:

Self-lubricating steel off center 30° DIN cam.

For cylinders series 320M

COD.			
NSC010	0,007	50	-

CAM FOR HALF CYLINDER



CONSTRUCTIVE FEATURES:

Self-lubricating steel off center 30° DIN cam.

For cylinders series 321M - 324M

COD.			
NSC014	0,011	50	-

CAM FOR CLUTCHING DOUBLE CYLINDER

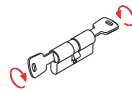

CONSTRUCTIVE FEATURES:

Self-lubricating steel off center 30° DIN cam.

For cylinders series 322M

COD.			
NSC009	0,007	50	-

CAM FOR DOUBLE CYLINDER WITH KNOB



CONSTRUCTIVE FEATURES:

Self-lubricating steel off center 30° DIN cam.

For cylinders series 323M - 326M

COD.			
NSC012	0,007	50	-

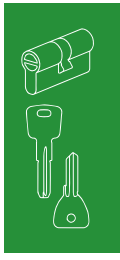

CASE WITH COMPONENTS FOR ASSEMBLING MODULAR CYLINDER



CONSTRUCTIVE FEATURES:

Abs case.

PROVIDED WITH:

See components list below.

COD.	L	H	P	kg	
VLG001	450	160	350	8,00	1

COD.	DESCRIPTION	
320M.30.5	Pair of modules for cylinder	5
321M.30.5	Module for cylinder	5
323M.30	Module for cylinder with knob	1
326M.30	Module for cylinder with shank	1
CLH994	Adapter for half cylinder	10
NGM087	Spacer for cylinder (5 mm)	10
NGM088	Spacer for cylinder (10 mm)	10
NGM089	Spacer for cylinder (15 mm)	10
NGM090	Spacer for cylinder (20 mm)	10
NSC009	Cam for double clutching cylinder	5
NSC010	Cam for double cylinder	5
NSC012	Cam for double cylinder with knob	5
NSC014	Cam for half cylinder	5
PRC098	Pin spacer (5 mm)	10
PRC099	Pin spacer (10 mm)	10
PRC100	Pin spacer (15 mm)	10
PRC101	Pin spacer (20 mm)	10
PTC003	Plug spacer (5 mm)	10
PTC004	Plug spacer (10 mm)	10
PTC005	Plug spacer (15 mm)	10
PTC006	Plug spacer (20 mm)	10
PTC180	Universal connection bar (L cylinder max 130 mm)	5
PTC181	Universal connection bar (L cylinder max 135 mm)	5
PTC182	Universal connection bar (L cylinder max 150 mm)	5
SND020	Joint for double cylinder	10
SND021	Joint for double clutching cylinder	10
SND022	Joint for double cylinder with knob	10
VTC004	Cylinder screw (47 mm)	10
VTC007	Cylinder screw (77 mm)	10
VTC011	Cylinder screw (117 mm)	10
VTS083	Fixing screw	250
CACCIAVITE TX8	Torx TX8 screwdriver	1

BRASS KNOB



CONSTRUCTIVE FEATURES:
Brass polished special alloy knob.

PROVIDED WITH:
Fixing screw, allen wrench.

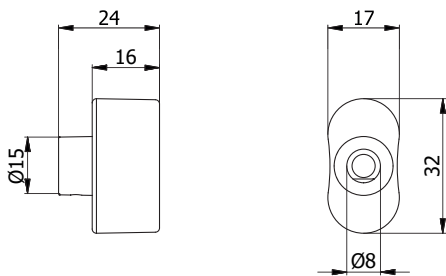

For cylinders series 326.

COD.	kg		
02123	0,06	10	-

NICKEL-PLATED KNOB



CONSTRUCTIVE FEATURES:
Satin nickel-plated special alloy knob.

PROVIDED WITH:
Fixing screw, allen wrench.

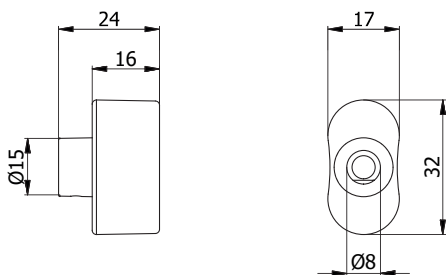

For cylinders series 326.

COD.	kg		
02123 H	0,06	10	-

ASSEMBLING INSTRUCTIONS CYLINDER 320M

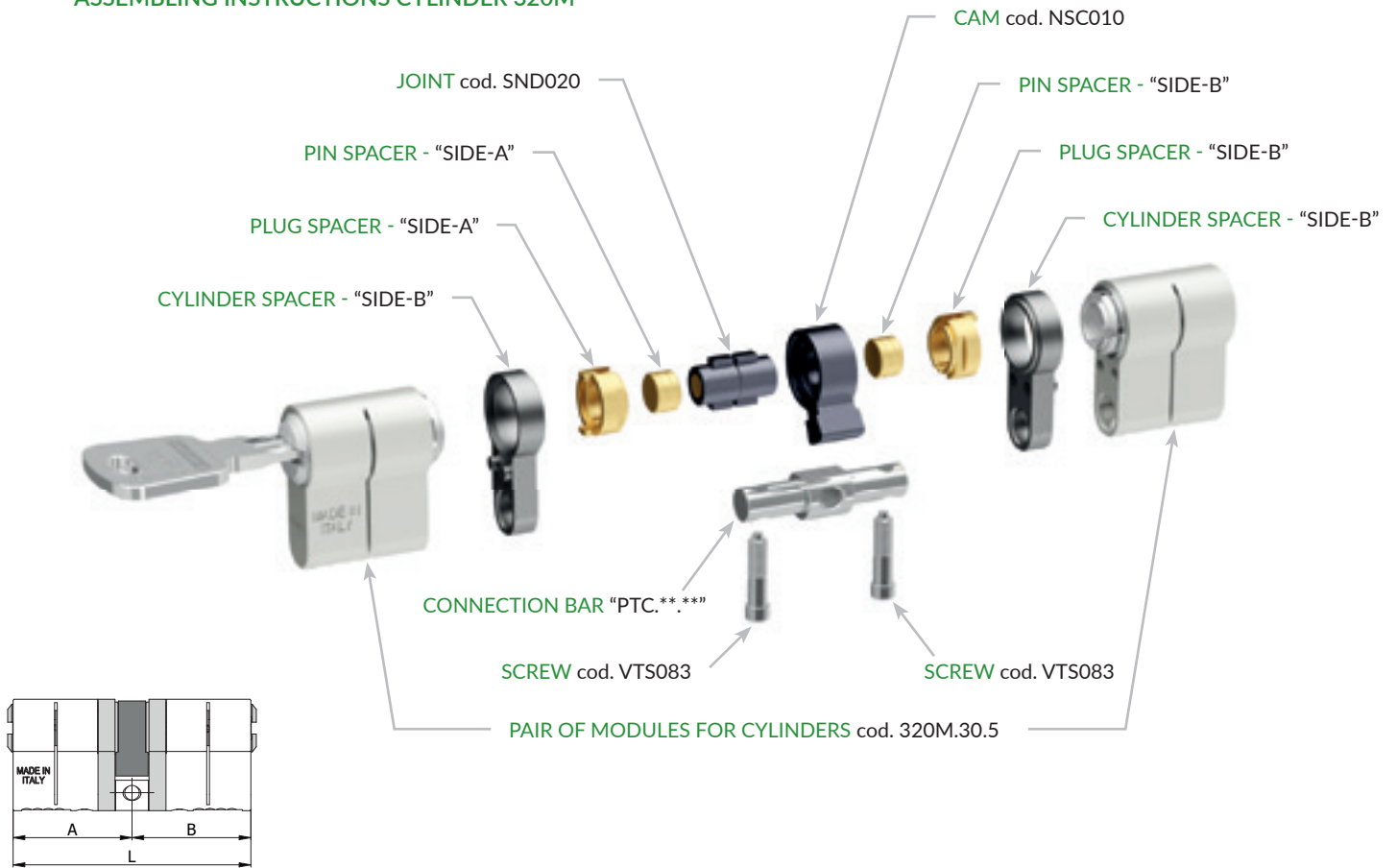

COD.	L	SIDE "A"				BAR		SIDE "B"			
		A	CYLINDER SPACER	+ PLUG SPACER	+ PIN SPACER	CONNECTION BAR	UNIVERSAL CONNECTION BAR	B	CYLINDER SPACER	+ PLUG SPACER	+ PIN SPACER
320M.30.30.5	60	30	/	/	/	PTC.30.30	PTC182	30	/	/	/
320M.30.35.5	65	30	/	/	/	PTC.30.35	PTC181	35	PTC003	NGM087	PRC098
320M.30.40.5	70	30	/	/	/	PTC.30.40	PTC182	40	PTC004	NGM088	PRC099
320M.35.35.5	70	35	PTC003	NGM087	PRC098	PTC.35.35	PTC180	35	PTC003	NGM087	PRC098
320M.30.45.5	75	30	/	/	/	PTC.30.45	PTC181	45	PTC005	NGM089	PRC100
320M.35.40.5	75	35	PTC003	NGM087	PRC098	PTC.35.40	PTC181	40	PTC004	NGM088	PRC099
320M.30.50.5	80	30	/	/	/	PTC.30.50	PTC182	50	PTC006	NGM090	PRC101
320M.35.45.5	80	35	PTC003	NGM087	PRC098	PTC.35.45	PTC180	45	PTC005	NGM089	PRC100
320M.40.40.5	80	40	PTC004	NGM088	PRC099	PTC.40.40	PTC182	40	PTC004	NGM088	PRC099
320M.30.55.5	85	30	/	/	/	PTC.30.55	PTC181	55	PTC006 PTC003	NGM090 NGM087	PRC101 PRC098
320M.35.50.5	85	35	PTC003	NGM087	PRC098	PTC.35.50	PTC181	50	PTC006	NGM090	PRC101

COD.	L	SIDE "A"				BAR		SIDE "B"			
		A	CYLINDER SPACER	+ PLUG SPACER +	PIN SPACER	CONNECTION BAR	UNIVERSAL CONNECTION BAR	B	CYLINDER SPACER	+ PLUG SPACER +	PIN SPACER
320M.40.45.5	85	40	PTC004	NGM088	PRC099	PTC.40.45	PTC181	45	PTC005	NGM089	PRC100
320M.30.60.5	90	30	/	/	/	PTC.30.60	PTC182	60	PTC006 PTC004	NGM090 NGM088	PRC101 PRC099
320M.35.55.5	90	35	PTC003	NGM087	PRC098	PTC.35.55	PTC180	55	PTC006 PTC003	NGM090 NGM087	PRC101 PRC098
320M.40.50.5	90	40	PTC004	NGM088	PRC099	PTC.40.50	PTC182	50	PTC006	NGM090	PRC101
320M.45.45.5	90	45	PTC005	NGM089	PRC100	PTC.45.45	PTC180	45	PTC005	NGM089	PRC100
320M.30.65.5	95	30	/	/	/	PTC.30.65	PTC181	65	PTC006 PTC005	NGM090 NGM089	PRC101 PRC100
320M.35.60.5	95	35	PTC003	NGM087	PRC098	PTC.35.60	PTC181	60	PTC006 PTC004	NGM090 NGM088	PRC101 PRC099
320M.40.55.5	95	40	PTC004	NGM088	PRC099	PTC.40.55	PTC181	55	PTC006 PTC003	NGM090 NGM087	PRC101 PRC098
320M.45.50.5	95	45	PTC005	NGM089	PRC100	PTC.45.50	PTC181	50	PTC006	NGM090	PRC101
320M.30.70.5	100	30	/	/	/	PTC.30.70	PTC182	70	N°2 PTC006	N°2 NGM090	N°2 PRC101
320M.35.65.5	100	35	PTC003	NGM087	PRC098	PTC.35.65	PTC180	65	PTC006 PTC005	NGM090 NGM089	PRC101 PRC100
320M.40.60.5	100	40	PTC004	NGM088	PRC099	PTC.40.60	PTC182	60	PTC006 PTC004	NGM090 NGM088	PRC101 PRC099
320M.45.55.5	100	45	PTC005	NGM089	PRC100	PTC.45.55	PTC180	55	PTC006 PTC003	NGM090 NGM087	PRC101 PRC098
320M.50.50.5	100	50	PTC006	NGM090	PRC101	PTC.50.50	PTC182	50	PTC006	NGM090	PRC101
320M.30.75.5	105	30	/	/	/	PTC.30.75	PTC181	75	N°2 PTC006 PTC003	N°2 NGM090 NGM087	N°2 PRC101 PRC098
320M.45.60.5	105	45	PTC005	NGM089	PRC100	PTC.45.60	PTC181	60	PTC006 PTC004	NGM090 NGM088	PRC101 PRC099
320M.30.80.5	110	30	/	/	/	PTC.30.80	PTC182	80	N°2 PTC006 PTC004	N°2 NGM090 NGM088	N°2 PRC101 PRC099
320M.40.70.5	110	40	PTC004	NGM088	PRC099	PTC.40.70	PTC182	70	N°2 PTC006	N°2 NGM090	N°2 PRC101
320M.50.60.5	110	50	PTC006	NGM090	PRC101	PTC.50.60	PTC182	60	PTC006 PTC004	NGM090 NGM088	PRC101 PRC099
320M.55.55.5	110	55	PTC006 PTC003	NGM090 NGM087	PRC101 PRC098	PTC.55.55	PTC180	55	PTC006 PTC003	NGM090 NGM087	PRC101 PRC098
320M.50.65.5	115	50	PTC006	NGM090	PRC101	PTC.50.65	PTC181	65	PTC006 PTC005	NGM090 NGM089	PRC101 PRC100
320M.30.90.5	120	30	/	/	/	PTC.30.90	PTC182	90	N°3 PTC006	N°3 NGM090	N°3 PRC101
320M.40.80.5	120	40	PTC004	NGM088	PRC099	PTC.40.80	PTC182	80	N°2 PTC006 PTC004	N°2 NGM090 NGM088	N°2 PRC101 PRC099
320M.50.70.5	120	50	PTC006	NGM090	PRC101	PTC.50.70	PTC182	70	N°2 PTC006	N°2 NGM090	N°2 PRC101
320M.60.60.5	120	60	PTC006 PTC004	NGM090 NGM088	PRC101 PRC099	PTC.60.60	PTC182	60	PTC006 PTC004	NGM090 NGM088	PRC101 PRC099

ASSEMBLING INSTRUCTIONS CYLINDER 321M

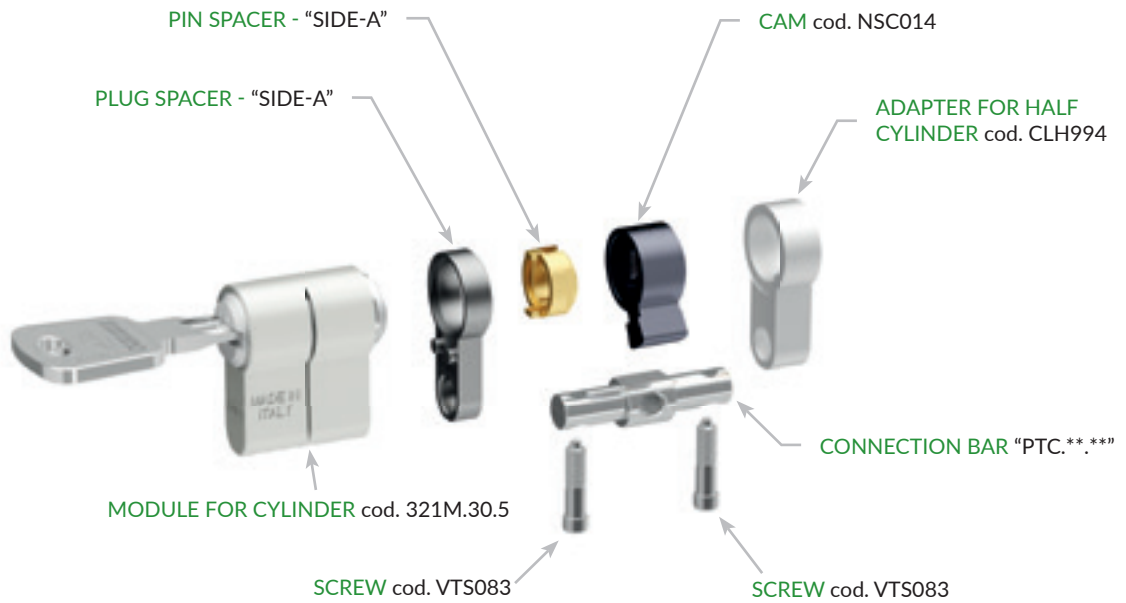

COD.	L	SIDE "A"				BAR	
		A	CYLINDER SPACER	+	PLUG SPACER	CONNECTION BAR	UNIVERSAL CONNECTION BAR
321M.30.13.5	43	30	/		/	PTC.30.30	PTC182
321M.35.13.5	48	35	PTC003		NGM087	PTC.30.35	PTC181
321M.40.13.5	53	40	PTC004		NGM088	PTC.30.40	PTC182
321M.45.13.5	58	45	PTC005		NGM089	PTC.30.45	PTC181
321M.50.13.5	63	50	PTC006		NGM090	PTC.30.50	PTC182
321M.55.13.5	68	55	PTC006 PTC003		NGM090 NGM087	PTC.30.55	PTC181
321M.60.13.5	73	60	PTC006 PTC004		NGM090 NGM088	PTC.30.60	PTC182
321M.65.13.5	78	65	PTC006 PTC005		NGM090 NGM089	PTC.30.65	PTC181
321M.70.13.5	83	70	N°2 PTC006		N°2 NGM090	PTC.30.70	PTC182
321M.80.13.5	93	80	N°2 PTC006 PTC004		N°2 NGM090 NGM088	PTC.30.80	PTC182



ASSEMBLING INSTRUCTIONS CYLINDER 322M

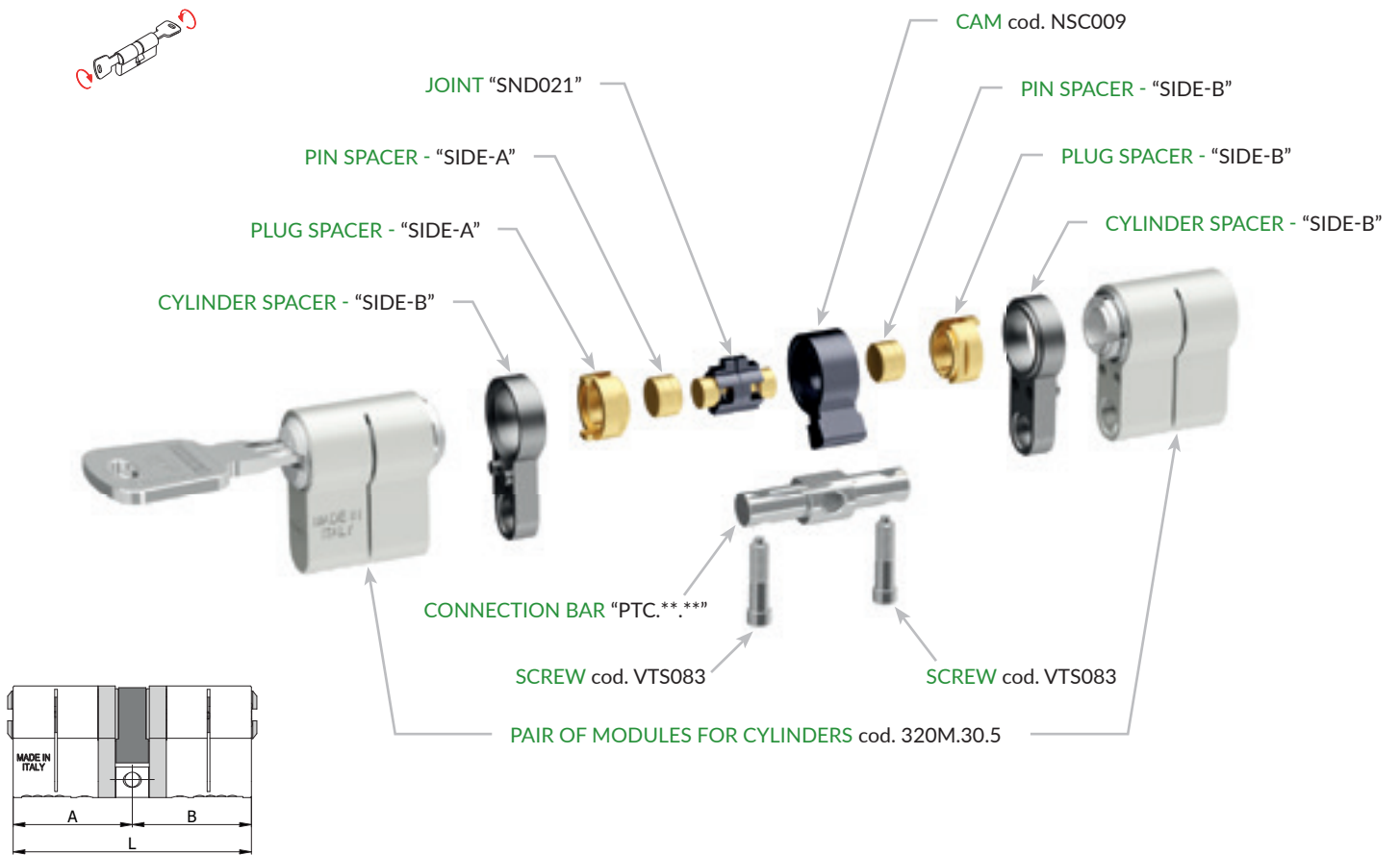

COD.	L	SIDE "A"				BAR		SIDE "B"			
		A	CYLINDER SPACER	+ PLUG SPACER	+ PIN SPACER	CONNECTION BAR	UNIVERSAL CONNECTION BAR	B	CYLINDER SPACER	+ PLUG SPACER	+ PIN SPACER
322M.30.30.5	60	30	/	/	/	PTC.30.30	PTC182	30	/	/	/
322M.30.35.5	65	30	/	/	/	PTC.30.35	PTC181	35	PTC003	NGM087	PRC098
322M.30.40.5	70	30	/	/	/	PTC.30.40	PTC182	40	PTC004	NGM088	PRC099
322M.35.35.5	70	35	PTC003	NGM087	PRC098	PTC.35.35	PTC180	35	PTC003	NGM087	PRC098
322M.30.45.5	75	30	/	/	/	PTC.30.45	PTC181	45	PTC005	NGM089	PRC100
322M.35.40.5	75	35	PTC003	NGM087	PRC098	PTC.35.40	PTC181	40	PTC004	NGM088	PRC099
322M.30.50.5	80	30	/	/	/	PTC.30.50	PTC182	50	PTC006	NGM090	PRC101
322M.35.45.5	80	35	PTC003	NGM087	PRC098	PTC.35.45	PTC180	45	PTC005	NGM089	PRC100
322M.40.40.5	80	40	PTC004	NGM088	PRC099	PTC.40.40	PTC182	40	PTC004	NGM088	PRC099
322M.30.55.5	85	30	/	/	/	PTC.30.55	PTC181	55	PTC006 PTC003	NGM090 NGM087	PRC101 PRC098
322M.35.50.5	85	35	PTC003	NGM087	PRC098	PTC.35.50	PTC181	50	PTC006	NGM090	PRC101

COD.	L	SIDE "A"				BAR		SIDE "B"			
		A	CYLINDER SPACER	+ PLUG SPACER +	PIN SPACER	CONNECTION BAR	UNIVERSAL CONNECTION BAR	B	CYLINDER SPACER	+ PLUG SPACER +	PIN SPACER
322M.40.45.5	85	40	PTC004	NGM088	PRC099	PTC.40.45	PTC181	45	PTC005	NGM089	PRC100
322M.30.60.5	90	30	/	/	/	PTC.30.60	PTC182	60	PTC006 PTC004	NGM090 NGM088	PRC101 PRC099
322M.35.55.5	90	35	PTC003	NGM087	PRC098	PTC.35.55	PTC180	55	PTC006 PTC003	NGM090 NGM087	PRC101 PRC098
322M.40.50.5	90	40	PTC004	NGM088	PRC099	PTC.40.50	PTC182	50	PTC006	NGM090	PRC101
322M.45.45.5	90	45	PTC005	NGM089	PRC100	PTC.45.45	PTC180	45	PTC005	NGM089	PRC100
322M.30.65.5	95	30	/	/	/	PTC.30.65	PTC181	65	PTC006 PTC005	NGM090 NGM089	PRC101 PRC100
322M.35.60.5	95	35	PTC003	NGM087	PRC098	PTC.35.60	PTC181	60	PTC006 PTC004	NGM090 NGM088	PRC101 PRC099
322M.40.55.5	95	40	PTC004	NGM088	PRC099	PTC.40.55	PTC181	55	PTC006 PTC003	NGM090 NGM087	PRC101 PRC098
322M.45.50.5	95	45	PTC005	NGM089	PRC100	PTC.45.50	PTC181	50	PTC006	NGM090	PRC101
322M.30.70.5	100	30	/	/	/	PTC.30.70	PTC182	70	N°2 PTC006	N°2 NGM090	N°2 PRC101
322M.35.65.5	100	35	PTC003	NGM087	PRC098	PTC.35.65	PTC180	65	PTC006 PTC005	NGM090 NGM089	PRC101 PRC100
322M.40.60.5	100	40	PTC004	NGM088	PRC099	PTC.40.60	PTC182	60	PTC006 PTC004	NGM090 NGM088	PRC101 PRC099
322M.45.55.5	100	45	PTC005	NGM089	PRC100	PTC.45.55	PTC180	55	PTC006 PTC003	NGM090 NGM087	PRC101 PRC098
322M.50.50.5	100	50	PTC006	NGM090	PRC101	PTC.50.50	PTC182	50	PTC006	NGM090	PRC101
322M.30.75.5	105	30	/	/	/	PTC.30.75	PTC181	75	N°2 PTC006 PTC003	N°2 NGM090 NGM087	N°2 PRC101 PRC098
322M.45.60.5	105	45	PTC005	NGM089	PRC100	PTC.45.60	PTC181	60	PTC006 PTC004	NGM090 NGM088	PRC101 PRC099
322M.30.80.5	110	30	/	/	/	PTC.30.80	PTC182	80	N°2 PTC006 PTC004	N°2 NGM090 NGM088	N°2 PRC101 PRC099
322M.40.70.5	110	40	PTC004	NGM088	PRC099	PTC.40.70	PTC182	70	N°2 PTC006	N°2 NGM090	N°2 PRC101
322M.50.60.5	110	50	PTC006	NGM090	PRC101	PTC.50.60	PTC182	60	PTC006 PTC004	NGM090 NGM088	PRC101 PRC099
322M.55.55.5	110	55	PTC006 PTC003	NGM090 NGM087	PRC101 PRC098	PTC.55.55	PTC180	55	PTC006 PTC003	NGM090 NGM087	PRC101 PRC098
322M.50.65.5	115	50	PTC006	NGM090	PRC101	PTC.50.65	PTC181	65	PTC006 PTC005	NGM090 NGM089	PRC101 PRC100
322M.30.90.5	120	30	/	/	/	PTC.30.90	PTC182	90	N°3 PTC006	N°3 NGM090	N°3 PRC101
322M.40.80.5	120	40	PTC004	NGM088	PRC099	PTC.40.80	PTC182	80	N°2 PTC006 PTC004	N°2 NGM090 NGM088	N°2 PRC101 PRC099
322M.50.70.5	120	50	PTC006	NGM090	PRC101	PTC.50.70	PTC182	70	N°2 PTC006	N°2 NGM090	N°2 PRC101
322M.60.60.5	120	60	PTC006 PTC004	NGM090 NGM088	PRC101 PRC099	PTC.60.60	PTC182	60	PTC006 PTC004	NGM090 NGM088	PRC101 PRC099

ASSEMBLING INSTRUCTIONS CYLINDER 323M

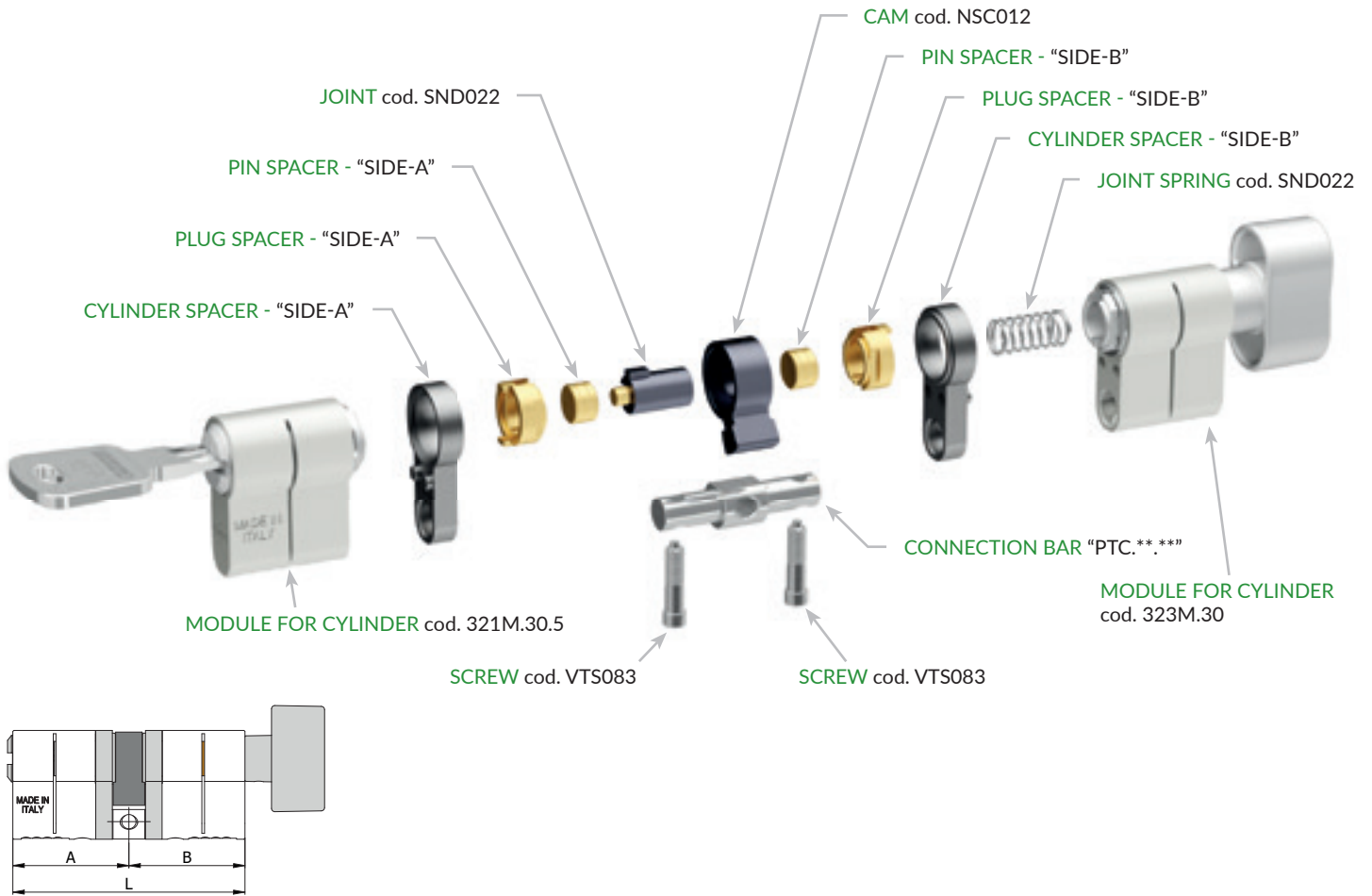

COD.	L	SIDE "A"			BAR		SIDE "B"				
		A	CYLINDER SPACER	+ PLUG SPACER + PIN SPACER	CONNECTION BAR	UNIVERSAL CONNECTION BAR	B	CYLINDER SPACER	+ PLUG SPACER + PIN SPACER		
323M.30.30B.5	60	30	/	/	/	PTC.30.30	PTC182	30	/	/	/
323M.30.35B.5	65	30	/	/	/	PTC.30.35	PTC181	35	PTC003	NGM087	PRC098
323M.35.30B.5	65	35	PTC003	NGM087	PRC098	PTC.30.35	PTC181	30	/	/	/
323M.30.40B.5	70	30	/	/	/	PTC.30.40	PTC182	40	PTC004	NGM088	PRC099
323M.35.35B.5	70	35	PTC003	NGM087	PRC098	PTC.35.35	PTC180	35	PTC003	NGM087	PRC098
323M.40.30B.5	70	40	PTC004	NGM088	PRC099	PTC.30.40	PTC182	30	/	/	/
323M.30.45B.5	75	30	/	/	/	PTC.30.45	PTC181	45	PTC005	NGM089	PRC100
323M.35.40B.5	75	35	PTC003	NGM087	PRC098	PTC.35.40	PTC181	40	PTC004	NGM088	PRC099
323M.40.35B.5	75	40	PTC004	NGM088	PRC099	PTC.35.40	PTC181	35	PTC003	NGM087	PRC098
323M.45.30B.5	75	45	PTC005	NGM089	PRC100	PTC.30.45	PTC181	30	/	/	/
323M.30.50B.5	80	30	/	/	/	PTC.30.50	PTC182	50	PTC006	NGM090	PRC101

COD.	L	SIDE "A"				BAR		SIDE "B"			
		A	CYLINDER SPACER	+ PLUG SPACER +	PIN SPACER	CONNECTION BAR	UNIVERSAL CONNECTION BAR	B	CYLINDER SPACER	+ PLUG SPACER +	PIN SPACER
323M.35.45B.5	80	35	PTC003	NGM087	PRC098	PTC.35.45	PTC180	45	PTC005	NGM089	PRC100
323M.40.40B.5	80	40	PTC004	NGM088	PRC099	PTC.40.40	PTC182	40	PTC004	NGM088	PRC099
323M.45.35B.5	80	45	PTC005	NGM089	PRC100	PTC.35.45	PTC180	35	PTC003	NGM087	PRC098
323M.50.30.B	80	50	PTC006	NGM090	PRC101	PTC.30.50	PTC182	30	/	/	/
323M.35.50B.5	85	35	PTC003	NGM087	PRC098	PTC.35.50	PTC181	50	PTC006	NGM090	PRC101
323M.40.45B.5	85	40	PTC004	NGM088	PRC099	PTC.40.45	PTC181	45	PTC005	NGM089	PRC100
323M.45.40B.5	85	45	PTC005	NGM089	PRC100	PTC.40.45	PTC181	40	PTC004	NGM088	PRC099
323M.50.35B.5	85	50	PTC006	NGM090	PRC101	PTC.35.50	PTC181	35	PTC003	NGM087	PRC098
323M.30.60B.5	90	30	/	/	/	PTC.30.60	PTC182	60	PTC006 PTC004	NGM090 NGM088	PRC101 PRC099
323M.40.50B.5	90	40	PTC004	NGM088	PRC099	PTC.40.50	PTC182	50	PTC006	NGM090	PRC101
323M.45.45B.5	90	45	PTC005	NGM089	PRC100	PTC.45.45	PTC180	45	PTC005	NGM089	PRC100
323M.50.40B.5	90	50	PTC006	NGM090	PRC101	PTC.40.50	PTC182	40	PTC004	NGM088	PRC099
323M.60.30B.5	90	60	PTC006 PTC004	NGM090 NGM088	PRC101 PRC099	PTC.30.60	PTC182	30	/	/	/
323M.60.35B.5	95	60	PTC006 PTC004	NGM090 NGM088	PRC101 PRC099	PTC.35.60	PTC181	35	PTC003	NGM087	PRC098
323M.30.70B.5	100	30	/	/	/	PTC.30.70	PTC182	70	N°2 PTC006	N°2 NGM090	N°2 PRC101
323M.40.60B.5	100	40	PTC004	NGM088	PRC099	PTC.40.60	PTC182	60	PTC006 PTC004	NGM090 NGM088	PRC101 PRC099
323M.50.50B.5	100	50	PTC006	NGM090	PRC101	PTC.50.50	PTC182	50	PTC006	NGM090	PRC101
323M.60.40B.5	100	60	PTC006 PTC004	NGM090 NGM088	PRC101 PRC099	PTC.40.60	PTC182	40	PTC004	NGM088	PRC099
323M.70.30B.5	100	70	N°2 PTC006	N°2 NGM090	N°2 PRC101	PTC.30.70	PTC182	30	/	/	/
323M.30.80B.5	110	30	/	/	/	PTC.30.80	PTC182	80	N°2 PTC006 PTC004	N°2 NGM090 NGM088	N°2 PRC101 PRC099
323M.40.70B.5	110	40	PTC004	NGM088	PRC099	PTC.40.70	PTC182	70	N°2 PTC006	N°2 NGM090	N°2 PRC101
323M.50.60B.5	110	50	PTC006	NGM090	PRC101	PTC.50.60	PTC182	60	PTC006 PTC004	NGM090 NGM088	PRC101 PRC099
323M.60.50B.5	110	60	PTC006 PTC004	NGM090 NGM088	PRC101 PRC099	PTC.50.60	PTC182	50	PTC006	NGM090	PRC101
323M.40.80B.5	120	40	PTC004	NGM088	PRC099	PTC.40.80	PTC182	80	N°2 PTC006 PTC004	N°2 NGM090 NGM088	N°2 PRC101 PRC099
323M.60.60B.5	120	60	PTC006 PTC004	NGM090 NGM088	PRC101 PRC099	PTC.60.60	PTC182	60	PTC006 PTC004	NGM090 NGM088	PRC101 PRC099

ASSEMBLING INSTRUCTIONS CYLINDER 324M

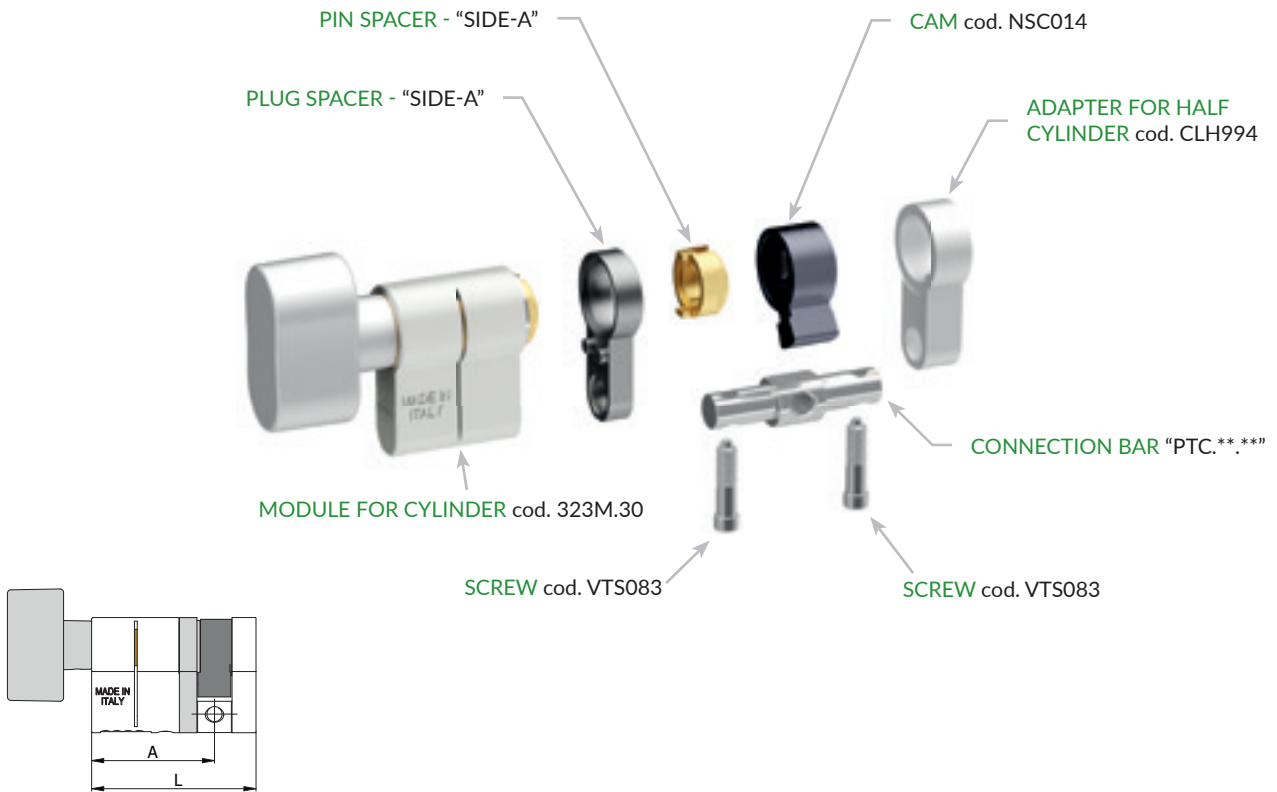

COD.	L	SIDE "A"				BAR	
		A	CYLINDER SPACER	+	PLUG SPACER	CONNECTION BAR	UNIVERSAL CONNECTION BAR
324M.30.13.5	43	30	/		/	PTC.30.30	PTC182
324M.35.13.5	48	35	PTC003		NGM087	PTC.30.35	PTC181
324M.40.13.5	53	40	PTC004		NGM088	PTC.30.40	PTC182
324M.45.13.5	58	45	PTC005		NGM089	PTC.30.45	PTC181
324M.50.13.5	63	50	PTC006		NGM090	PTC.30.50	PTC182
324M.55.13.5	68	55	PTC006 PTC003		NGM090 NGM087	PTC.30.55	PTC181
324M.60.13.5	73	60	PTC006 PTC004		NGM090 NGM088	PTC.30.60	PTC182
324M.65.13.5	78	65	PTC006 PTC005		NGM090 NGM089	PTC.30.65	PTC181
324M.70.13.5	83	70	N°2 PTC006		N°2 NGM090	PTC.30.70	PTC182
324M.80.13.5	93	80	N°2 PTC006 PTC004		N°2 NGM090 NGM088	PTC.30.80	PTC182



ASSEMBLING INSTRUCTIONS CYLINDER 326M

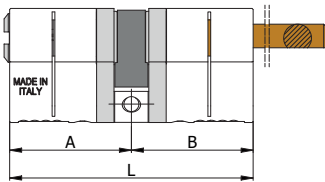
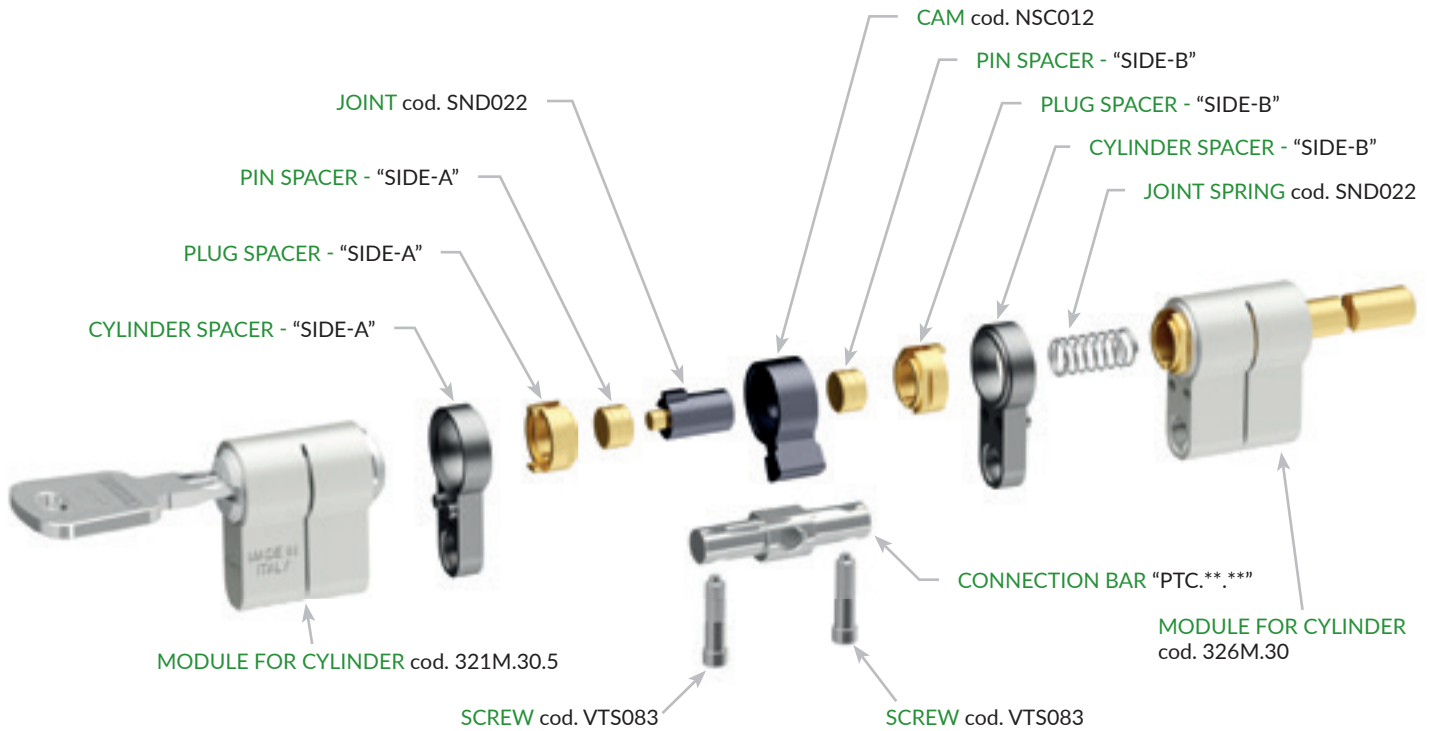

COD.	L	SIDE "A"			BAR		SIDE "B"				
		A	CYLINDER SPACER	+ PLUG SPACER + PIN SPACER	CONNECTION BAR	UNIVERSAL CONNECTION BAR	B	CYLINDER SPACER	+ PLUG SPACER + PIN SPACER		
326M.30.30G.5	60	30	/	/	/	PTC.30.30	PTC182	30	/	/	/
326M.30.35G.5	65	30	/	/	/	PTC.30.35	PTC181	35	PTC003	NGM087	PRC098
326M.35.30G.5	65	35	PTC003	NGM087	PRC098	PTC.30.35	PTC181	30	/	/	/
326M.30.40G.5	70	30	/	/	/	PTC.30.40	PTC182	40	PTC004	NGM088	PRC099
326M.35.35G.5	70	35	PTC003	NGM087	PRC098	PTC.35.35	PTC180	35	PTC003	NGM087	PRC098
326M.40.30G.5	70	40	PTC004	NGM088	PRC099	PTC.30.40	PTC182	30	/	/	/
326M.30.45G.5	75	30	/	/	/	PTC.30.45	PTC181	45	PTC005	NGM089	PRC100
326M.35.40G.5	75	35	PTC003	NGM087	PRC098	PTC.35.40	PTC181	40	PTC004	NGM088	PRC099
326M.40.35G.5	75	40	PTC004	NGM088	PRC099	PTC.35.40	PTC181	35	PTC003	NGM087	PRC098
326M.45.30G.5	75	45	PTC005	NGM089	PRC100	PTC.30.45	PTC181	30	/	/	/
326M.30.50G.5	80	30	/	/	/	PTC.30.50	PTC182	50	PTC006	NGM090	PRC101

COD.	L	SIDE "A"				BAR		SIDE "B"			
		A	CYLINDER SPACER	+ PLUG SPACER +	PIN SPACER	CONNECTION BAR	UNIVERSAL CONNECTION BAR	B	CYLINDER SPACER	+ PLUG SPACER +	PIN SPACER
326M.35.45G.5	80	35	PTC003	NGM087	PRC098	PTC.35.45	PTC180	45	PTC005	NGM089	PRC100
326M.40.40G.5	80	40	PTC004	NGM088	PRC099	PTC.40.40	PTC182	40	PTC004	NGM088	PRC099
326M.45.35G.5	80	45	PTC005	NGM089	PRC100	PTC.35.45	PTC180	35	PTC003	NGM087	PRC098
326M.50.30.G	80	50	PTC006	NGM090	PRC101	PTC.30.50	PTC182	30	/	/	/
326M.35.50G.5	85	35	PTC003	NGM087	PRC098	PTC.35.50	PTC181	50	PTC006	NGM090	PRC101
326M.40.45G.5	85	40	PTC004	NGM088	PRC099	PTC.40.45	PTC181	45	PTC005	NGM089	PRC100
326M.45.40G.5	85	45	PTC005	NGM089	PRC100	PTC.40.45	PTC181	40	PTC004	NGM088	PRC099
326M.50.35G.5	85	50	PTC006	NGM090	PRC101	PTC.35.50	PTC181	35	PTC003	NGM087	PRC098
326M.30.60G.5	90	30	/	/	/	PTC.30.60	PTC182	60	PTC006 PTC004	NGM090 NGM088	PRC101 PRC099
326M.40.50G.5	90	40	PTC004	NGM088	PRC099	PTC.40.50	PTC182	50	PTC006	NGM090	PRC101
326M.45.45G.5	90	45	PTC005	NGM089	PRC100	PTC.45.45	PTC180	45	PTC005	NGM089	PRC100
326M.50.40G.5	90	50	PTC006	NGM090	PRC101	PTC.40.50	PTC182	40	PTC004	NGM088	PRC099
326M.60.30G.5	90	60	PTC006 PTC004	NGM090 NGM088	PRC101 PRC099	PTC.30.60	PTC182	30	/	/	/
326M.60.35G.5	95	60	PTC006 PTC004	NGM090 NGM088	PRC101 PRC099	PTC.35.60	PTC181	35	PTC003	NGM087	PRC098
326M.30.70G.5	100	30	/	/	/	PTC.30.70	PTC182	70	N°2 PTC006	N°2 NGM090	N°2 PRC101
326M.40.60G.5	100	40	PTC004	NGM088	PRC099	PTC.40.60	PTC182	60	PTC006 PTC004	NGM090 NGM088	PRC101 PRC099
326M.50.50G.5	100	50	PTC006	NGM090	PRC101	PTC.50.50	PTC182	50	PTC006	NGM090	PRC101
326M.60.40G.5	100	60	PTC006 PTC004	NGM090 NGM088	PRC101 PRC099	PTC.40.60	PTC182	40	PTC004	NGM088	PRC099
326M.70.30G.5	100	70	N°2 PTC006	N°2 NGM090	N°2 PRC101	PTC.30.70	PTC182	30	/	/	/
326M.30.80G.5	110	30	/	/	/	PTC.30.80	PTC182	80	N°2 PTC006 PTC004	N°2 NGM090 NGM088	N°2 PRC101 PRC099
326M.40.70G.5	110	40	PTC004	NGM088	PRC099	PTC.40.70	PTC182	70	N°2 PTC006	N°2 NGM090	N°2 PRC101
326M.50.60G.5	110	50	PTC006	NGM090	PRC101	PTC.50.60	PTC182	60	PTC006 PTC004	NGM090 NGM088	PRC101 PRC099
326M.60.50G.5	110	60	PTC006 PTC004	NGM090 NGM088	PRC101 PRC099	PTC.50.60	PTC182	50	PTC006	NGM090	PRC101
326M.40.80G.5	120	40	PTC004	NGM088	PRC099	PTC.40.80	PTC182	80	N°2 PTC006 PTC004	N°2 NGM090 NGM088	N°2 PRC101 PRC099
326M.60.60G.5	120	60	PTC006 PTC004	NGM090 NGM088	PRC101 PRC099	PTC.60.60	PTC182	60	PTC006 PTC004	NGM090 NGM088	PRC101 PRC099